

Body Side Molding Kit Installation (Instruction P/N 22838089)

Table 1: [Body Side Molding Kit Contents](#)

Table 2: [Front Bumper Fascia Kit Contents](#)

Table 3: [Rear Bumper Fascia Kit Contents](#)

Table 4: [Rocker Panel \(Left\) Kit Contents](#)

Table 5: [Rocker Panel \(Right\) Kit Contents](#)

Installation Instructions Part Number

22838089

Body Side Molding Kit Contents

Qty	Description	Part Number
1	Front Bumper Fascia Molding	22838069
1	Rear Bumper Fascia Molding	22769920
1	Rocker Panel Molding	23205639
1	Rocker Panel Molding	23205640

Front Bumper Fascia Kit Contents

Qty	Description	Part Number
1	Front Bumper Fascia Lower Extension	22838070
1	Front Bumper Fascia Lower Extension Bracket	22838083
1	Front Bumper Fascia Lower Extension Bracket	22838082
1	Front Bumper Fascia Lower Extension Bracket	22838085
1	Front Bumper Fascia Lower Extension Bracket	22838084

© 2017 General Motors. All rights reserved.

Qty	Description	Part Number
6	Front Bumper Fascia Bolts	11589013
1	Front Bumper Fascia	22875559
1	Front Bumper Fascia Lower Attachment	22875557
28	Pop Rivets 5/32"	115456343
1	Front Bumper Fascia Lower Bracket	22875556

Rear Bumper Fascia Kit Contents

Qty	Description	Part Number
1	Rear Bumper Fascia Lower Extension	22769921
1	Chrome Insert	22838087
1	Chrome Insert	22838088
1	Rear Bumper Fascia Lower Extension Bracket	22870883
1	Rear Bumper Fascia Lower Extension Bracket	22870884
3	Rear Bumper Fascia Lower Bracket (U-Nut)	11515842
1	Rear Bumper Fascia Lower Assembly	22875555

Rocker Panel (Left) Kit Contents

Qty	Description	Part Number
1	Rocker Panel	23205641
1	Rocker Protection Film	22781523
1	Rocker Panel Assembly	23205643

Qty	Description	Part Number
1	Rocker Panel Molding	22948109
1	Rear Rocker Panel Bracket	23205650
1	Front Rocker Panel Bracket	23205651
3	Clip	11570602
1	Nut	11516397
8	Staple	11570968
5	Retainer	11611435
1	Retainer	11546635
9	Retainer	11571175
1	Retainer	11612122

Rocker Panel (Right) Kit Contents

Qty	Description	Part Number
1	Rocker Panel	23205642
1	Rocker Protection Film	22781524
1	Rocker Panel Assembly	23205644
1	Rocker Panel Molding	22948100
1	Rear Rocker Panel Bracket	23205649
1	Front Rocker Panel Bracket	23205645

Qty	Description	Part Number
3	Clip	11570602
1	Nut	11516397
8	Staple	11570968
5	Retainer	11611435
1	Retainer	11546635
9	Retainer	11571175
1	Retainer	11612122

Tools Required

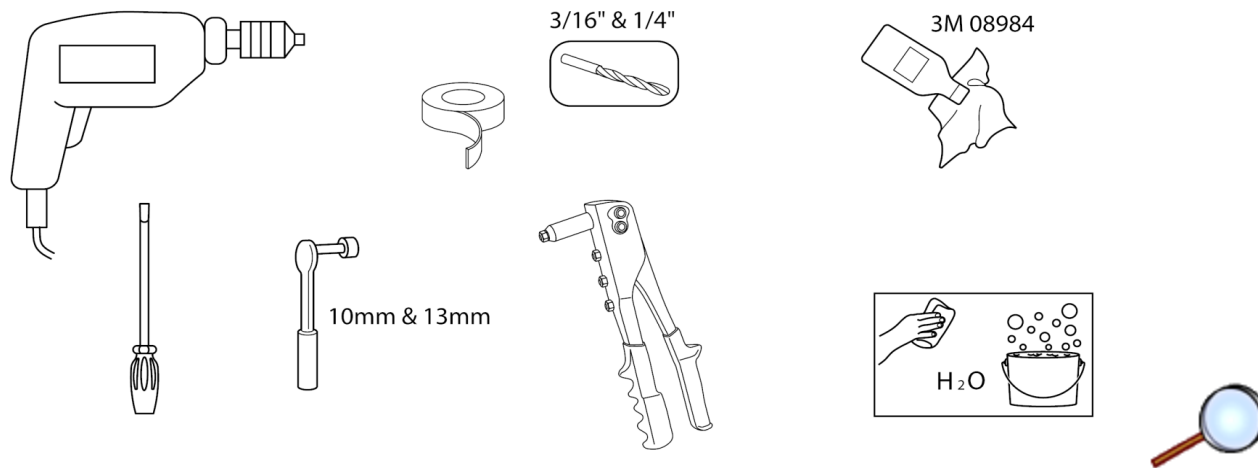

Note:

- Carefully read and understand instructions and components completely before beginning installation.
- Installation is made easier with the removal of all 4 wheels.
- There are sections of this install that may require assistance. For best results, vehicle should be free of damage (dents, scuffs, creases, fractures, scratches, etc).

Procedure

Front Fascia Extension

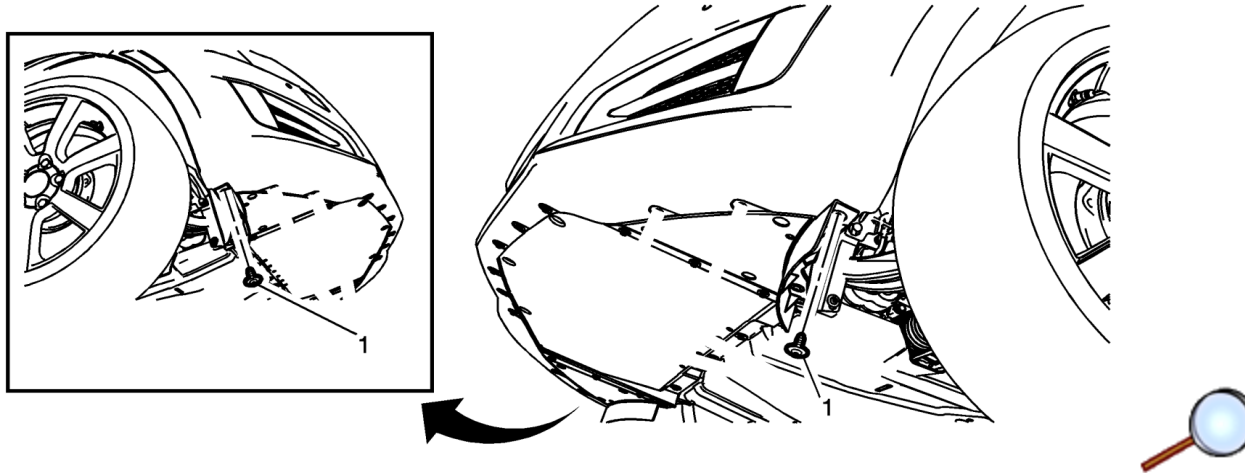

1. Raise and support the vehicle. **Refer to Vehicle Service Manual.**
2. Remove the front and rear wheel and tire assemblies. **Refer to Vehicle Service Manual.**
3. Remove and discard the three screws (1) on each side of the front fascia.
4. Clean the underside of the front fascia.

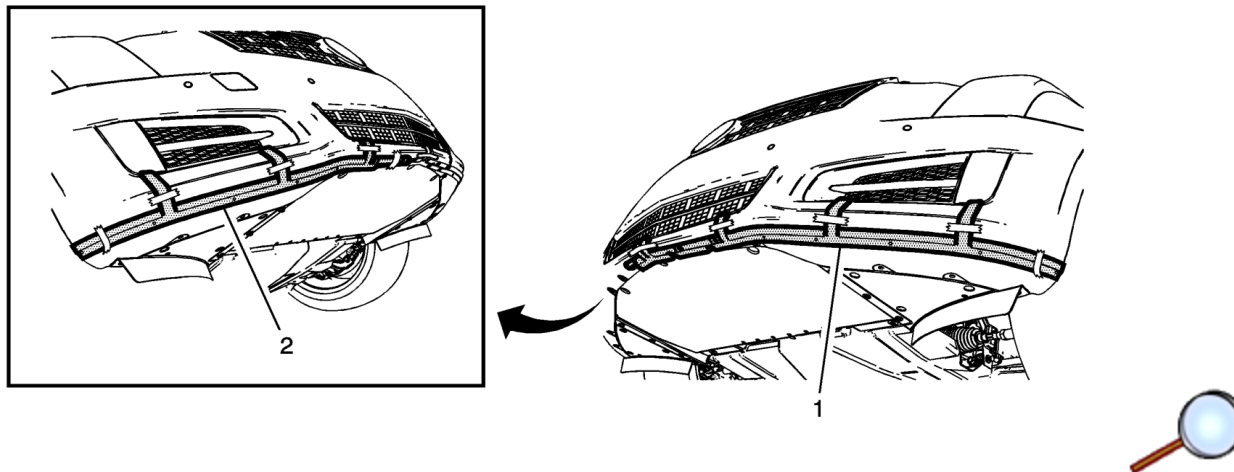

Note: Ensure the spacing from the end of the clamp bracket to the edge of the wheel well opening is even on both sides.

5. Starting from the center of the front fascia, locate the LH clamp bracket (1) using the fascia contour for alignment and tape into position.

6. Install the RH clamp bracket (2) starting from the right edge of the LH clamp bracket and tape into position.

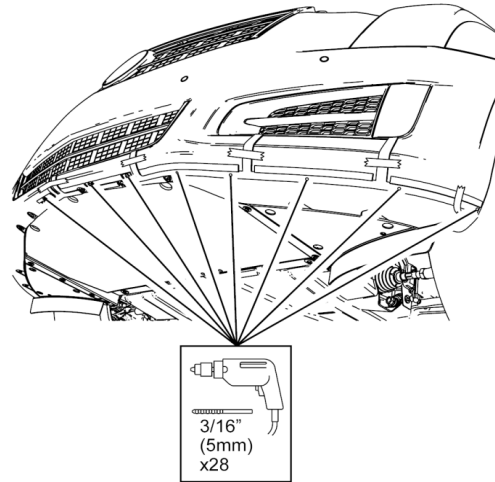
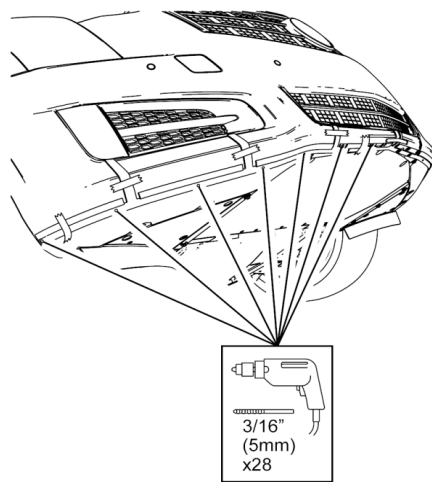

Note:

- Measure side to side differences to ensure that the bracket is centered to vehicle.
- The clamp bracket is used as a template.

7. Drill through the 28 clamp bracket holes using a 3/16" (5mm) drill bit.

Note: The drill depth needs to be 1.25" (31.75mm). Use a drill stopper or equivalent.

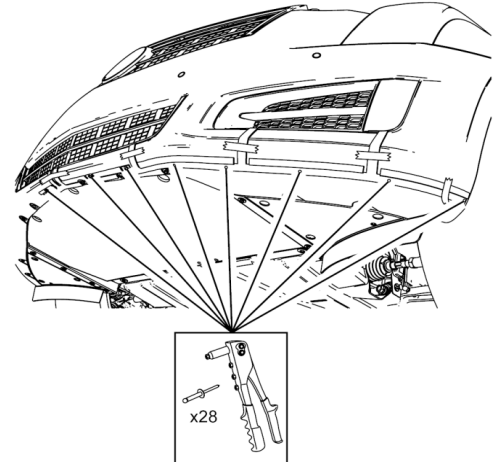
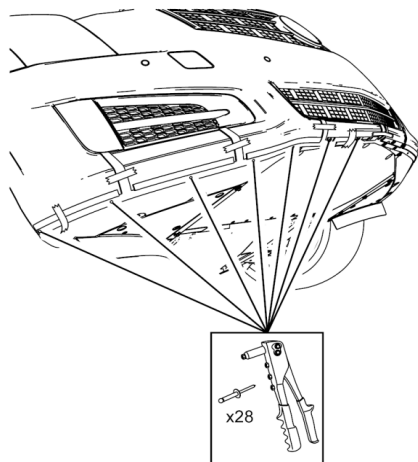

8. Attach the clamp brackets to the fascia using the 28 provided rivets.

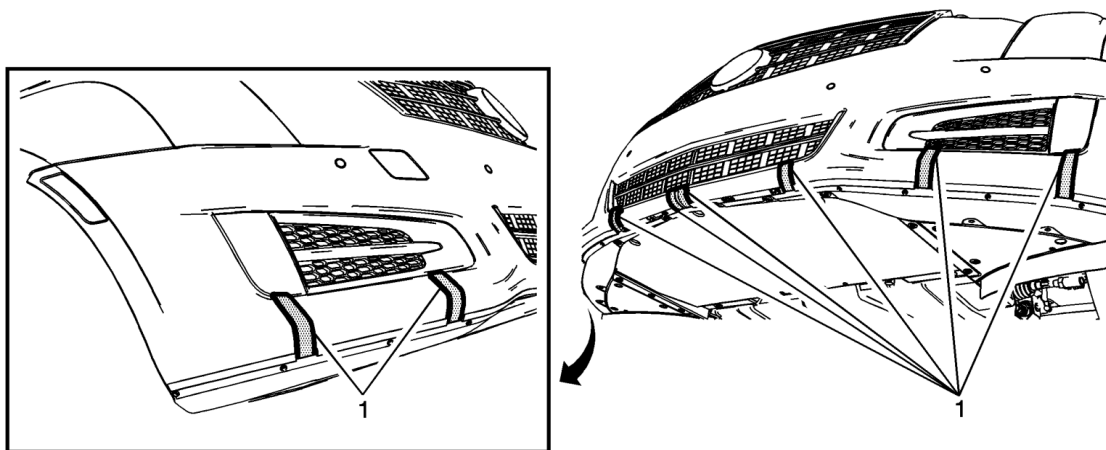

9. Remove the tape and the eight locating fingers (1) from the clamp brackets.

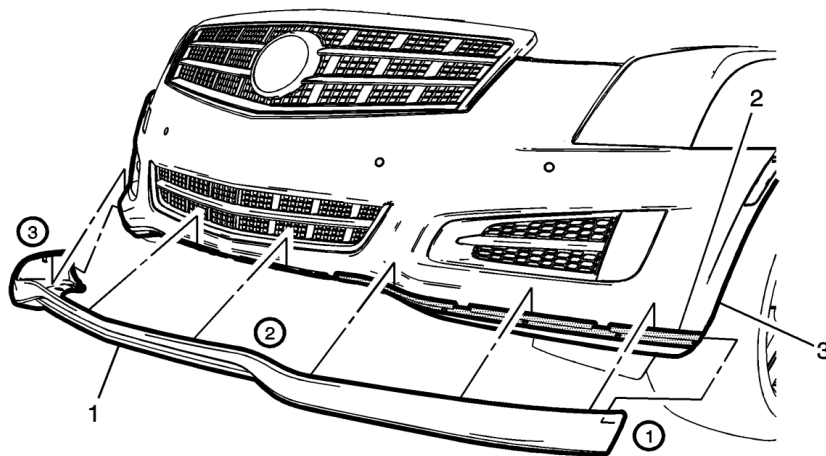

10. Install the front fascia extension (1) by pushing against the fascia (3) and lifting the extension flange over the clamp bracket (2). Start at one wheel well opening and progressively work toward to the other wheel well opening. The center section of the fascia extension at the nose of the fascia may not appear to engage properly until both ends of the fascia extension are engaged at the wheel well openings.

11. Remove tape from ends of front fascia extension.

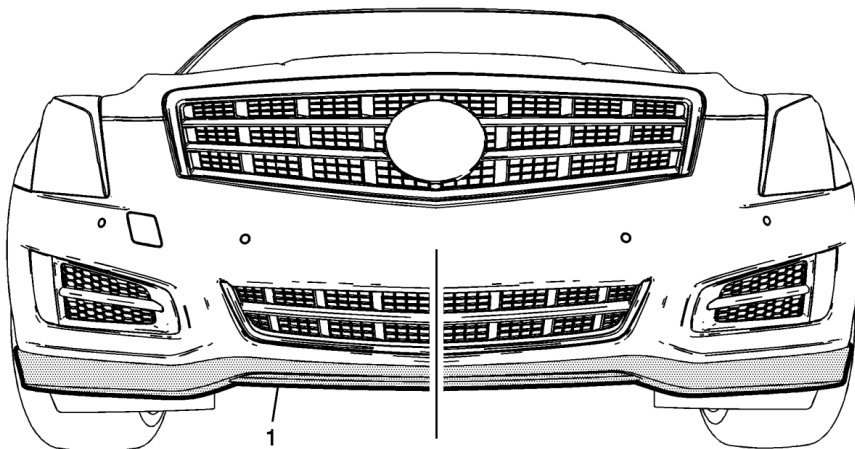

12. Ensure the fascia extension (1) is centered in the fascia.

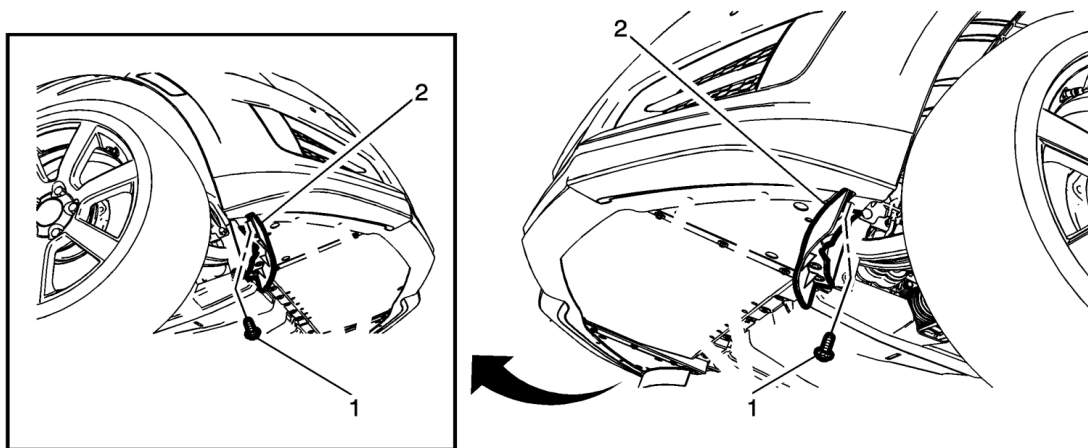

13. Ensure that the fascia extension encompasses the air deflectors (2).

14. Install the provided screws (1), 3 on each side.

Rear Lower Fascia

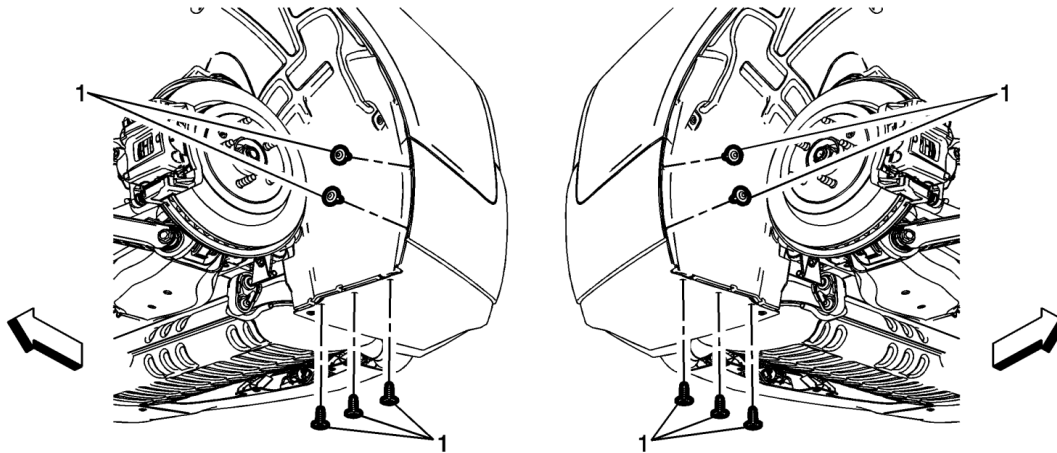

1. Remove and retain the screws (1) (Qty:10) securing the left and right rear wheelhouse liner to the rear fascia.

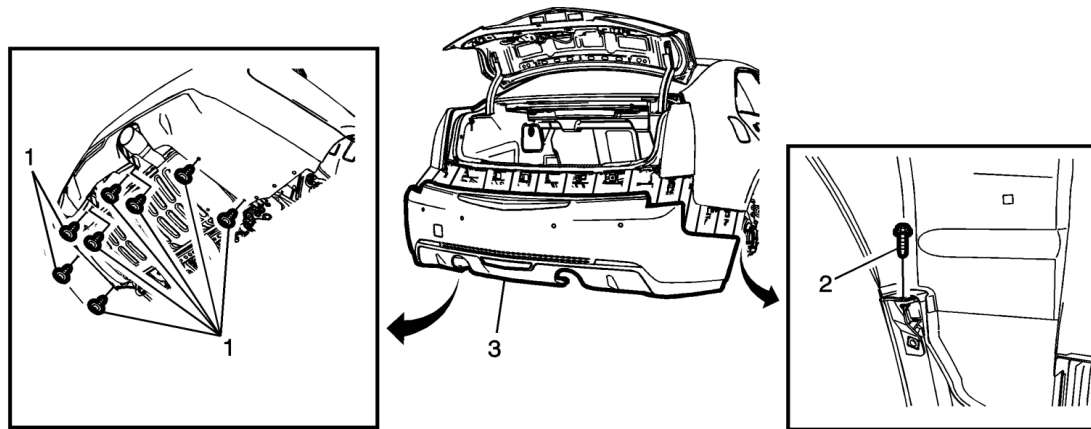

2. Remove and retain the rear bumper fascia bolts (1) (Qty: 8).

3. Remove and retain the left and right rear bumper fascia screws (2) (Qty: 2), securing rear fascia to quarter panel.

4. Carefully push a small nylon wedge between the fascia and the rear fascia brackets. Insert a small flat-bladed tool into the fascia slot and repress the snaps one at a time and pull on the fascia at the same time to gradually remove the fascia from the rear fascia brackets.

5. Disconnect the electrical connector.

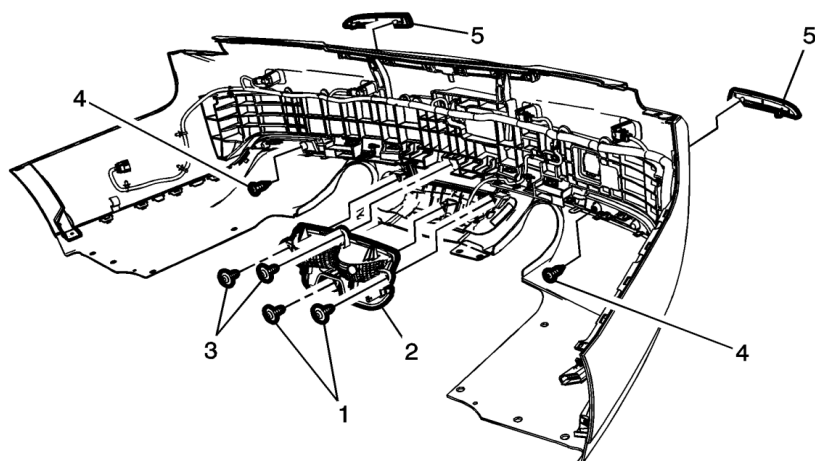

6. Place the fascia assembly on a protective surface to avoid scratching the upper or lower fascia.
7. Remove and retain the screws (1), (3) (Qty:4), securing the backup lamp to the rear fascia.
8. Disconnect electrical connector, remove and retain backup lamp (1) from the rear fascia.
9. Remove and retain the screws (4) (Qty:2), securing the reflectors to the rear fascia.
10. Press on the retainer tab, remove and retain reflectors (5) from the rear fascia.

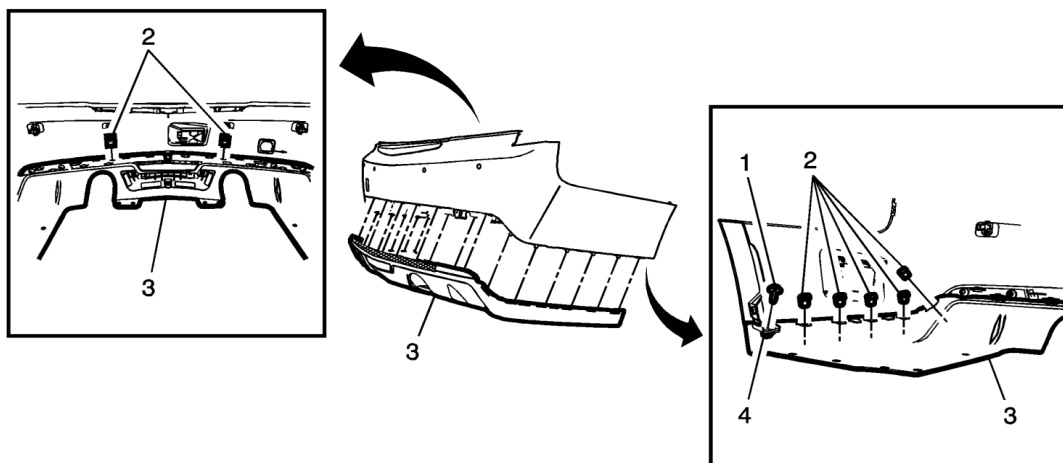

11. Remove and retain the left and right screws (1) (Qty:2), attaching the upper and lower fascia.
12. Remove and retain the snap clips (2) (Qty:10) connecting the upper and lower rear fascia.
13. Carefully push a small nylon wedge between the upper fascia and the lower fascia. Insert a small flat-bladed tool into the fascia slot and depress the snaps one at a time and pull on the fascia at the same time to gradually remove the lower fascia (3) from the upper fascia.

Note: Upper and lower fascias will need to be flexed in order to separate them.

14. Remove and retain the left and right threaded inserts (4) (Qty:2) from the rear lower fascia.
15. Remove and retain the wire harness from lower fascia.
16. Discard factory installed lower fascia.
17. Reassemble and install rear fascia to vehicle and connect any electrical connections.
18. Reinstall all fasteners

Rocker Panel Molding

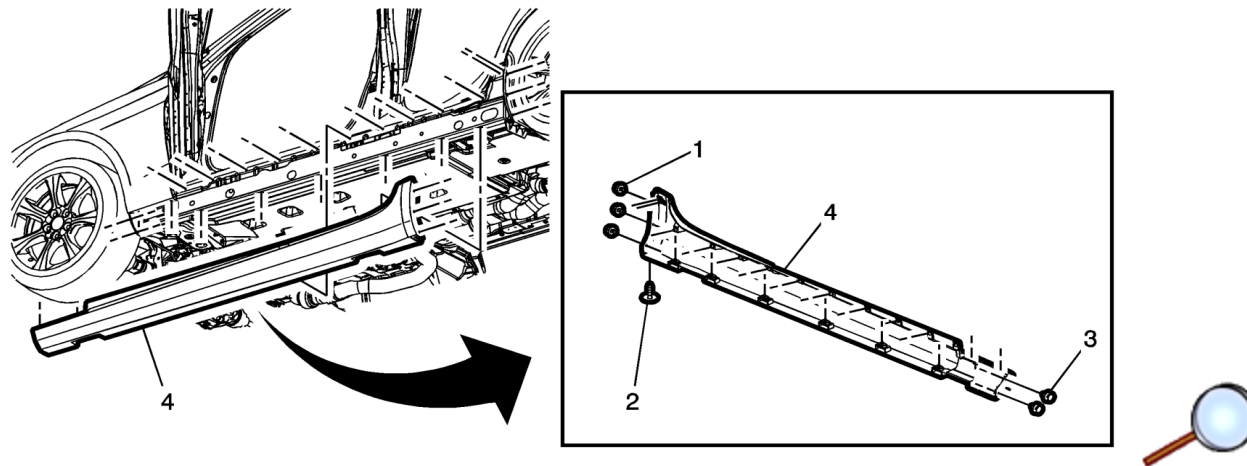

1. Open both front and rear side doors.
2. Remove and retain the left and right rear wheelhouse panel liner retainers (1) (Qty:3 each side).
3. Remove and retain the left and right front wheelhouse panel liner retainers (3) (Qty:2 each side).
4. Remove and retain the left and right rear air deflector screws (2) (Qty:1 each side).
5. Release the left and right rocker panel molding retainers from the front fender (Qty:2 each side).
From the bottom edge firmly pull down the left and right rocker panel molding retainers from the rocker outer panel (Qty:5 each side)
From the top edge firmly pull out on the left and right rocker panel molding (12 retainers each side) from the body side outer panel and remove rocker panel molding (4) from the vehicle.
6. Reassemble the replacement rocker panel moldings in reverse order.
7. Reinstall wheel house liner retainers and air deflector screws.
8. Install front and rear wheel and tire assemblies. **Refer to Vehicle Service Manual.**
9. Lower vehicle.