

# Installation Instructions Part Number

23349182

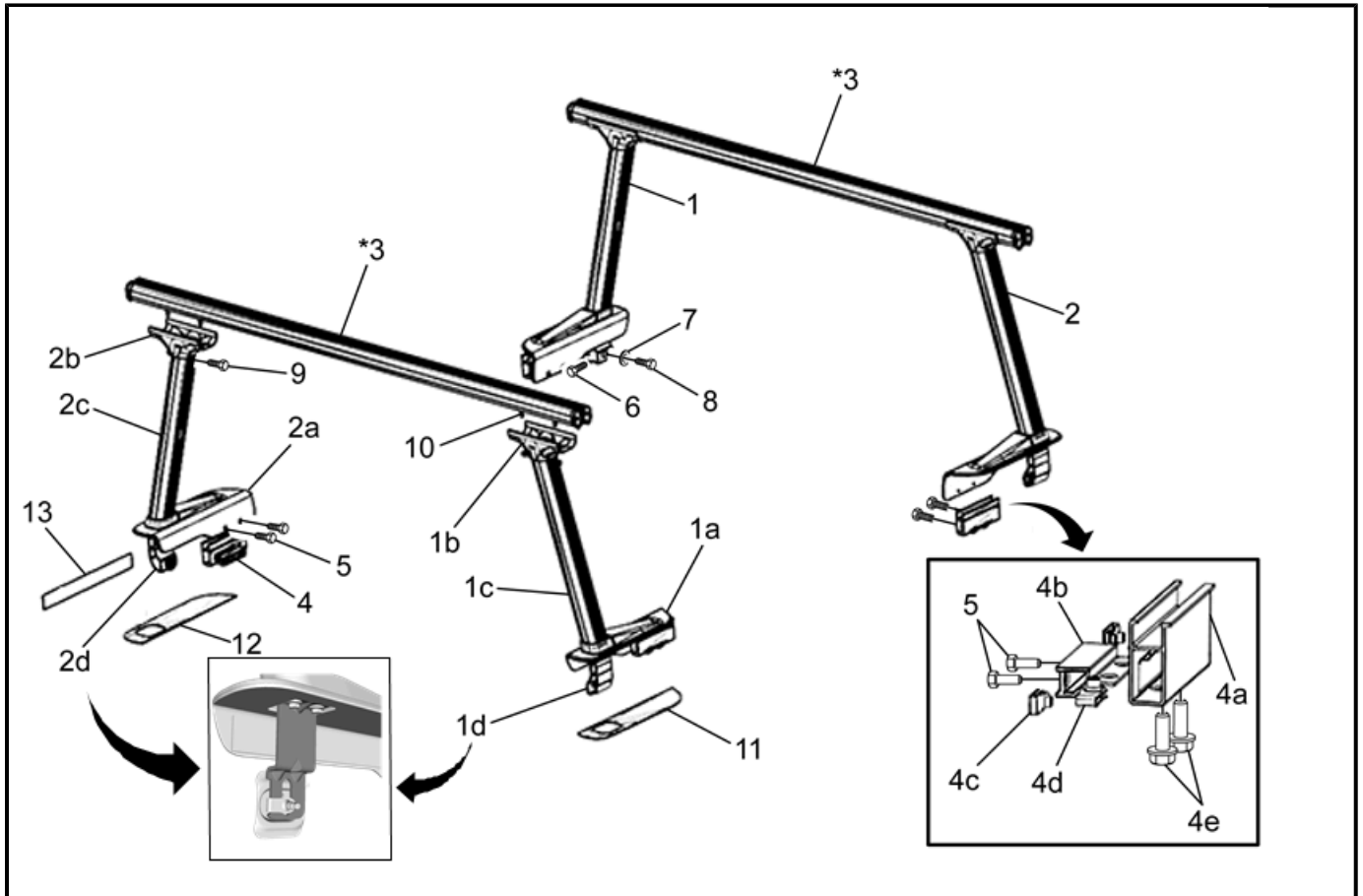

4566380

## Kit Contents

Item Number	Part Number	Description
1	84136803	Stanchion Assembly (Driver Frt/Passenger Frt)
1A	-	Lower Casting
1B	-	Upper Casting
1C	-	Stanchion
1D	-	Stake Pocket Bracket
2	84136804	Stanchion Assembly (Passenger FR)
2A	-	Lower Casting
2B	-	Upper Casting
2C	-	Stanchion
2D	-	Stake Pocket Bracket
3	23218583	*Tiered Storage Cross Rail (Sold separately)
AA	23349183	Support Assembly

Item Number	Part Number	Description
4	23245103	Clamp Assembly
4A	23254205	Vertical Clamp Bracket
4B	23245103	Horizontal Clamp Bracket
4C	11507067	M6 U-nut
4D	11516647	M8 U-nut
4E	11566789	M8 Hex Head W/Conical Washer
5	11548000	M6 Flat Head Bolt
6	11516647	M8 U-nut (Stake Pocket Bracket)
7	20432548	Washer
8	11569789	M8 Hex Head W/Conical Washer
9	11546377	M8 Flange Nut
10	11547613	M8 Square Head Bolt
11	23349186	Foam Pad (Driver FRT/Passenger R)
12	23349185	Foam Pad (Passenger FRT/Driver R)
13	23349187	Foam Pad (Common Side)
	23349184	Support Assembly
	23245102	Washer

### Tools Required

- Utility Knife
- Torque Wrench with 13 mm socket
- 4 mm Allen socket/driver, or key
- 2-inch diameter hole saw bit (for installation with bed liner)

**Note:** This system has been designed with a 300 lb (136 kg) load capacity. Do not exceed the load limits.

### Procedure

**Note:** For installation with a GM accessory bed liner, the Bed Liner must be removed from the pick-up box prior to install of the Utility Rack Assembly. When Utility Rack Assembly is complete, the Bed Liner can then be installed.

## Bed Rail Preparation

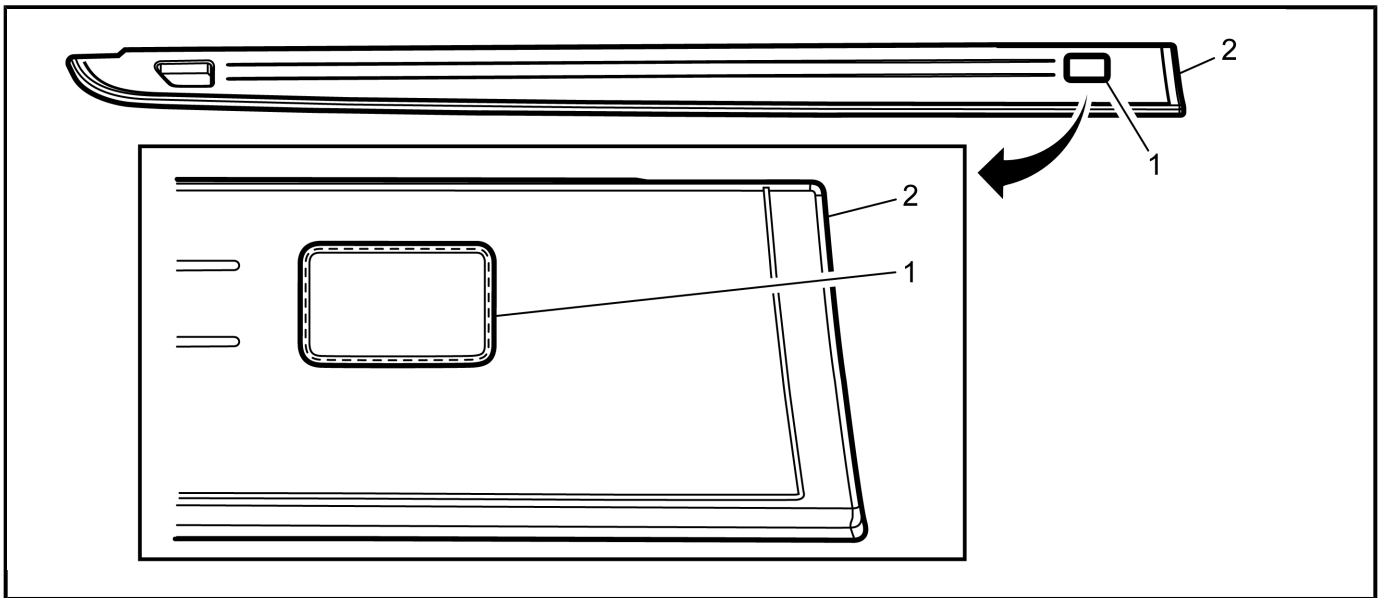

3966605

1. Remove the rectangular recess (1) in the bed rail molding (2) at both front stake pockets with a utility knife or similar cutting tool.
2. Dispose of the removed plastic.

## Foam Pad Assembly

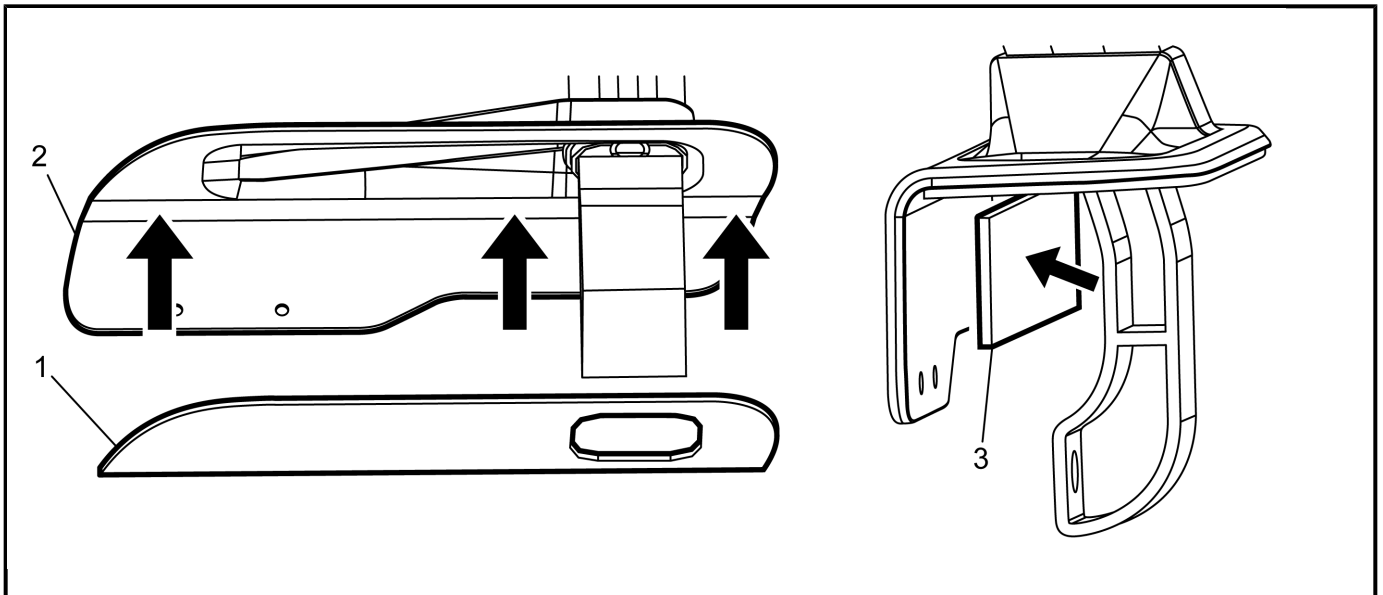

3966606

1. Ensure the underside surface of each stanchion assembly (2) (Items 1 & 2 in parts list) is clean of dust and debris. Peel the backing off the adhesive side of foam pad (1) (Item 11 or 12 in parts list) and apply to the underside of the lower casting (Items 1A & 2A in parts list), making sure to align all edges and apply pressure throughout to ensure adhesion.
2. Repeat for the side foam pad (3) (Item 13 in parts list) and apply foam pads to the remaining stanchion assemblies.

## Bracket Install

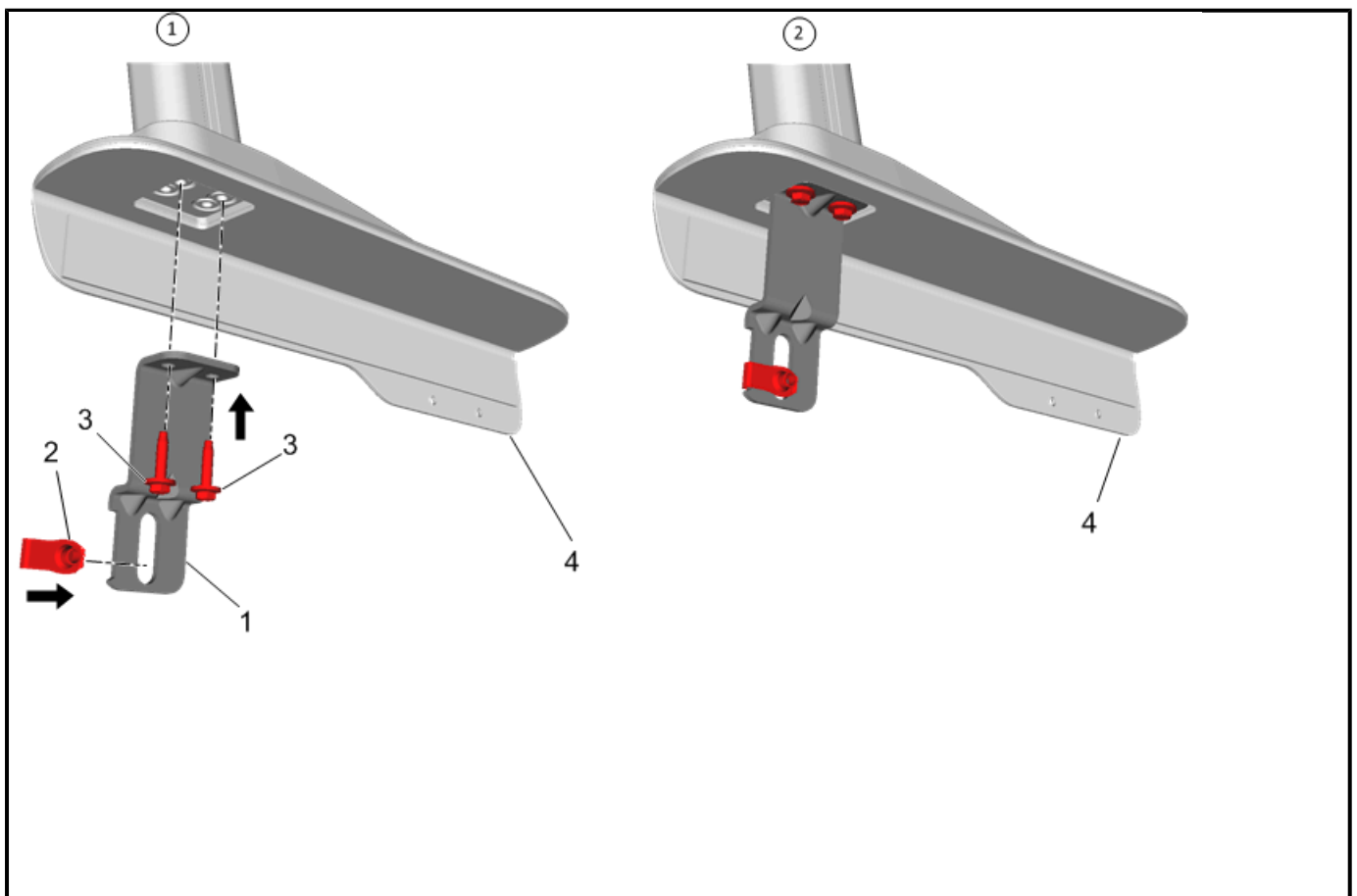

4566770

**Note:** Pictured above – Driver Side Front Stanchion Assembly (4).

Position stake pocket bracket (1) (Items 1D & 2D in parts list) to stanchion (4) and install the supplied bolts (3). Torque the bolts to 22 N.m (16 lb ft).

Slide the U-nuts (1) (Item 6 in parts list) from the hardware kit (Item AA in parts list) onto the stake pocket brackets (1) (Items 1D & 2D in parts list).

All U-nuts should be oriented at the interior edge of the stake pocket bracket as shown. Ensure the threaded side of the U-nut is oriented inside of the stake pocket bracket, so that the stake pocket bracket can sit flat against the inside of the stake pocket during assembly.

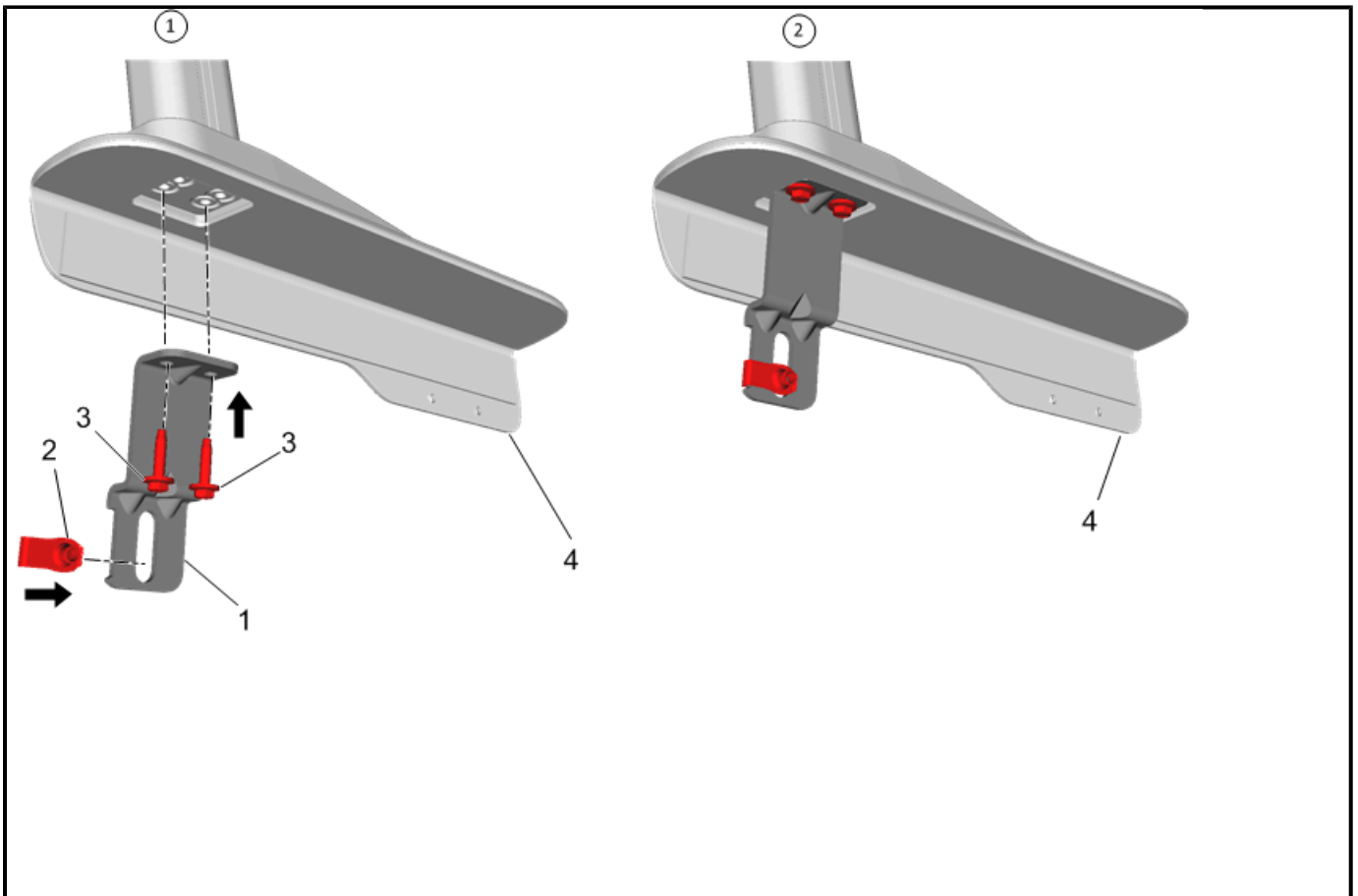

4602871

**Note:** Pictured above – Passenger Side rear Stanchion Assembly (4).

Position stake pocket bracket (1) (Items 1D & 2D in parts list) to stanchion (4) and install the supplied bolts (3). Torque the bolts to 22 N.m (16 lb ft).

Slide the U-nuts (1) (Item 6 in parts list) from the hardware kit (Item AA in parts list) onto the stake pocket brackets (1) (Items 1D & 2D in parts list).

All U-nuts should be oriented at the interior edge of the stake pocket bracket as shown. Ensure the threaded side of the U-nut is oriented inside of the stake pocket bracket, so that the stake pocket bracket can sit flat against the inside of the stake pocket during assembly.

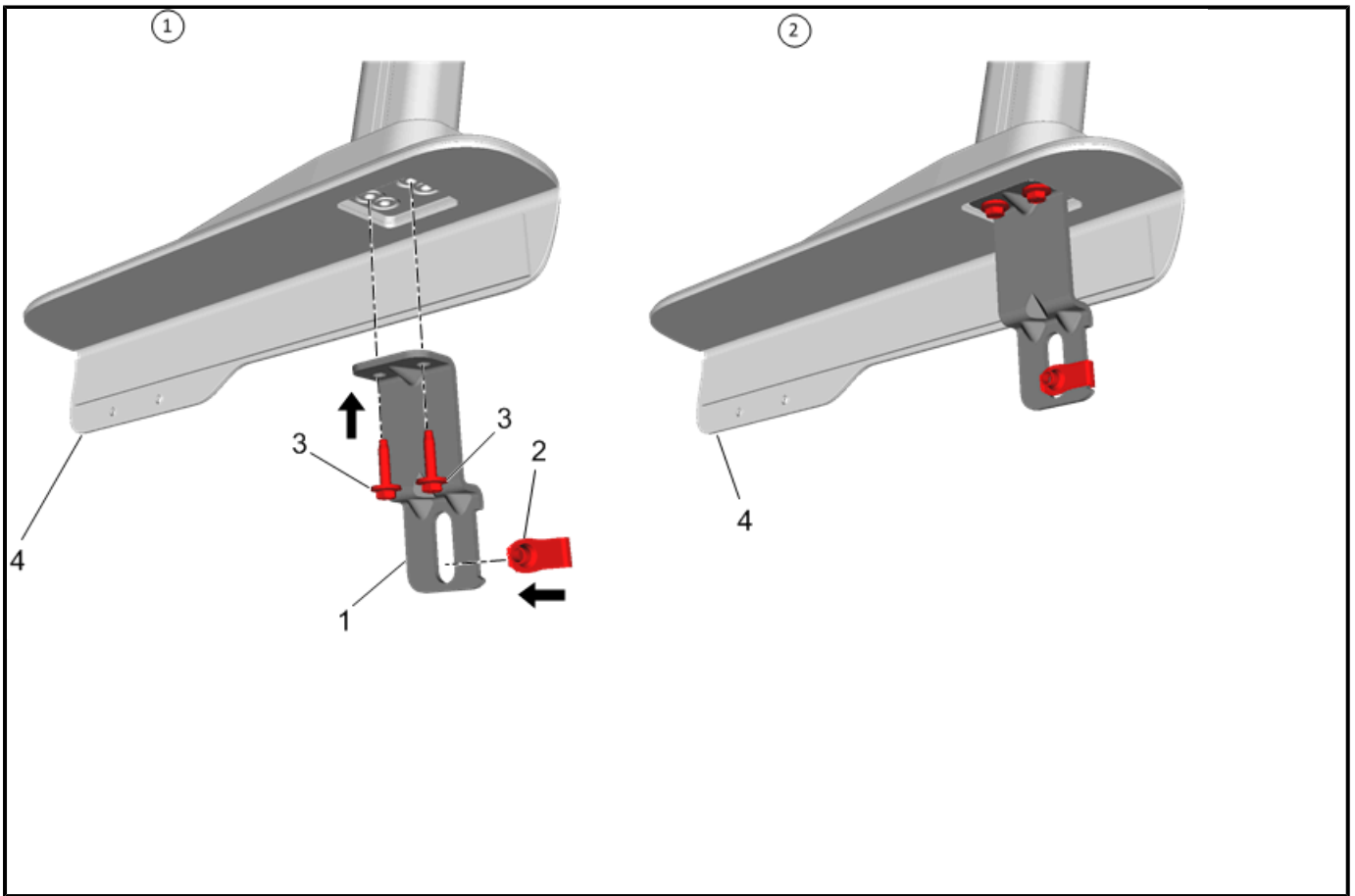

4566771

**Note:** Pictured above – Passenger Side Front Stanchion Assembly (4).

Position stake pocket bracket (1) (Items 1D & 2D in parts list) to stanchion (4) and install the supplied bolts (3). Torque the bolts to 22 N.m (16 lb ft).

Slide the U-nuts (1) (Item 6 in parts list) from the hardware kit (Item AA in parts list) onto the stake pocket brackets (1) (Items 1D & 2D in parts list).

All U-nuts should be oriented at the interior edge of the stake pocket bracket as shown. Ensure the threaded side of the U-nut is oriented inside of the stake pocket bracket, so that the stake pocket bracket can sit flat against the inside of the stake pocket during assembly.

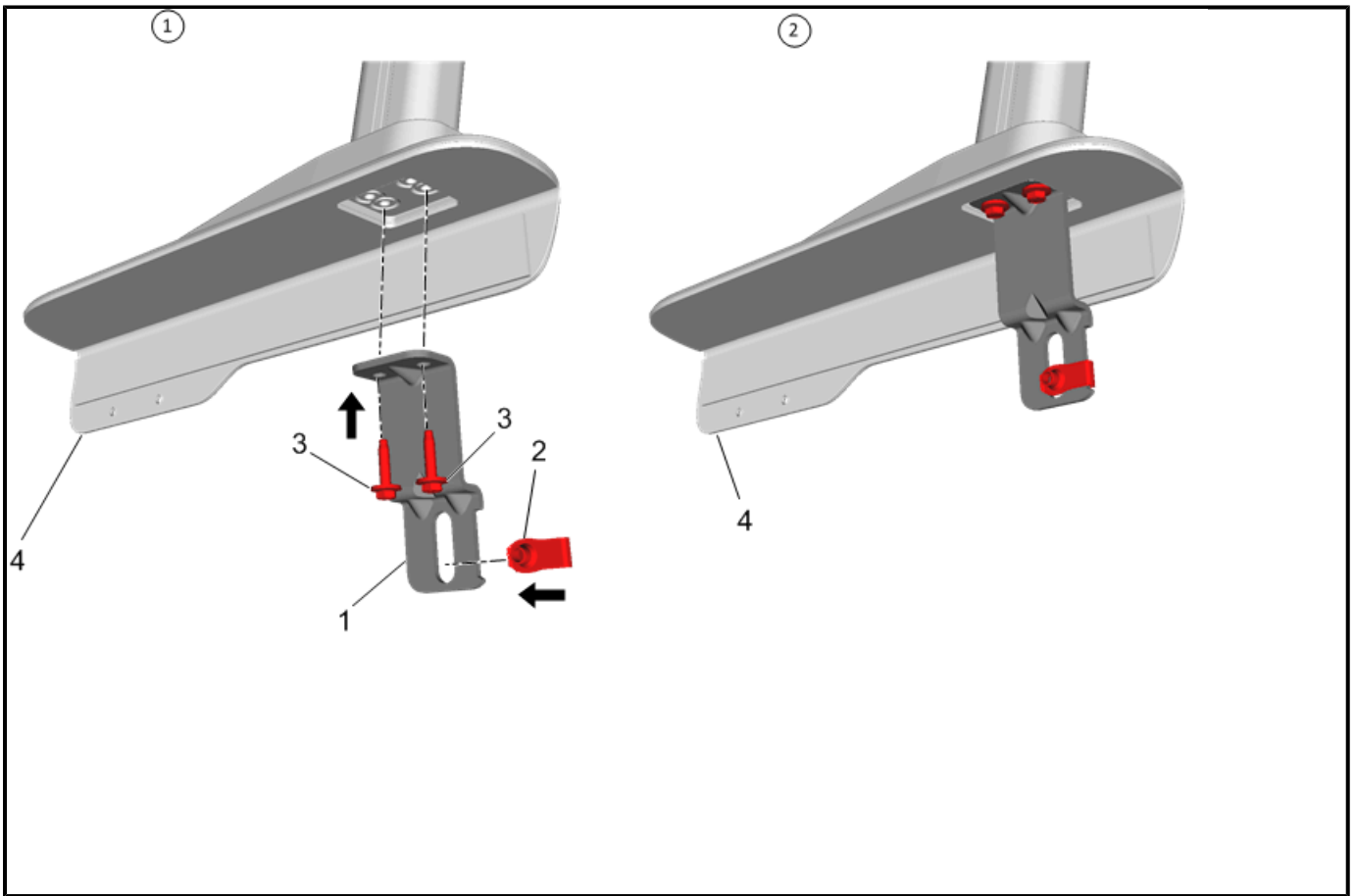

4602881

**Note:** Pictured above – Driver Side rear Stanchion Assembly (4).

Position stake pocket bracket (1) (Items 1D & 2D in parts list) to stanchion (4) and install the supplied bolts (3). Torque the bolts to 22 N.m (16 lb ft).

Slide the U-nuts (1) (Item 6 in parts list) from the hardware kit (Item AA in parts list) onto the stake pocket brackets (1) (Items 1D & 2D in parts list).

All U-nuts should be oriented at the interior edge of the stake pocket bracket as shown. Ensure the threaded side of the U-nut is oriented inside of the stake pocket bracket, so that the stake pocket bracket can sit flat against the inside of the stake pocket during assembly.

## Stanchion Attachment

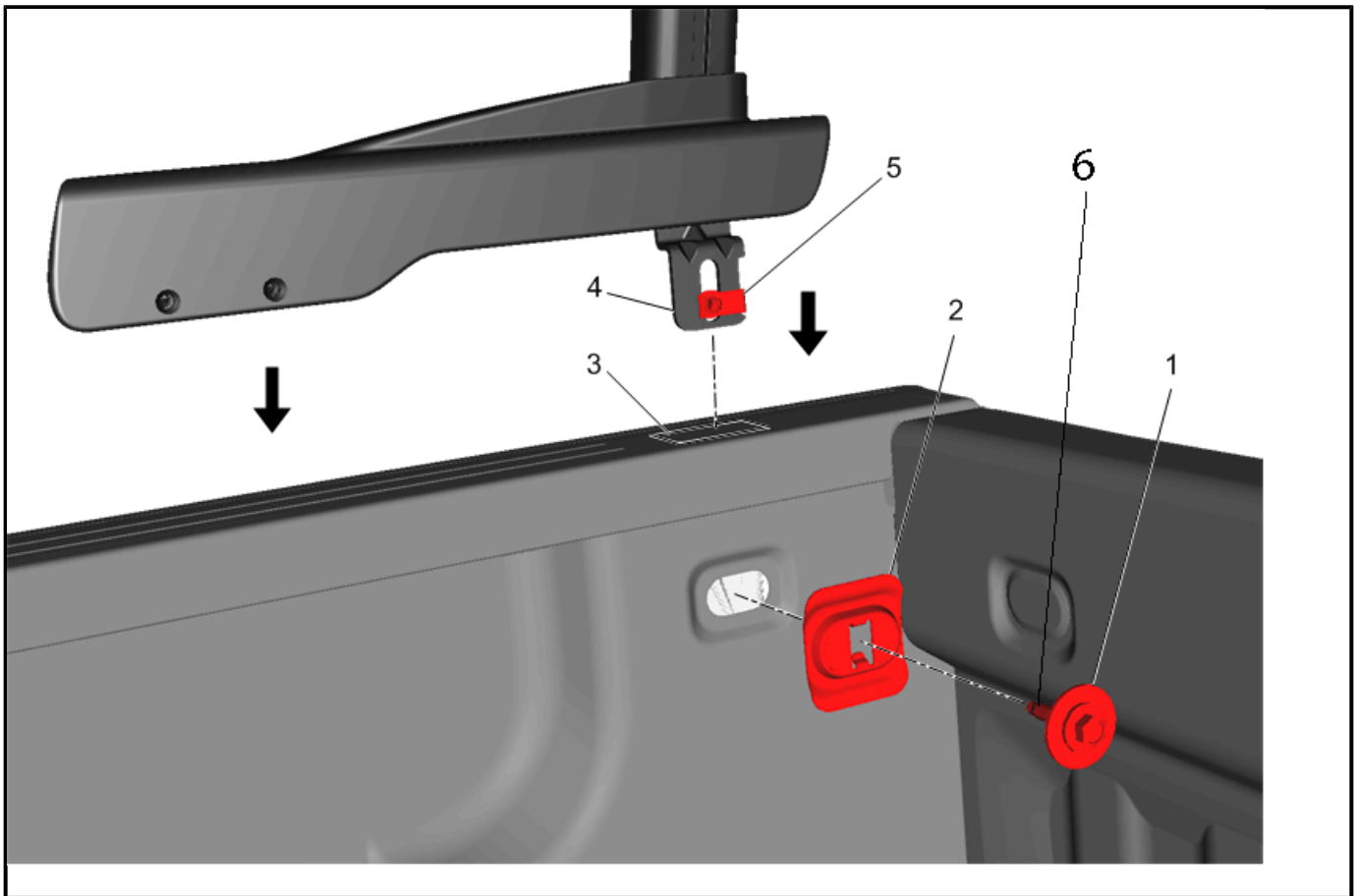

4566773

1. Standing inside the truck bed, carefully install any stanchion assembly (4) (Item 1 or 2 in parts list) into the stake pocket opening (3). It may be required to tilt the stanchion assembly inward to clear the side of the bed wall during assembly and /or disassembly. The pad on the underside of the lower casting will rest flat against the bed rail molding. Ensure the stake pocket bracket U-nut (5) aligns with the stake pocket hole in the bedside.
2. Position bracket (2) to stake pocket hole in bedside and insert washer (1) (Item 7 in parts list) onto the stake pocket fastener (6) (Item 8 in parts list), insert through the hole in the side bed wall, and hand tighten into the U-nut until the stanchion assembly is able to retain its upright position.
3. Repeat for opposing side.
4. Repeat previous steps for remaining stanchions.



## Cross Bar Assembly

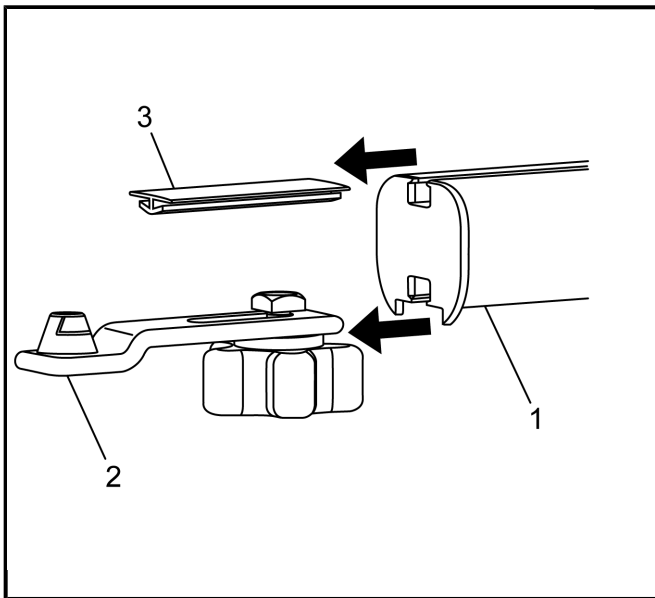

3966616

1. Prepare the tiered storage cross bars (1) (P/N 22950523) for assembly to the stanchions by removing and setting aside the anchor plate assembly (2) and protective rubber strip (3). Save the removed components for installation of the multifunctional, tiered storage to the pick-up box tie downs at a later date.

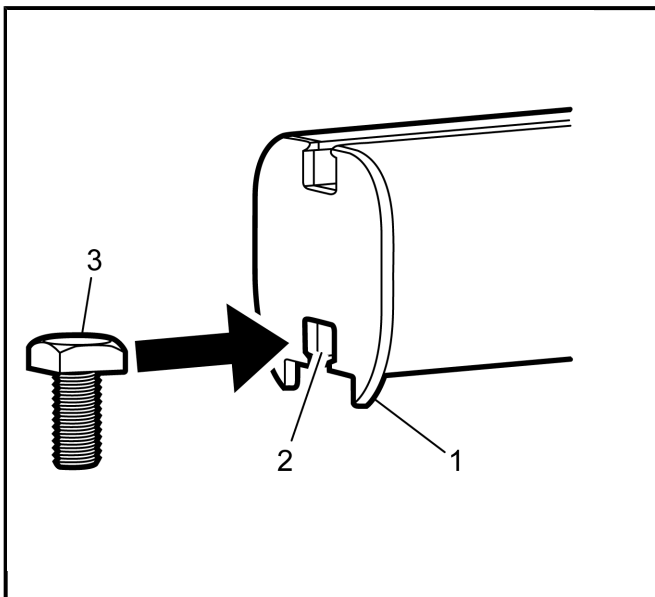

3966617

2. With the cross bar end caps (1) pointed down, slide two of the square head bolts (3) (Item 10 in parts list) into the lower T-slot channel (2) on each end of the cross bar and align with the holes in the upper casting (Item 1B or 2B in parts list).

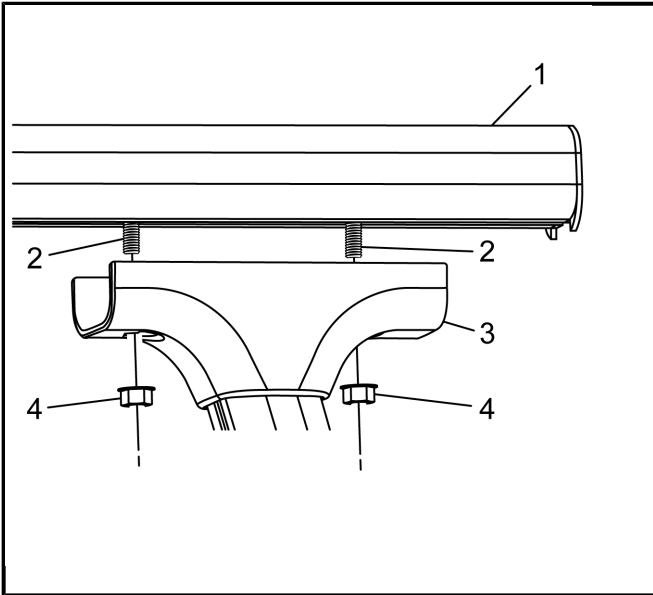

3966618

3. With the bolts (2) aligned properly with the upper casting holes, push the cross bar (1) down onto the upper casting (3) one side at a time, so it seats securely.
4. Loosely install the nuts (4) (Item 9 in parts list) onto the fasteners to allow for cross bar adjustment in the next step.
5. With a tape measure, make sure the cross bar is centered side to side between the two stanchions assemblies. Make sure the stanchions are tight to the sides of the bed rails. The foam pad on the sides of the lower casting should be as close to the bed rails as possible.
6. Hand tighten all four cross bar nuts. Final torque of 22 N.m (16 lb ft).
7. Torque the stake pocket fasteners to 22 N.m (16 lb ft).
8. Repeat previous steps for remaining stanchions.

### Clamp Assembly

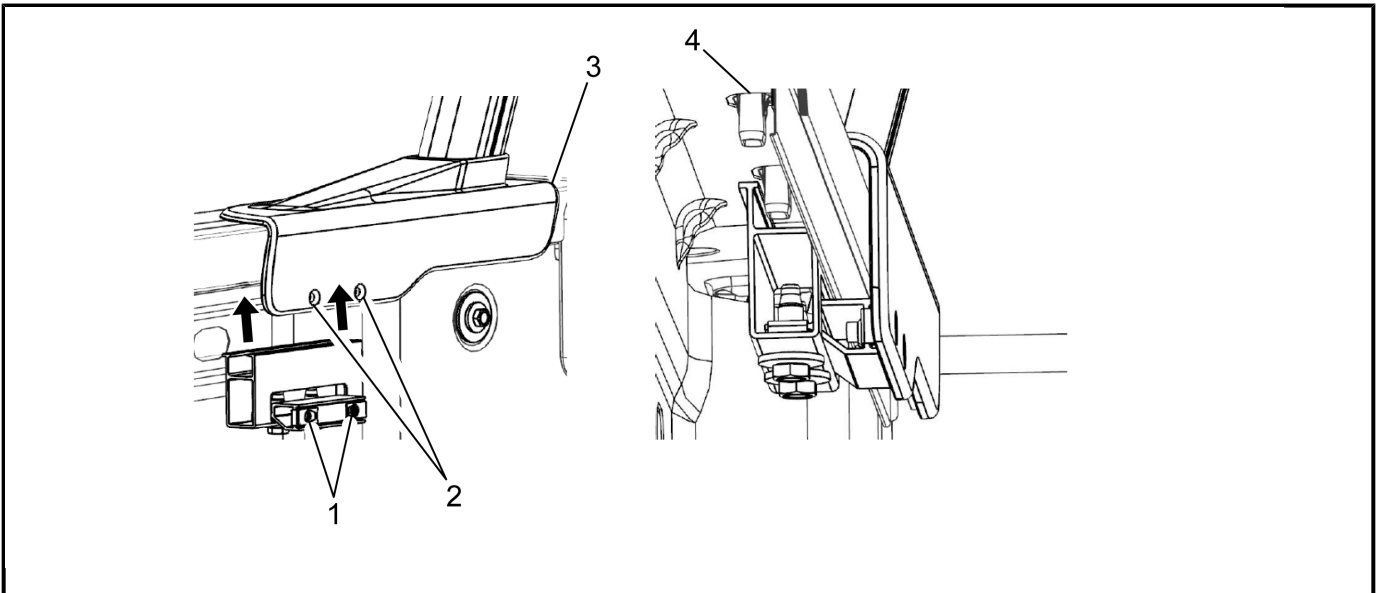

3966619

1. Align the clamp assembly (Item 4 in parts list) U-nuts (1) in the horizontal clamp bracket with the two holes (2) in the lower casting of any of the four stanchion assemblies (3). The vertical clamp bracket (Item 4A in parts list) legs should sit flat against the underside of the bed rail sheet metal and clear the bed rail molding clips (4).

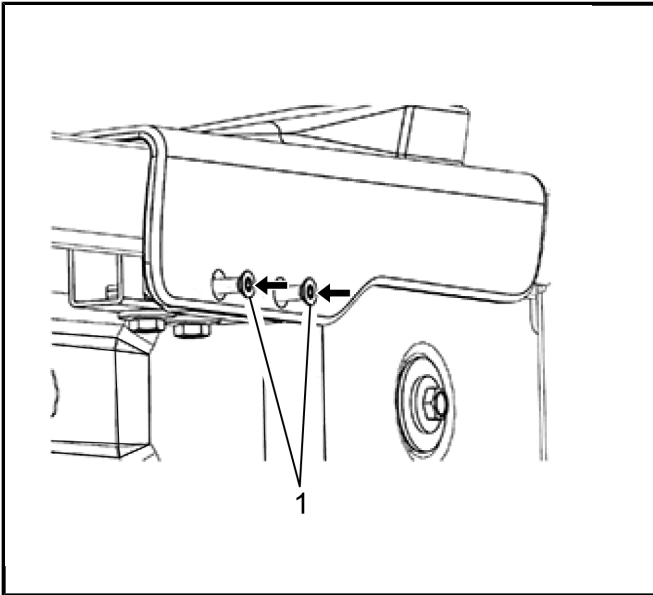

3966620

2. With the vertical clamp bracket in place against the underside of the bed rail sheet metal, install the M6 flat head fasteners (1) (Item 5 in parts list) through the lower casting holes into the horizontal clamp bracket U-nuts.
3. Torque the M6 flat head fasteners to 9 N.m (7.0 lb ft)

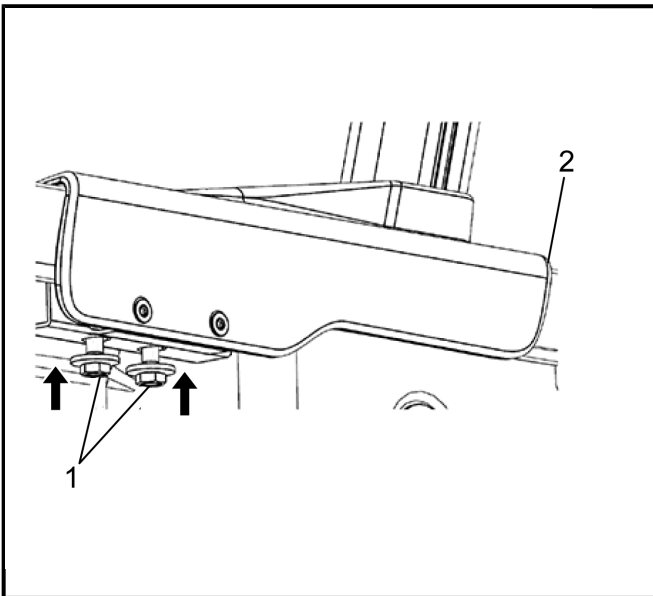

3966621

4. Torque the two vertical clamp bracket bolts (1) (Item 4E in parts list) to 22 N.m (16 lb ft). The stanchion assembly (2) should now be tightly clamped to the bed rail.
5. Repeat previous steps for the remaining stanchion assemblies.
6. Inspect all fasteners to ensure they are properly torqued and utility rack assembly is ready for use.
7. It is advised to inspect all fasteners regularly to ensure utility rack is installed properly and safe for use.