

**Document ID: 4175274**

# Exhaust Muffler Package Installation

## [Installation Instructions Part Number](#)

23442877

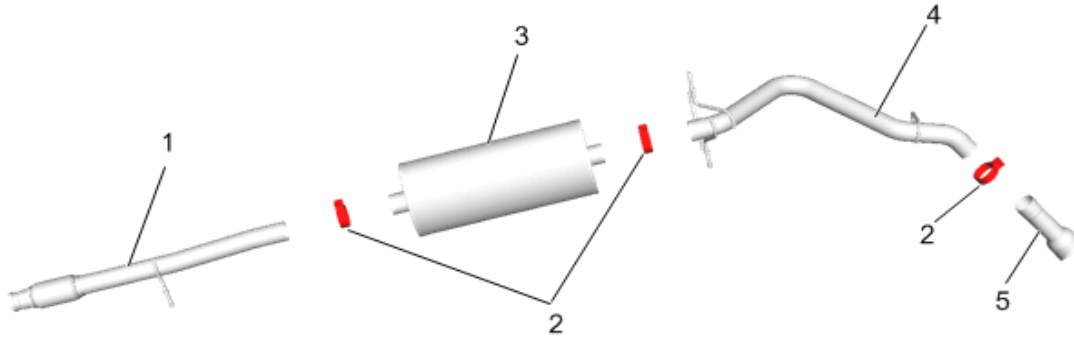

### Kit Contents

Item	Qty	Description
1	1	Front Pipe with Flange
2	3	Clamps
3	1	Muffler

© 2018 General Motors. All rights reserved.

Item	Qty	Description
4	1	Tail Pipe
5	1	Polished Tip
-	1	Chevrolet Performance Badge (Silverado Only)
-	1	Installation Instructions

### Procedure

**Caution:** Never work on a hot exhaust system. Serious injury in the form of burns can result. If the vehicle has been in use and the exhaust system is hot, allow vehicle to cool for at least 1 hour. Always wear eye protection when working under any vehicle.

**Note:** It is our recommendation that you use a hoist or hydraulic lift to facilitate the installation of your new GM Performance Parts Exhaust upgrade package.

Taking all under car safety precautions, lift the vehicle using a hoist or hydraulic lift. Once this has been done, you may begin working on the exhaust system.

**Note:** Please compare the parts you have received with the bill of materials provided to assure that you have all the parts necessary for the installation of your new GM Performance Parts Exhaust upgrade package.

### **Removal**

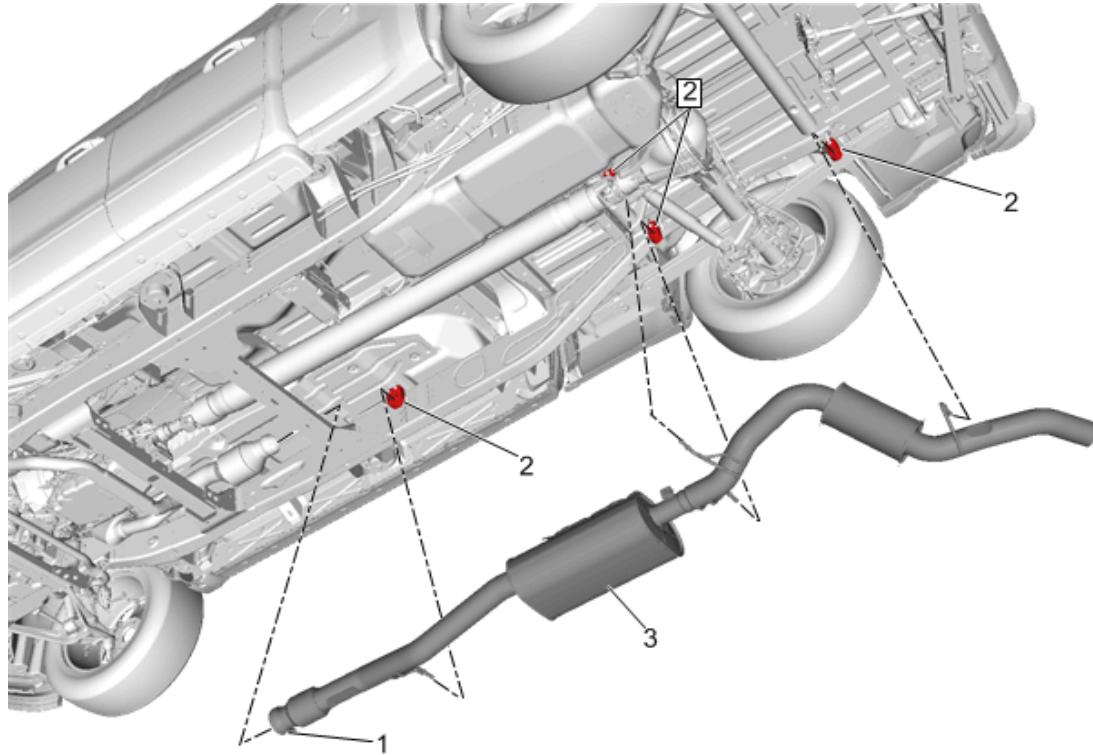

1. Support the exhaust system using jack stands.
2. Loosen the spherical clamp at location (1) so that the flanges can be separated.
3. Remove the rubber isolators (2) from the exhaust system.
4. Remove the factory installed cat-back exhaust system (3) by pulling it forward and guiding tailpipe over axle.

### **Installation**

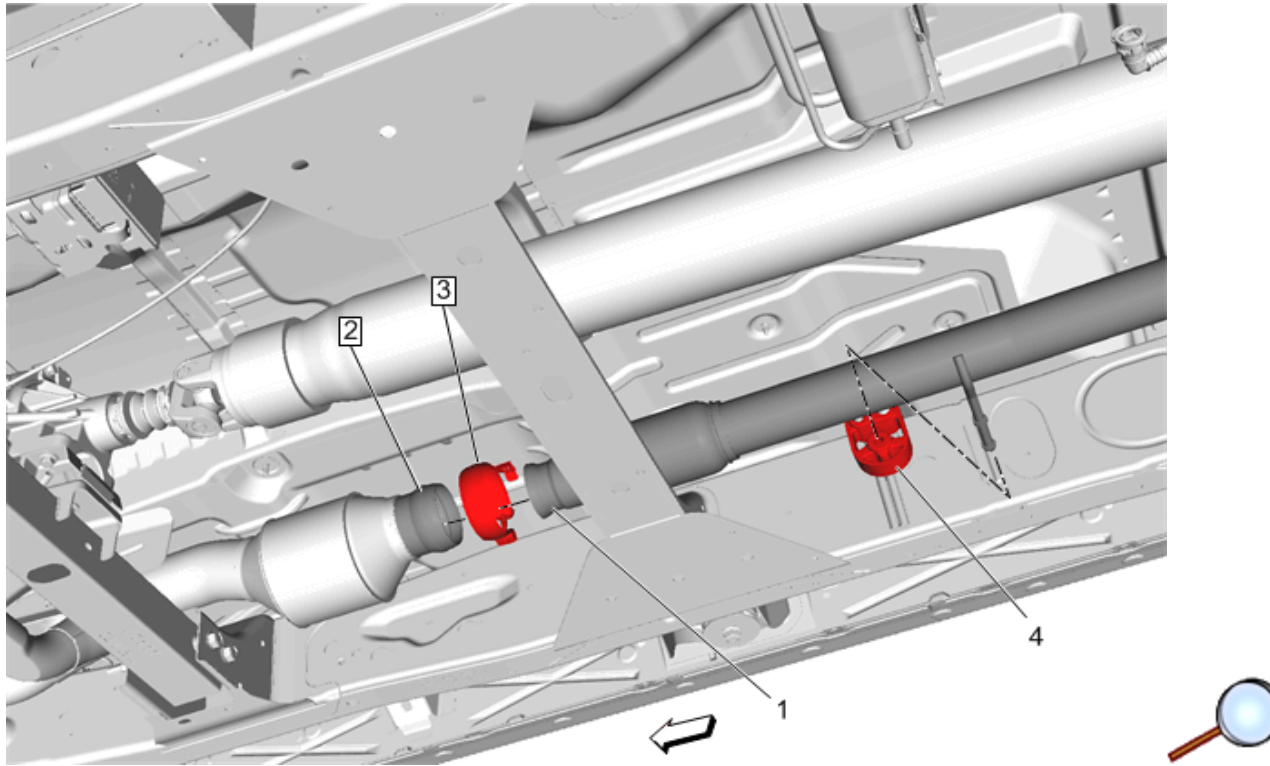

**Caution:** Use the correct fastener in the correct location. Replacement fasteners must be the correct part number for that application. Fasteners requiring replacement or fasteners requiring the use of thread locking compound or sealant are identified in the service procedure. Do not use paints, lubricants, or corrosion inhibitors on fasteners or fastener joint surfaces unless specified. These coatings affect fastener torque and joint clamping force and may damage the fastener. Use the correct tightening sequence and specifications when installing fasteners in order to avoid damage to parts and systems.

1. Install the front pipe (1) onto flange (2) and hand tighten the clamp (3). Seat hanger and pipe into rubber grommet (4).

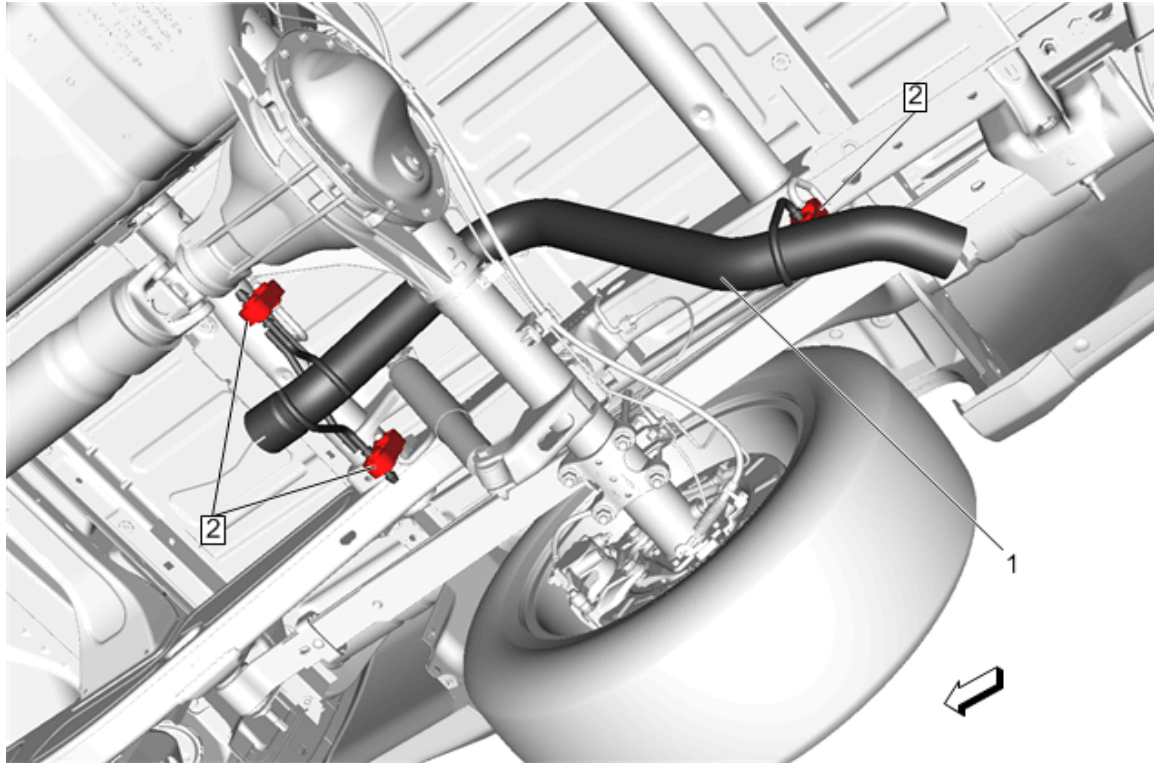

2. Install tail pipe (1) over axle. Seat pipe into the hangers (2) at the front of the axle and one hanger in the rear.

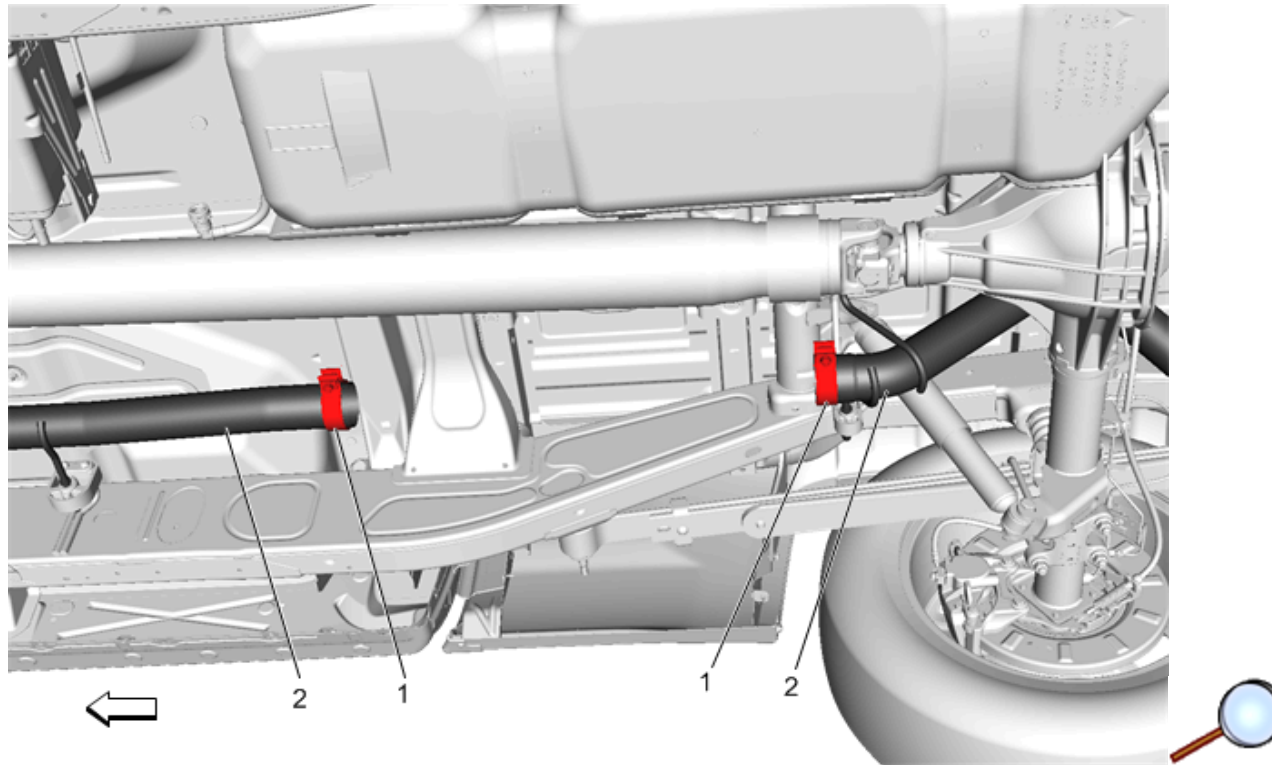

3. Seat two of the clamps (1) for the muffler on pipes (2) to either side of where the muffler will be installed.

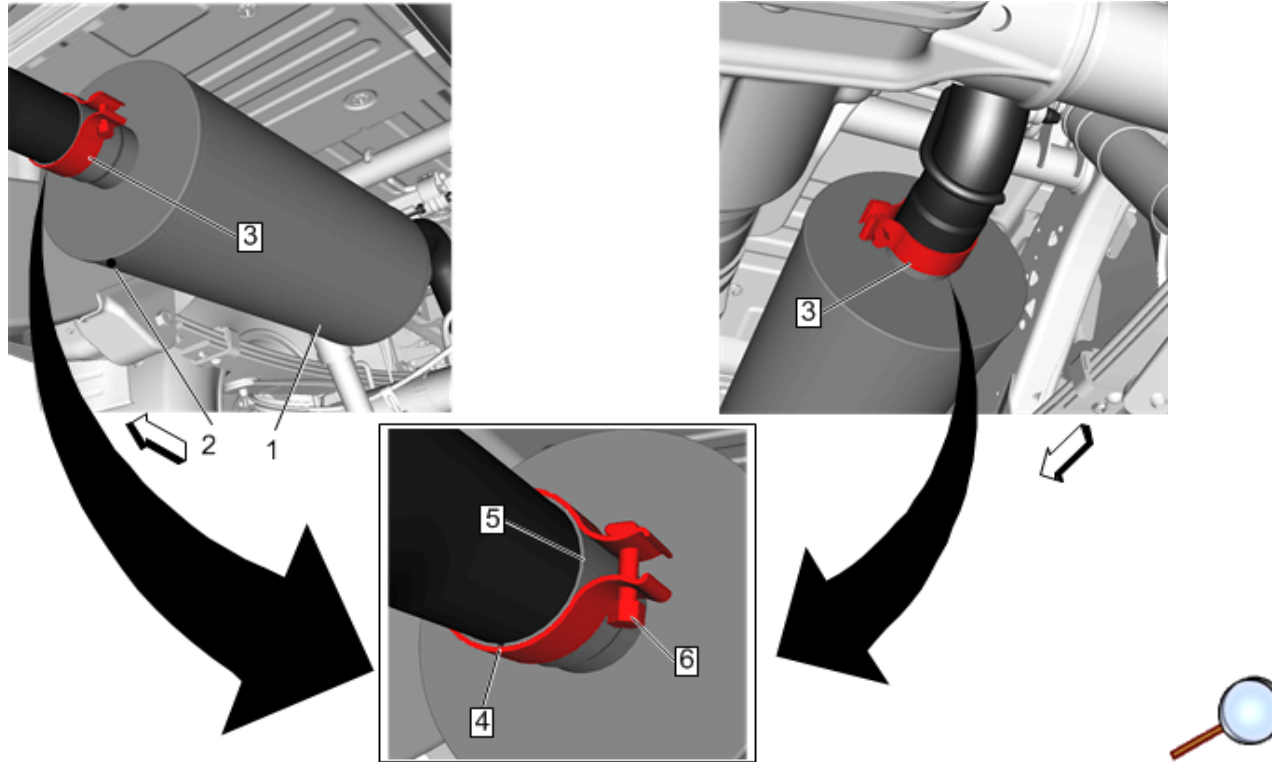

4. Install muffler (1). Align muffler so that the small hole (2) in end of case is facing down. This hole allows condensation to drain out from muffler.
5. Seat clamps (3) onto both ends of muffler and align clamp at end of expanded tube (5) while positioning slot (4) 90° off clamp bolt (6).

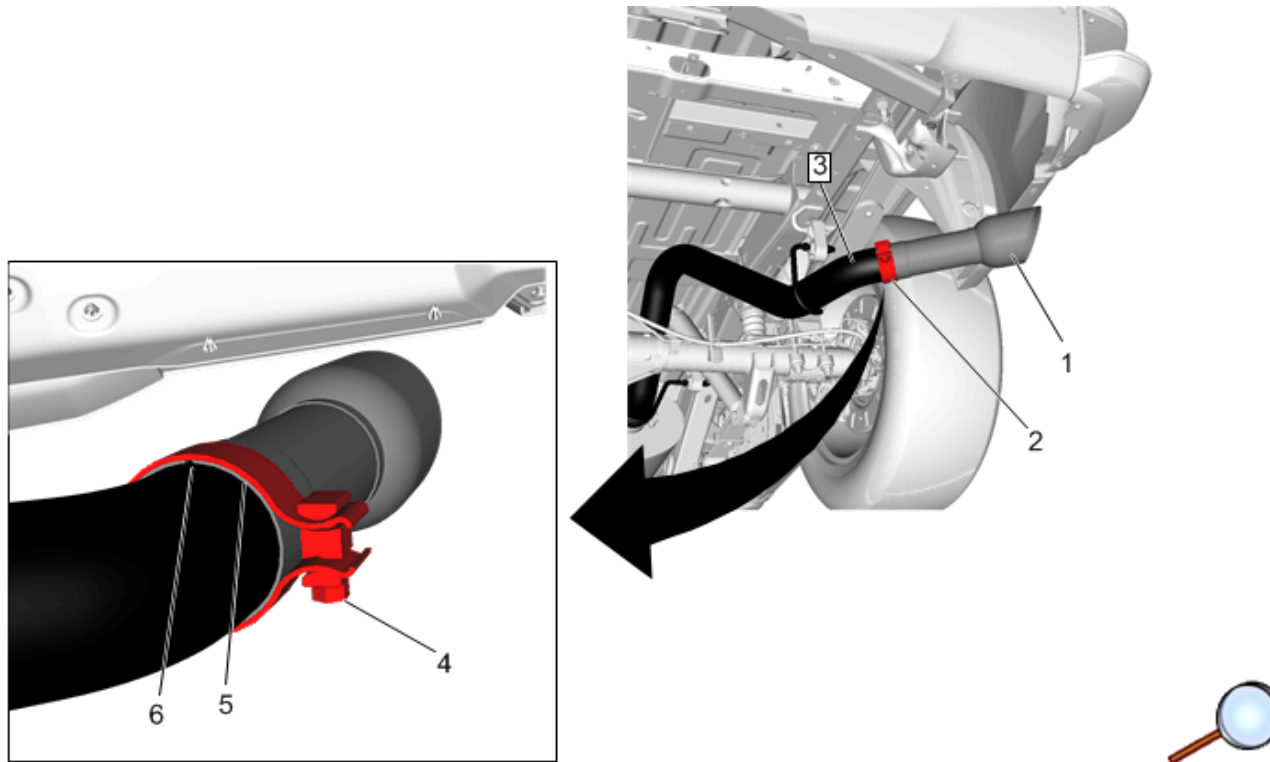

6. Install tip (1) onto tailpipe (3) with clamp (2) and align clamp at end of expanded tube (5) while positioning slot (6) 90° off clamp bolt (4).
7. Do a final alignment check on the system. System should be installed with all clamps indexed but not tightened. The polished tip should be approximately one inch below the box and not sticking out past the side of the box. Seat tip as far back on the tail pipe as it will go.



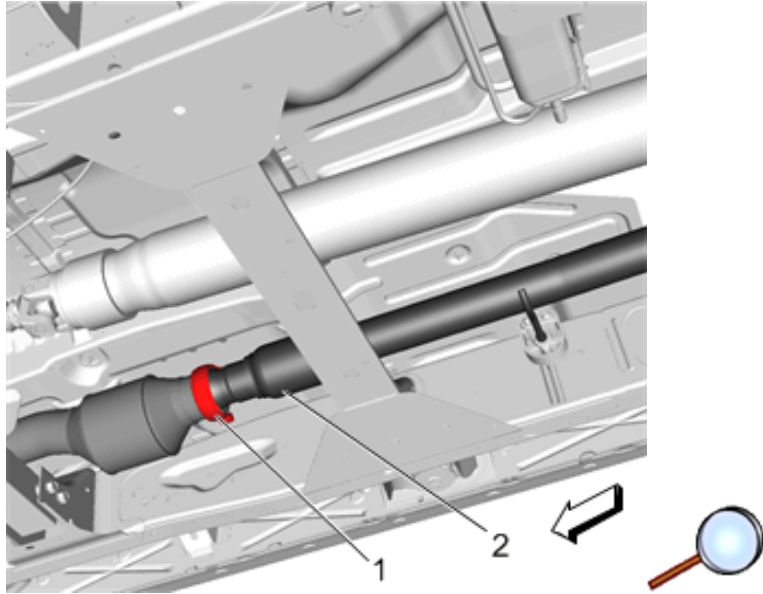

8. Tighten the clamp (1) holding attaching the cat-back (2) and tighten to 28 Nm (21 lb ft).

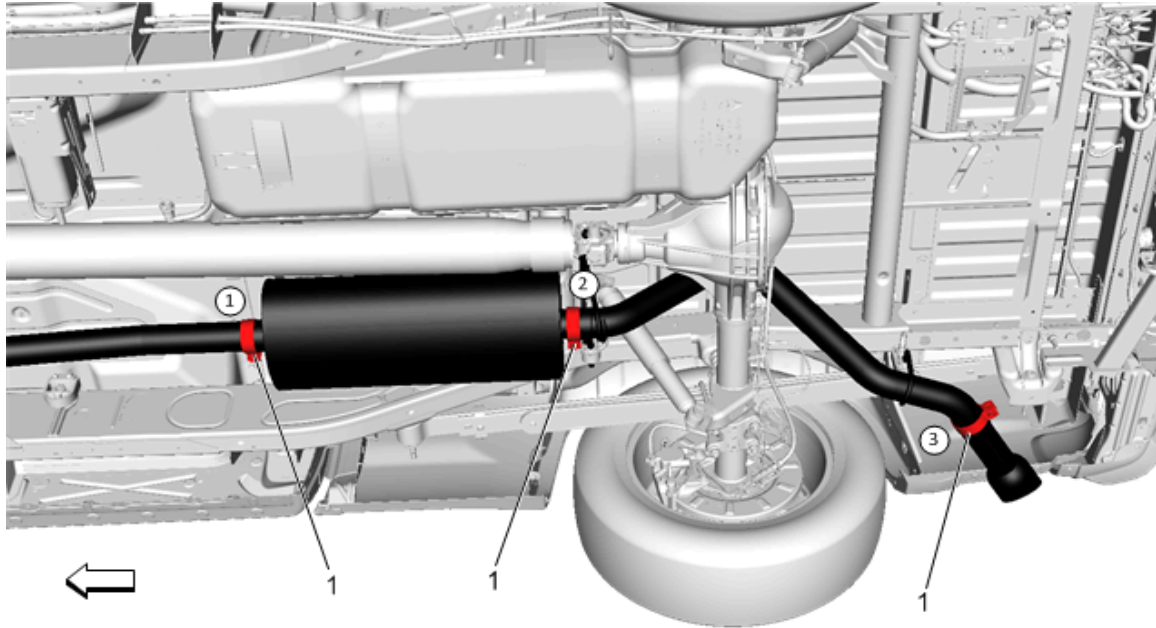

9. Tighten the three clamps (1) starting at the front and working towards the rear. Torque the clamps to 61 Nm (45 lb ft).

**Note:** When you first start your vehicle after the installation of your new GM Performance Parts Exhaust upgrade package, there may be some smoke and fumes coming from the system. This is a protective oil based coating used in the manufacture of the performance exhaust tubing. This is not a problem and will disappear within a very short period of time after the exhaust has reached normal operating temperatures.

10. If this exhaust kit is being installed on a 6.2 liter (L86) truck, there may be a calibration available for the Active Noise Cancellation (ANC) to better match the sound of your new exhaust system. A custom calibration is available for all 6.2 light duty trucks with Bose stereo. A calibration is also available for the Crew Cab that is equipped with the base stereo. For trucks with the Double Cab and base stereo, the base truck calibration is compatible.

**Note:** Reprogramming is done with a Service Programming System at an Authorized GM Dealer. When reprogramming, the GM dealer needs to call the Techline Customer Support Center (TCSC). The TCSC will provide a Vehicle Configuration Index (VCI). The VCI is good for only one specific Vehicle Identification Number (VIN). Call TCSC to obtain a VCI number. United States 1-888-337-1010 Canada (English) 1-800-828-6860 Canada (French) 1-800-503-3222. You must have the vehicle's VIN that will be upgraded and the provided Authorization Code in Kit. No label will not be present in instructions included with the 5.3 exhaust kits.