

Document ID: 4481481

Mobile Telephone Cradle Package Installation

Installation Instructions Part Number

23457342

Kit Contents

Qty	Description
1	Module
1	Module Bracket
1	Rubber Mat
2	Harnesses
8	Screws
1	Installation Instructions

Procedure

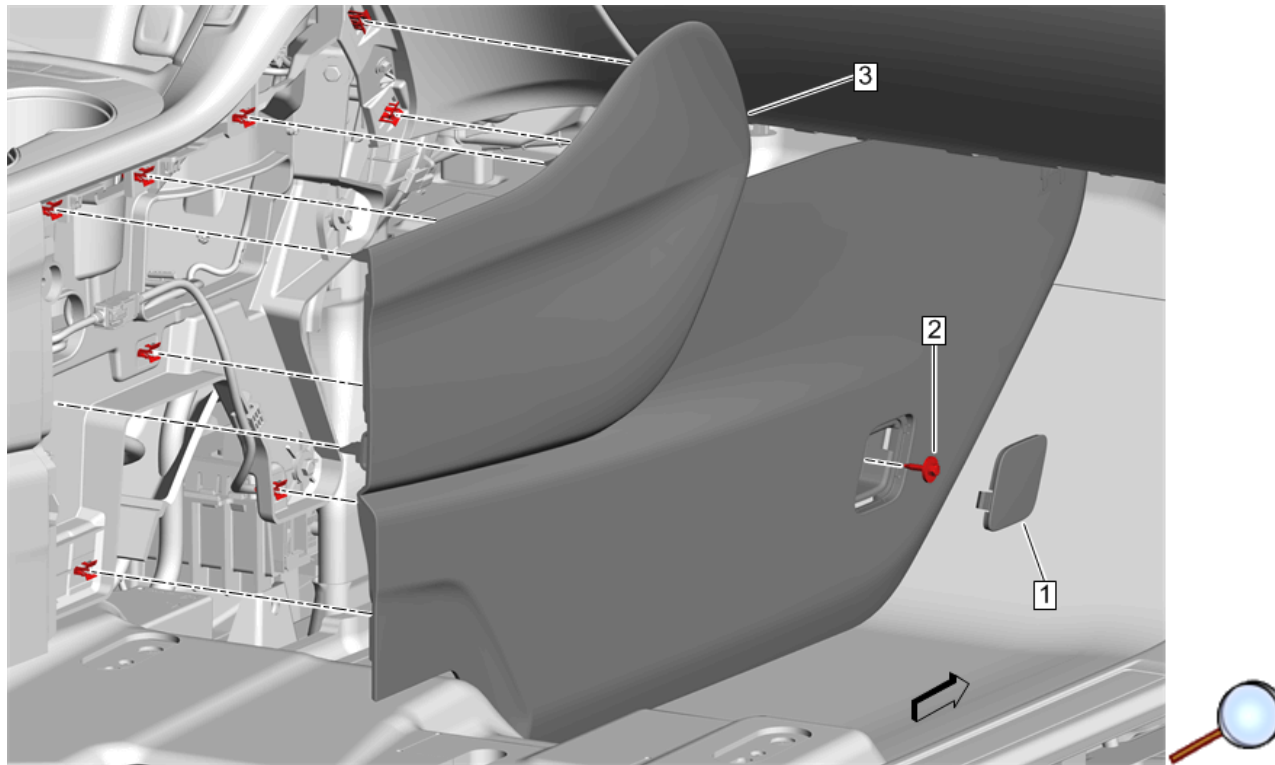

1. Using a suitable tool remove the right front floor console bolt access hole cover (1).
2. Remove and retain the right front floor console extension bolt (2). Upon reassembly tighten the bolt to 2.5 N.m (22 lb in).
3. Position the right front seat in order to access the front floor console extension panel retainers.
4. Using a flat-bladed plastic trim tool, remove the right front floor console extension panel (3).

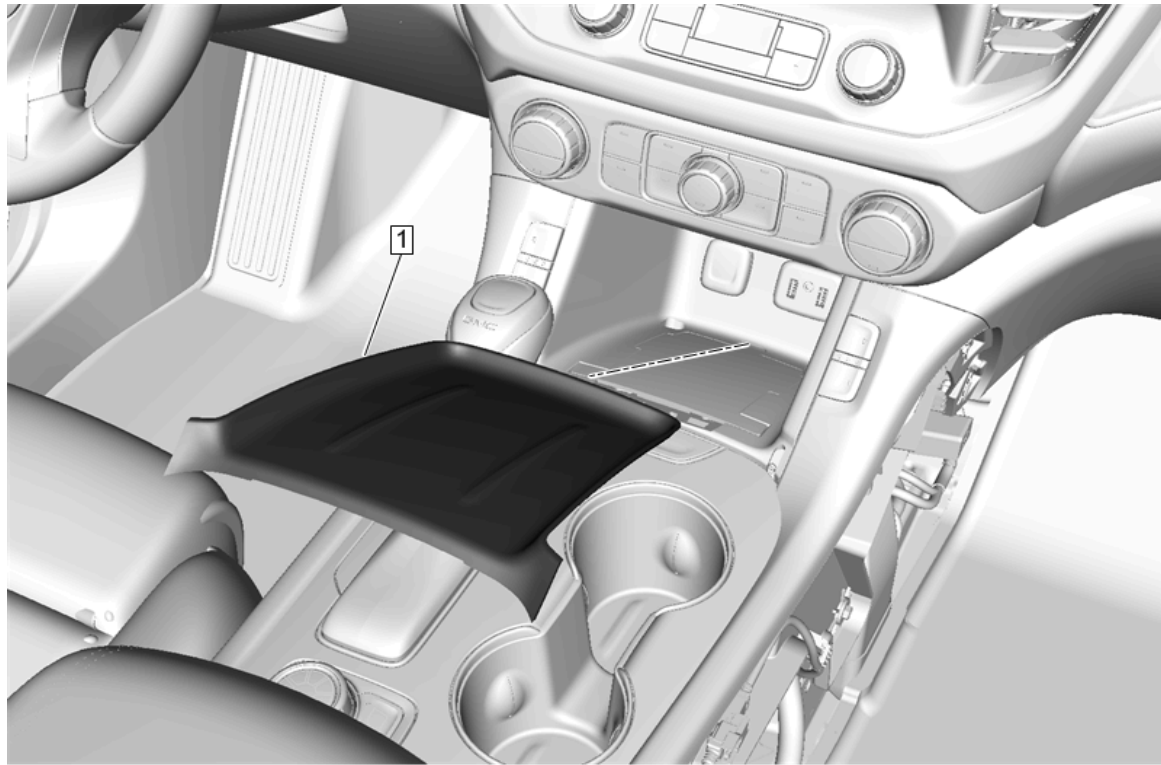

5. Lift up and remove the front floor console bin liner (1).





6. Using a suitable tool remove and discard the front floor console cover plate (1).

Note: Do not reinstall the front floor console cover plate as it will cause interference with charging.

Note:

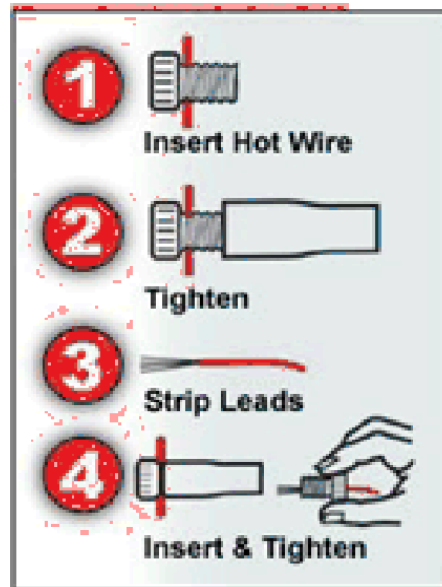

- "Two accessory kits may exist for this product. If your kit contains the Posi-Tap splices, proceed to next steps 7-9".

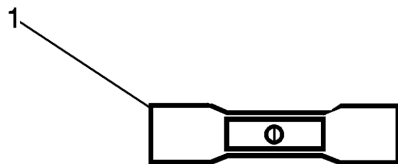

- "If your kit includes the standard GM splice barrels (1) proceed to steps 10-13"

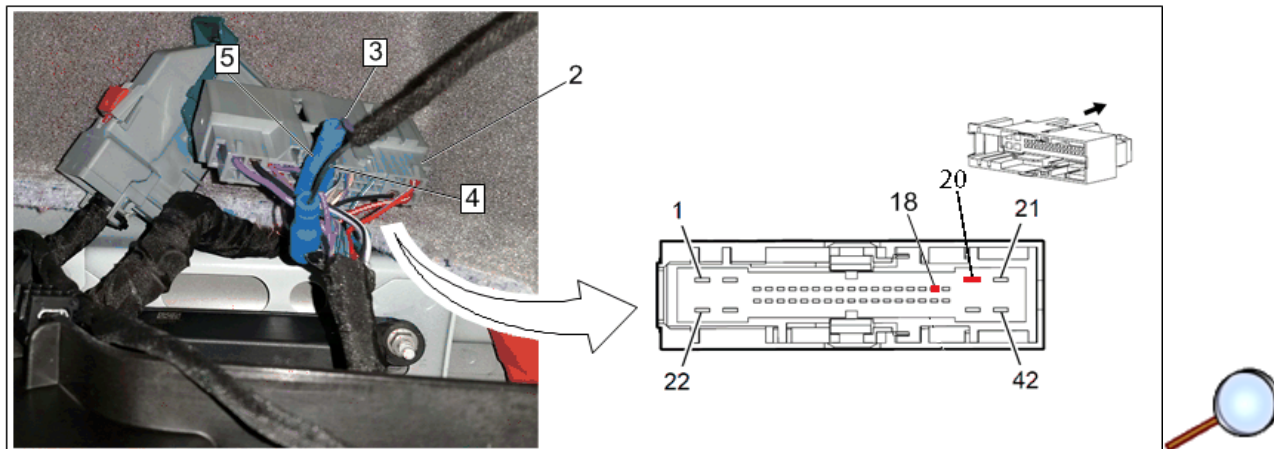
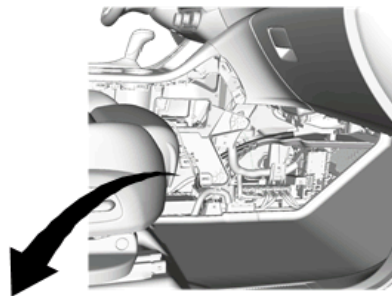
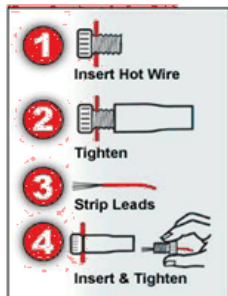

7. Route accessory harness leads to front floor console connector (2) (**P/N 13597186**; 42-way male).
8. At the front floor console connector (2), locate wires in **cavities 18 and 20**. Remove approx 30mm of the tape-over wrap exposing the wires beneath to locate the wires in those cavities. Locate the **VIOLET** wire (3) on the accessory harness. Using one of the enclosed Posi-taps (5), splice the **VIOLET** wire to the wire entering **cavity 18**.
9. Locate the wire at **cavity 20** and repeat the above process with the accessory harness **BLACK** wire (4) using the other Posi-tap.

Note:

- There will be terminals crimped on the ends of both of these accessory wires. Clip the terminals off and discard, they will not be used.
- Once complete, continue to step 14 for IO5/IO6 radio wire routing.

10. Route accessory harness leads to front floor console connector (2).
11. At front floor console connector (2), locate wires in **cavities 18 and 20**. Remove approx 75mm of the tape-over wrap exposing the wires beneath to get at the wires in those cavities. Cut the **VIOLET** wire that enters **cavity 18** and strip back the insulation on both sides. Locate the **VIOLET** wires on the accessory harness. Using the enclosed **RED** splice barrels, splice both accessory **VIOLET** wires into ends of the cut wire (that enter **cavity 18**).
12. Locate the wire at **cavity 20** and repeat the above process with the accessory harness **BLACK** wires using the other **BLUE** splice barrels.

Note: Use standard GM approved procedures for installing and crimping splices.

13. Re-tape harness as close to back of connection as possible.

Note: Once complete, continue to step 14 for IO5/IO6 radio wire routing.

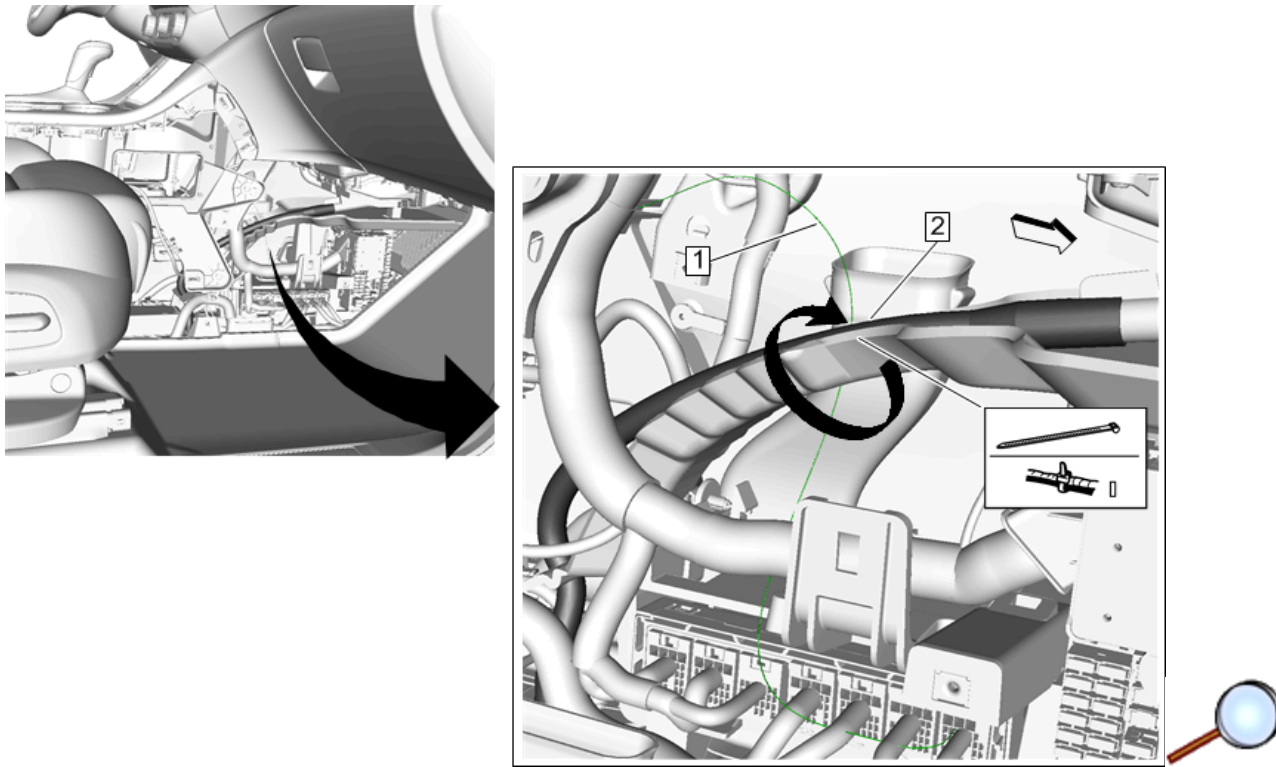

Note: Steps 14 and 15 or for vehicles equipped with (IO5) or (IO6) radios only.

14. If vehicle is equipped with (IO5) or (IO6) radio, route accessory harness (1) Green lead to left side of drain hose (2) and install tie strap.

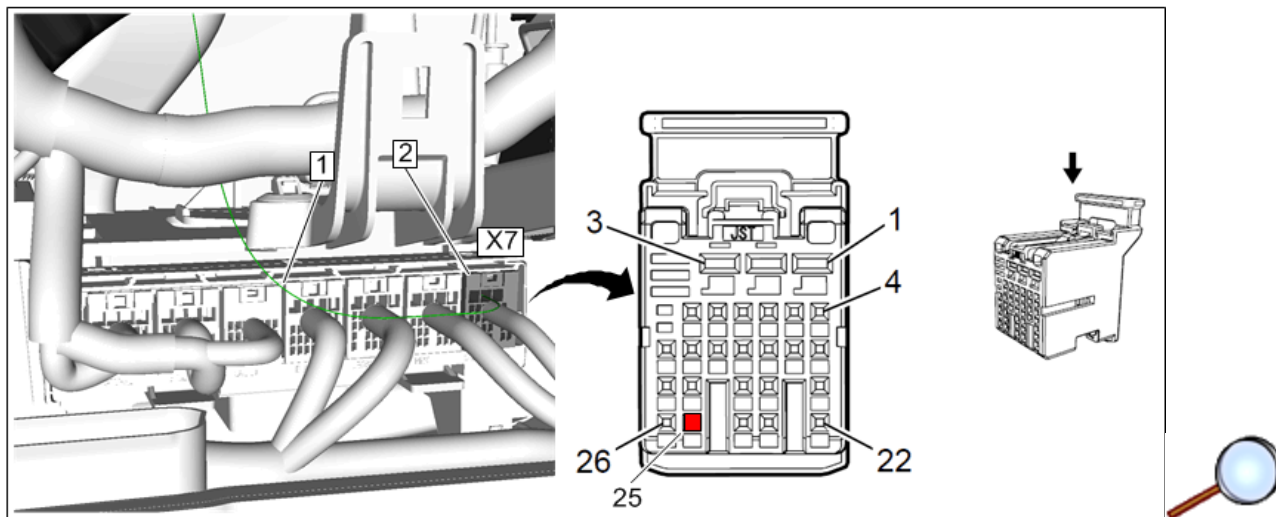
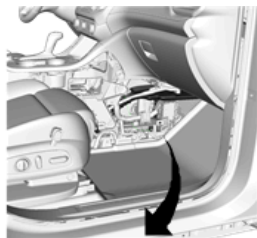

15. If vehicle is equipped with (IO5) or (IO6) radio, route accessory harness (1) Green lead to BCM (2) and insert terminal in connector **X7** **Gray** cavity **25**.

Addendum to Step 15

- 15.1. If the vehicle is a 2017 vehicle, insert the terminal on the Dark Green wire of the main harness directly into cavity **25**. You will not use the extra jumper harness in kit (labeled as **P/N 84427979**). It can be discarded.
- 15.2. If vehicle is a 2018 or later, the current terminal on the main harness kit will not plug into cavity **25**. Cut the existing terminal from the Dark Green wire of the main harness. In its place, splice in the additional kit harness lead **P/N 84427979** using the splice clip in the pack. Then insert this new terminal into cavity **25** of BCM connector **X7**.

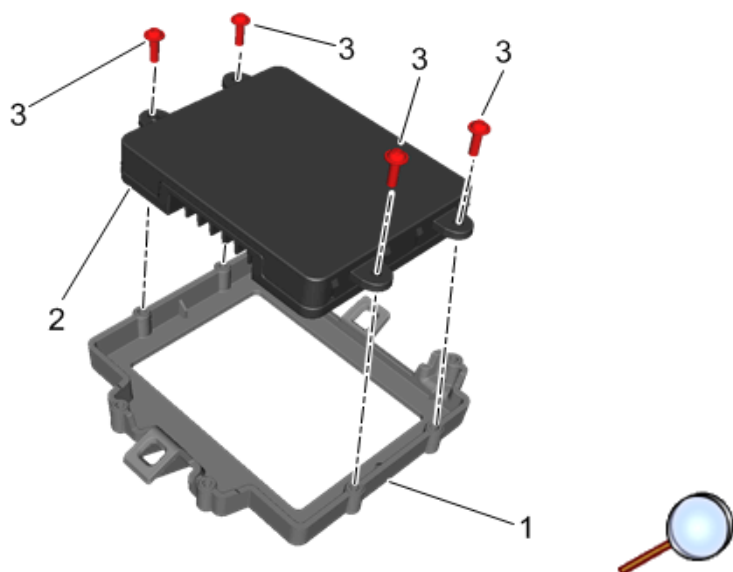

Caution: Use the correct fastener in the correct location. Replacement fasteners must be the correct part number for that application. Fasteners requiring replacement or fasteners requiring the use of thread locking compound or sealant are identified in the service procedure. Do not use paints, lubricants, or corrosion inhibitors on fasteners or fastener joint surfaces unless specified. These coatings affect fastener torque and joint clamping force and may damage the fastener. Use the correct tightening sequence and specifications when installing fasteners in order to avoid damage to parts and systems.

16. Install module (2) to bracket (1) and secure with the supplied screws (3). Tighten the screws to 1.2 N.m (11 lb in).

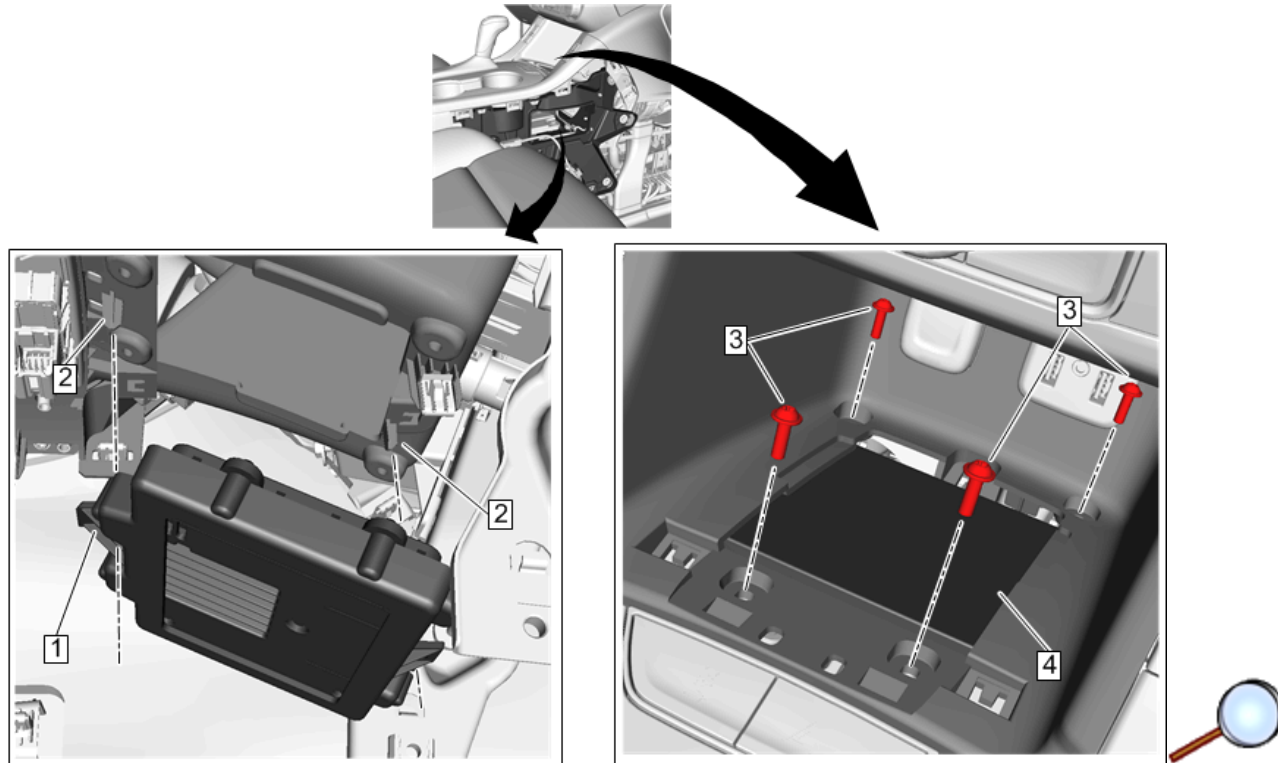

17. Pass module and bracket (1) through access hole in side of console and position to locating tabs (2) under bin.

18. From top side of console bin install the supplied screws (3) to secure module and bracket (4). Tighten the screws to 1.2 N.m (11 lb in).

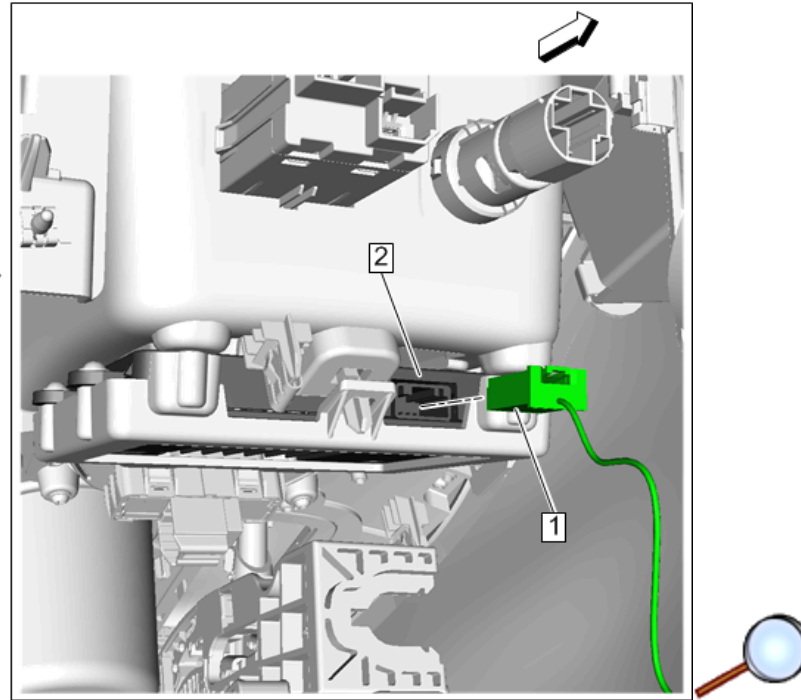
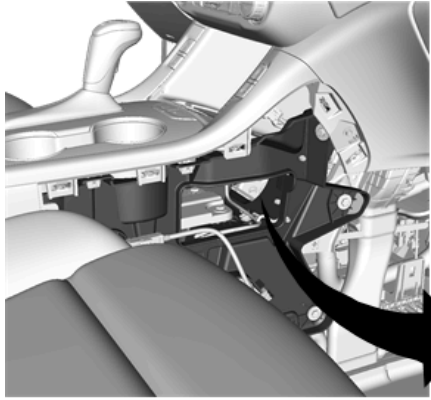

19. Install accessory harness connector (1) to module (2).

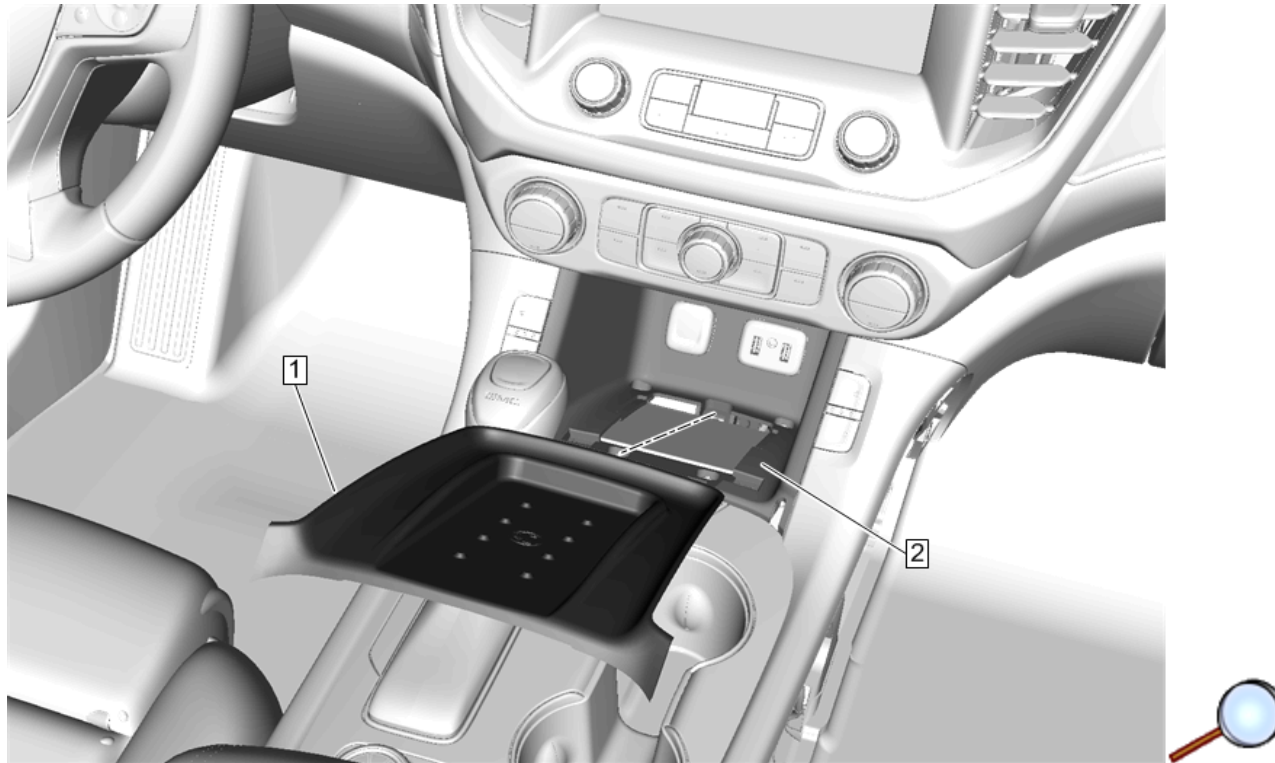

20. Install rubber mat (1) to console bin (2).
21. **On vehicles equipped with (IO5) or (IO6) radio, BCM calibration is required to enable the charging icon on ICS display. Refer to supplied instruction in kit.**
22. Charger module is ready to test.
23. Re-install any previously removed components.