

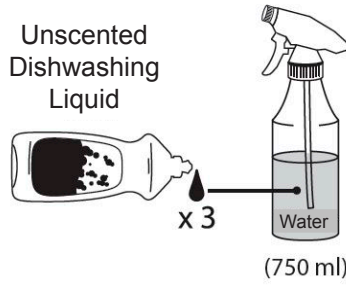

IPA (70%)
Water (30%)



Unscented
Dishwashing
Liquid



x 3
Water
(750 ml)



Squeegee

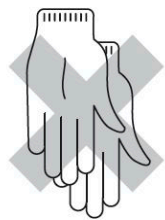



SERVICE



21°C-32°C
70°F-90°F

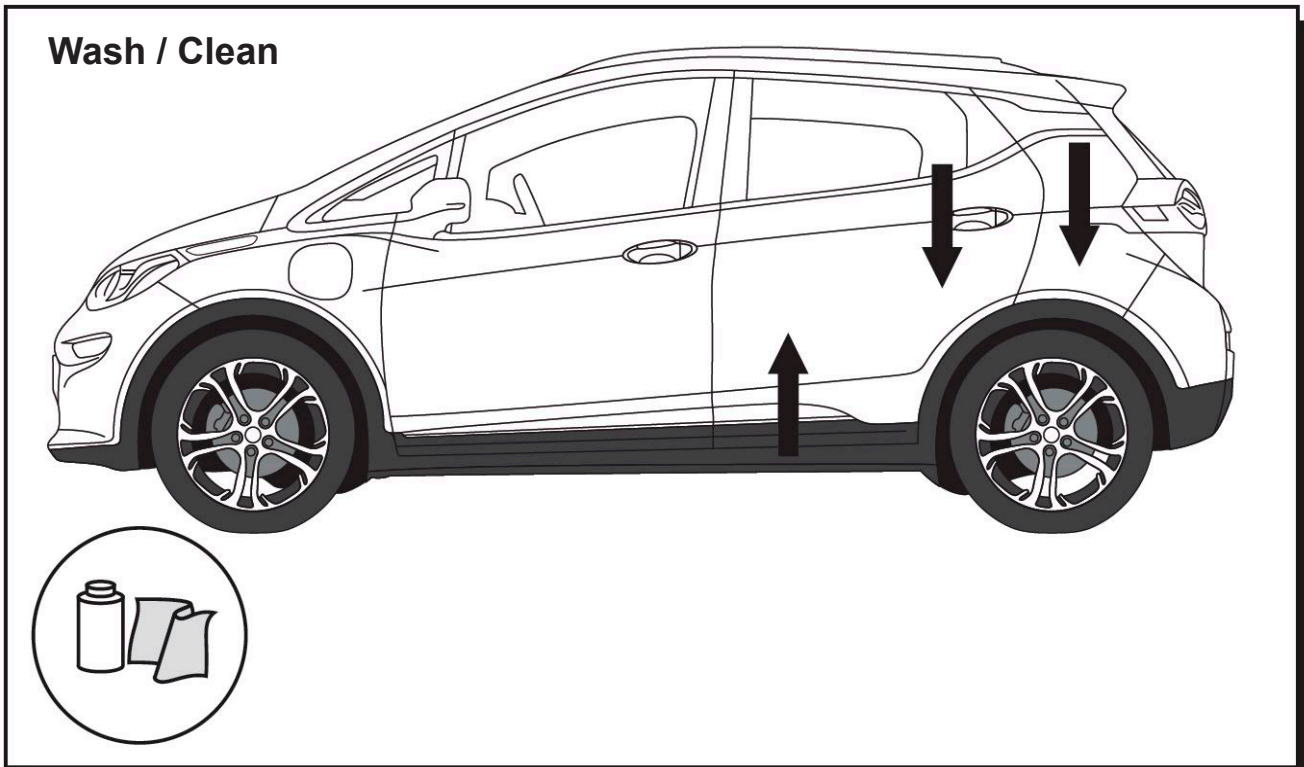

2 Apply Soap / Water Mixture

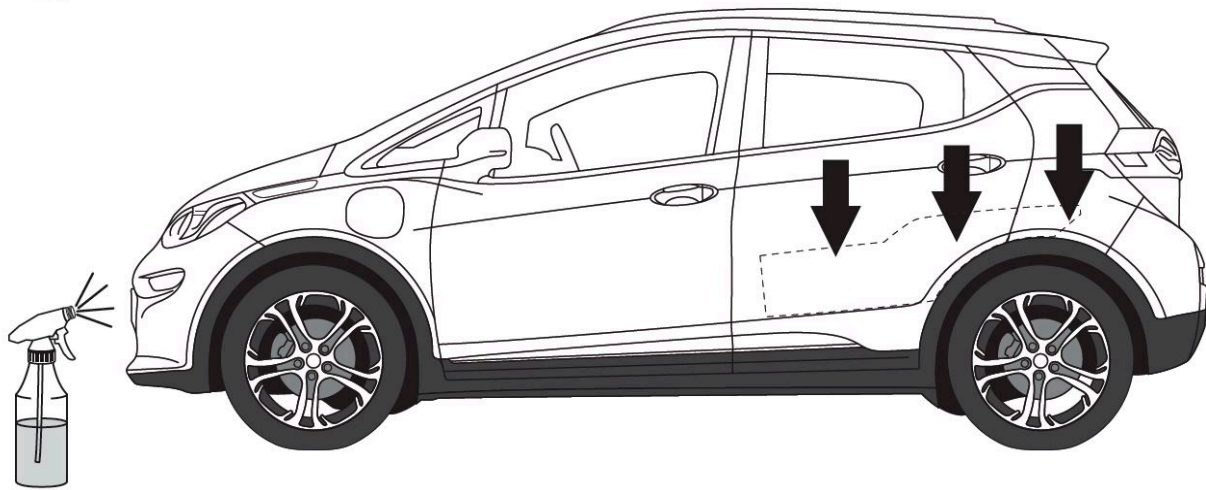

3 Application

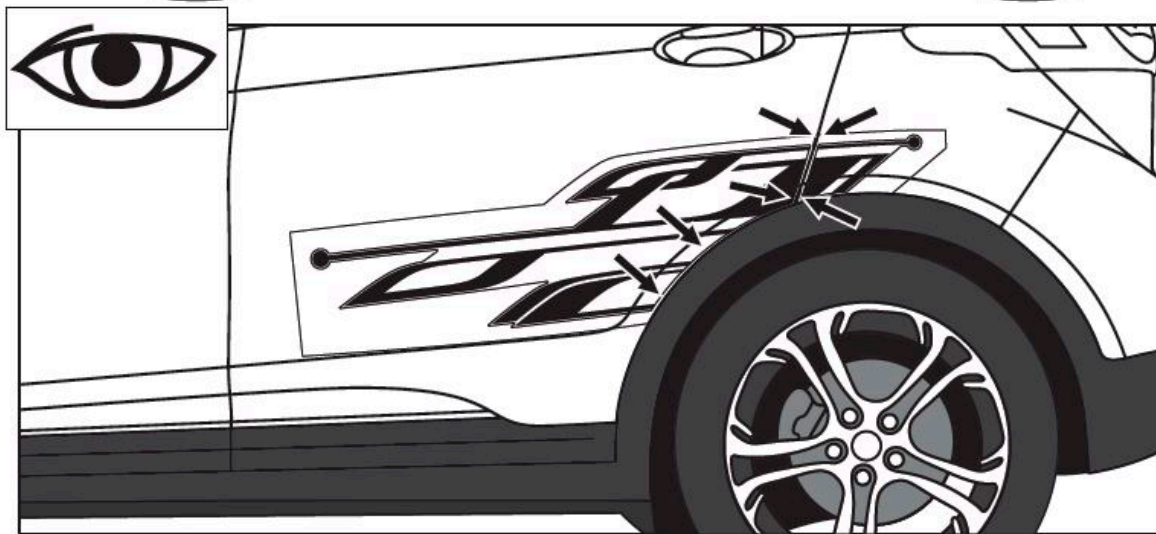
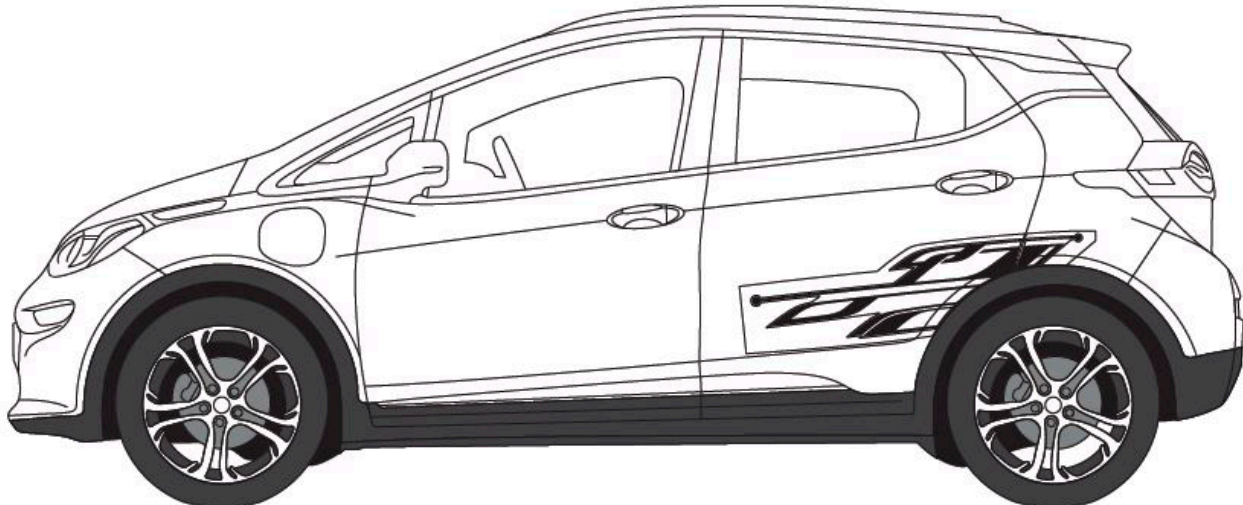

4 Apply Water Mixture (Typical)

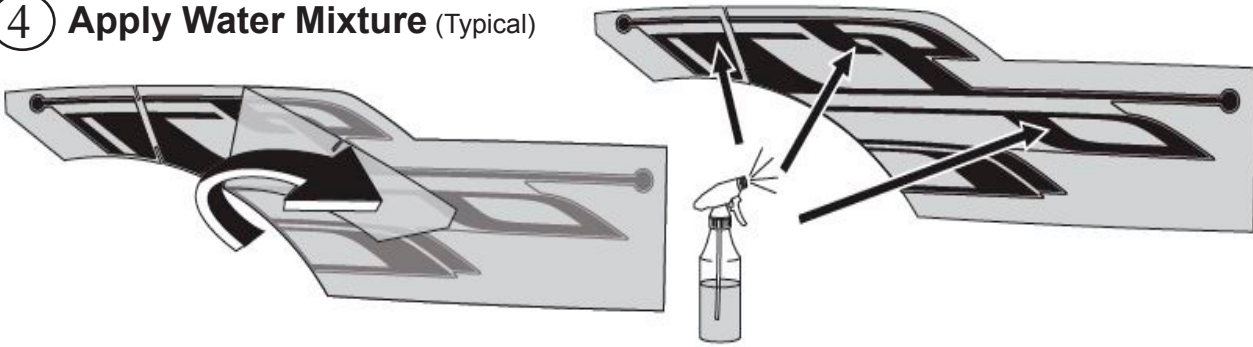

5 Application (Typical)

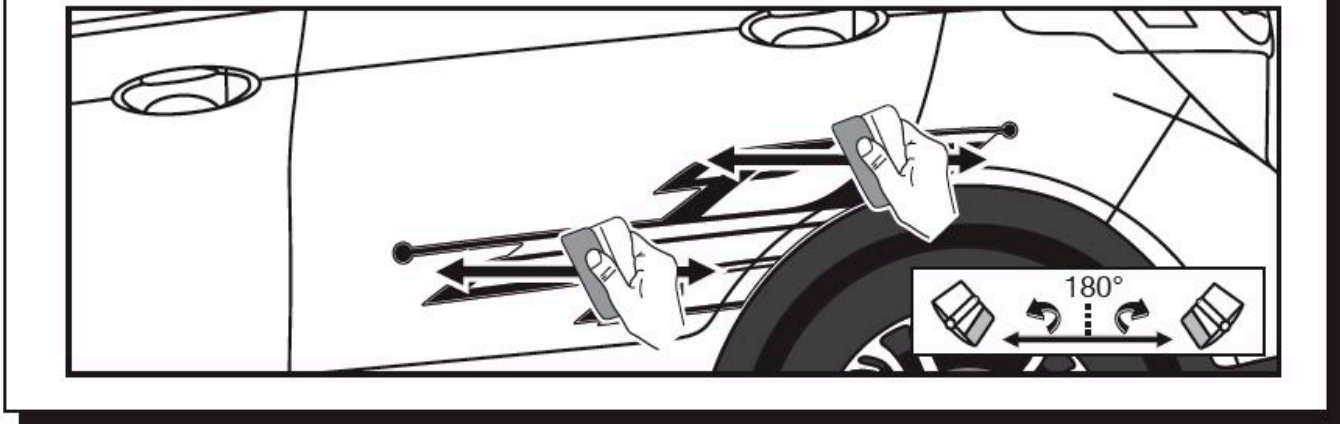
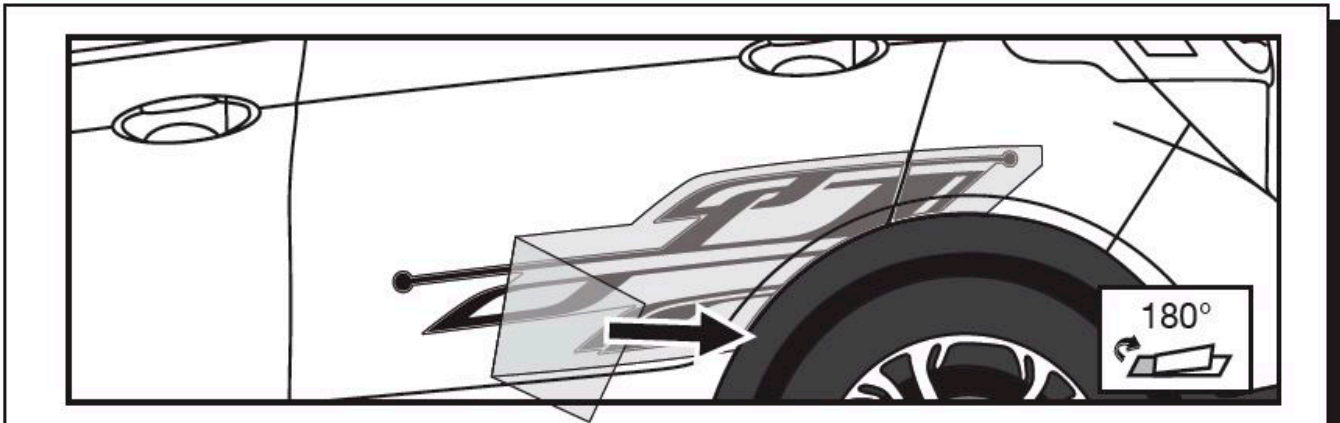
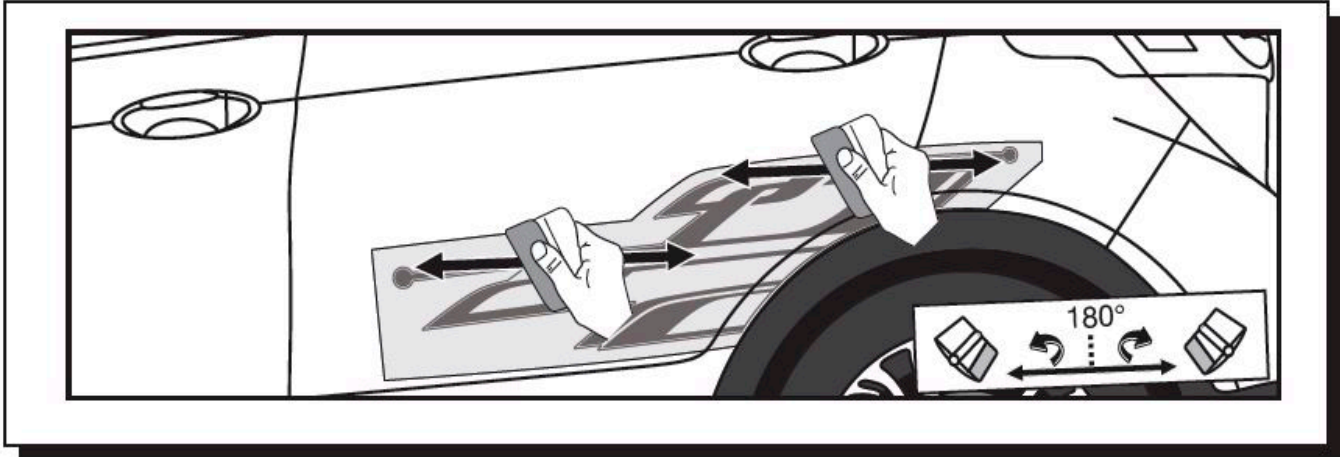

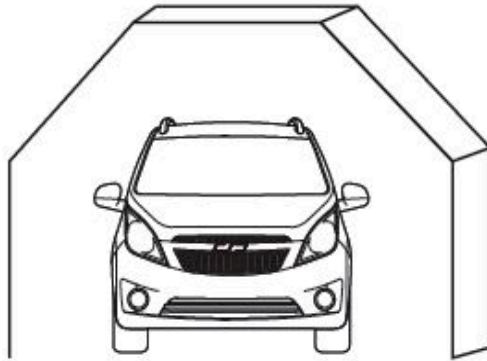
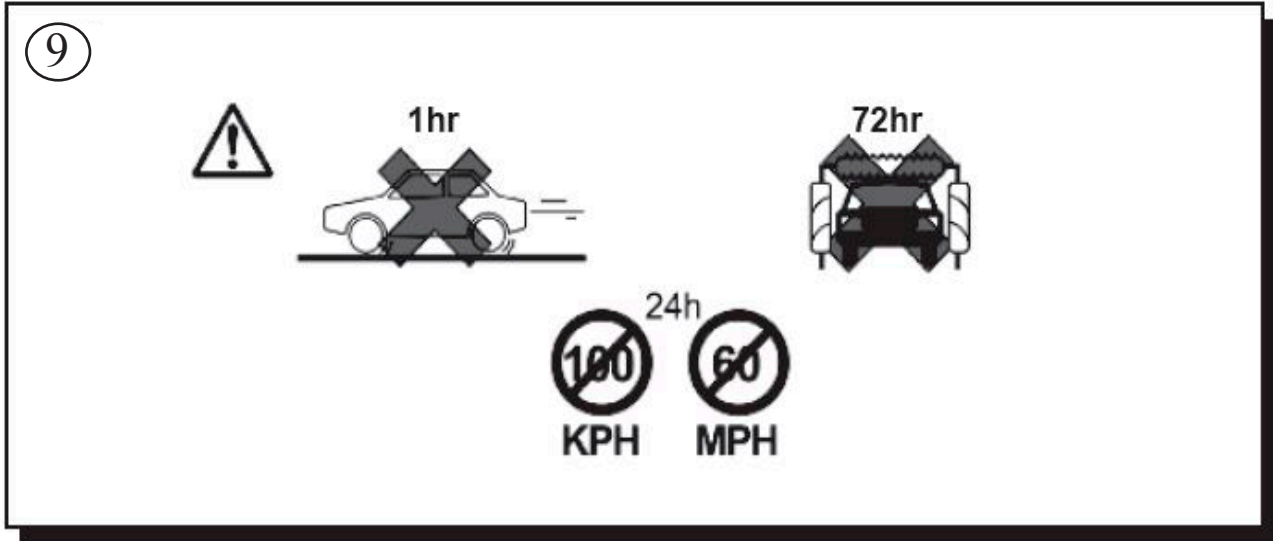

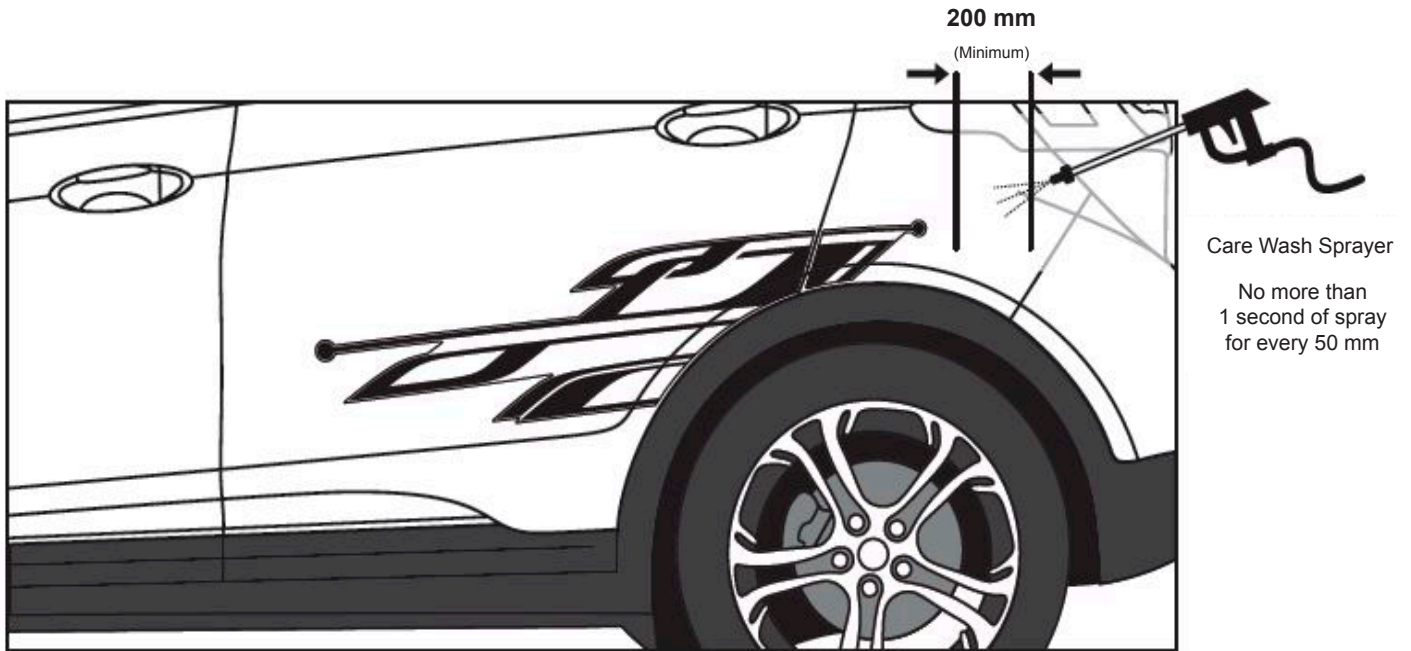

20 Minutes @ 21° C (Minimum)

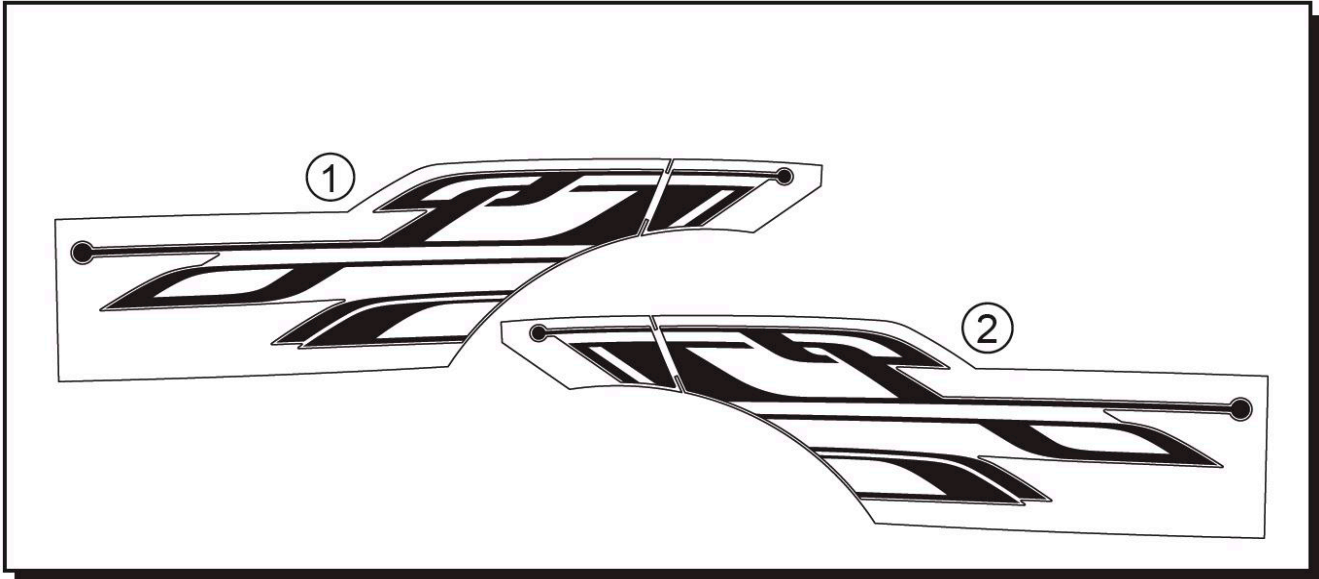









IPA (70%)
Eau (30%)



Liquide
lave-vaisselle
inodore



x 3



Eau
(750 ml)



Raclette

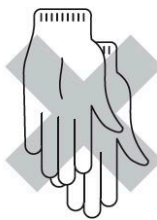



ENTRETIEN



21°C-32°C
70°F-90°F

Lavage/nettoyage



② Appliquer de l'eau savonneuse

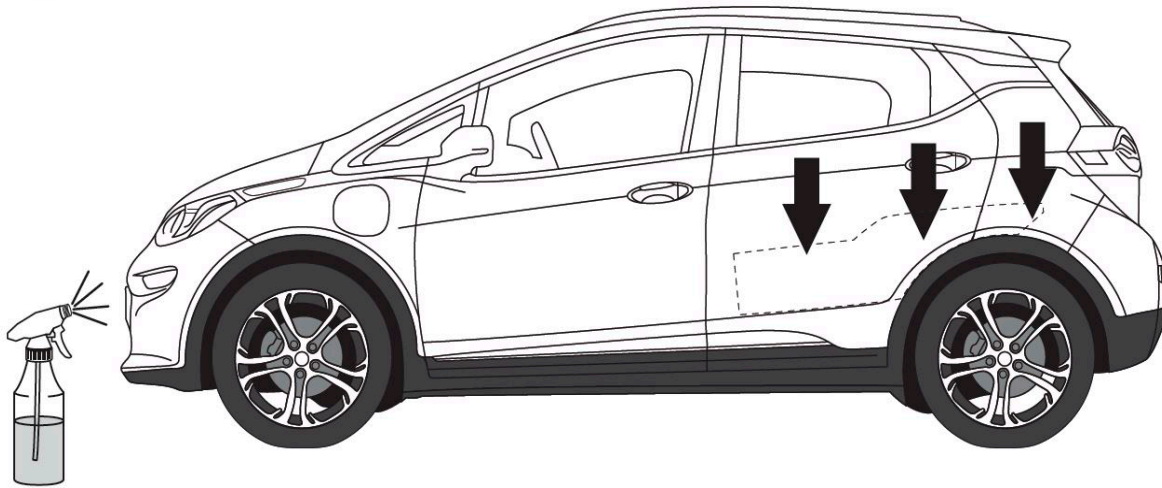

③ Application

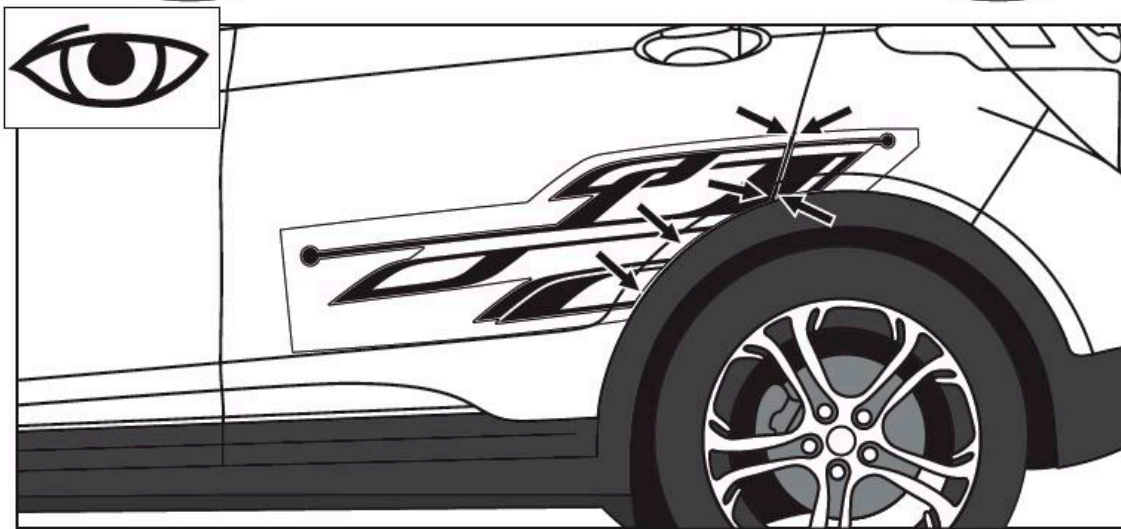
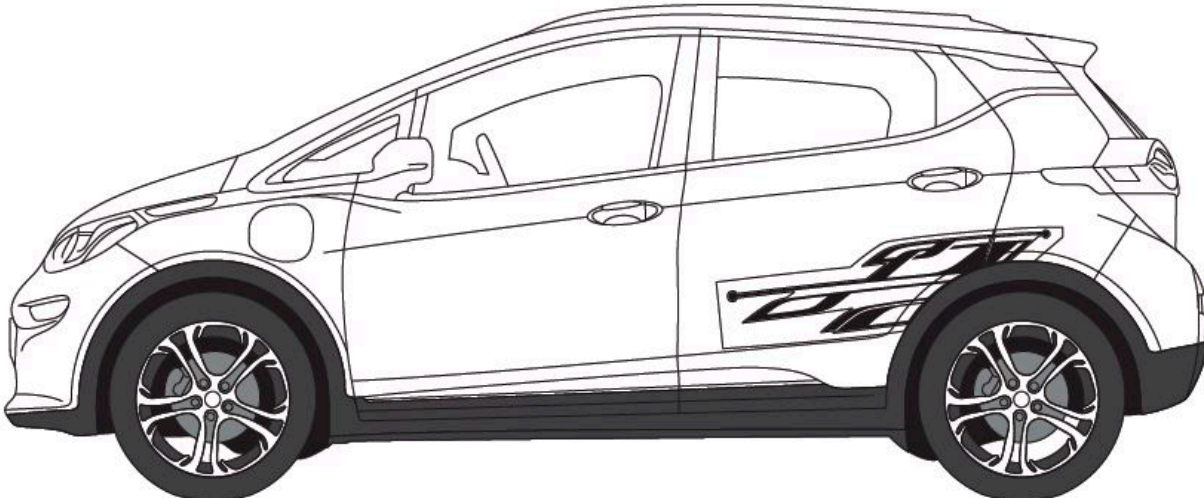

④ Appliquer une solution d'eau (typique)

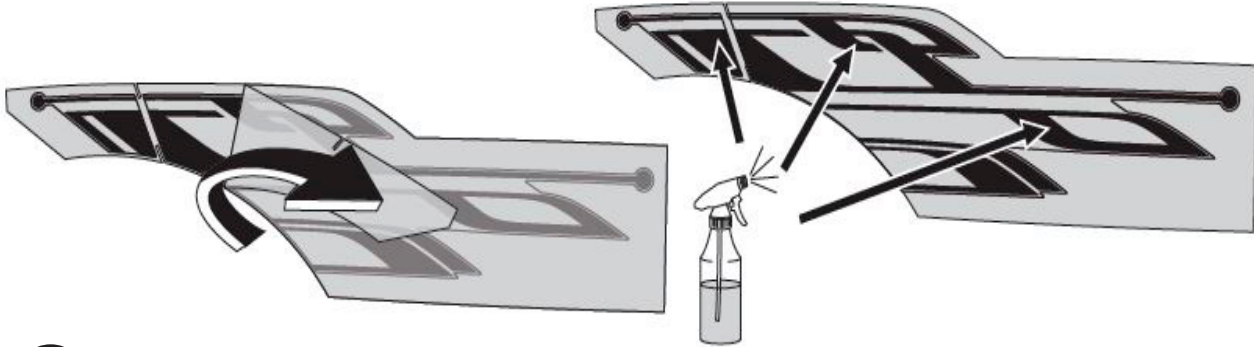

⑤ Application (typique)

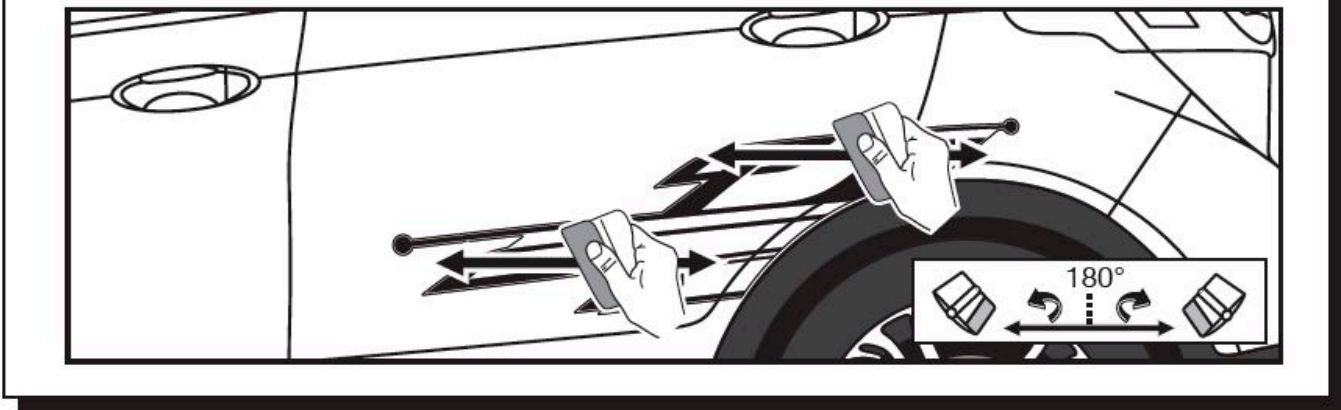
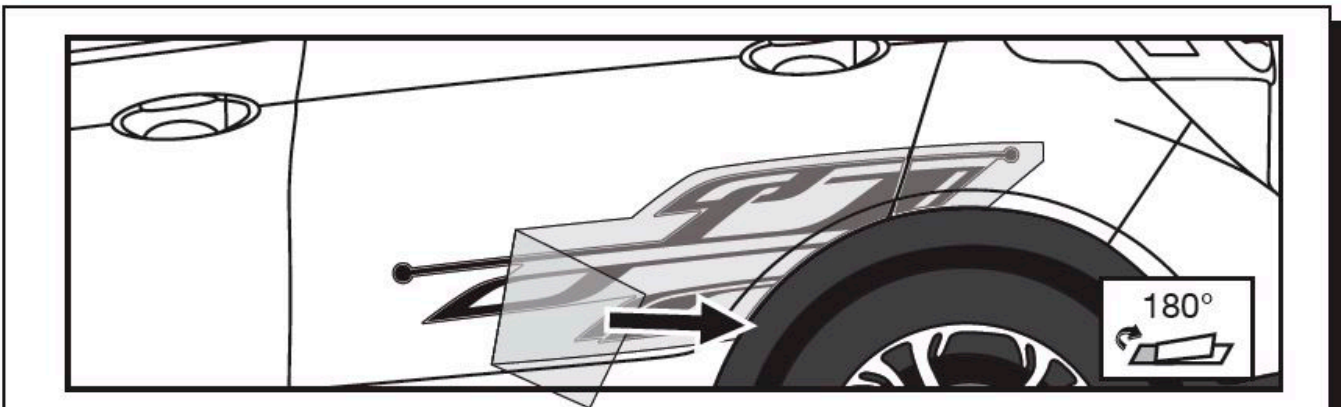
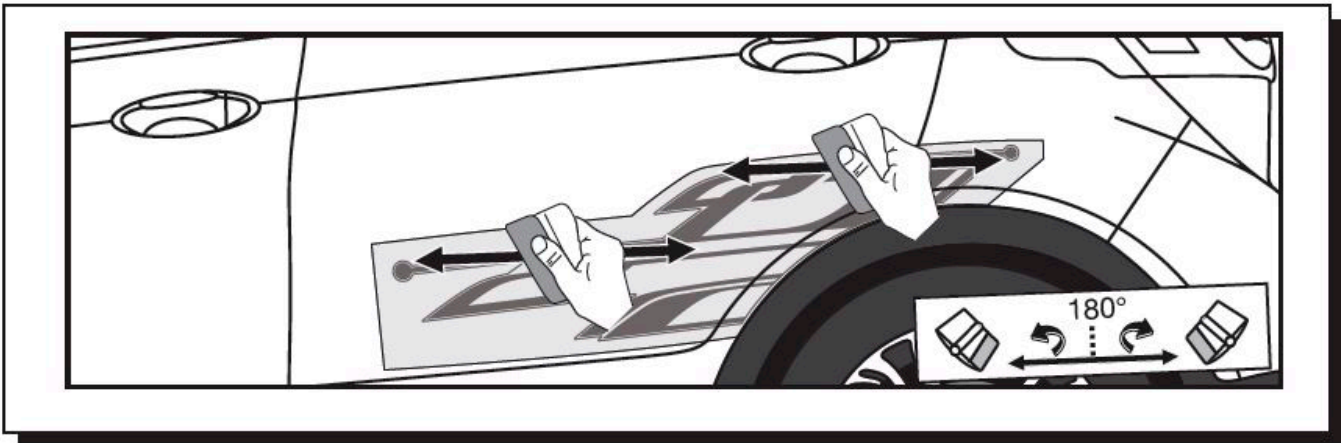

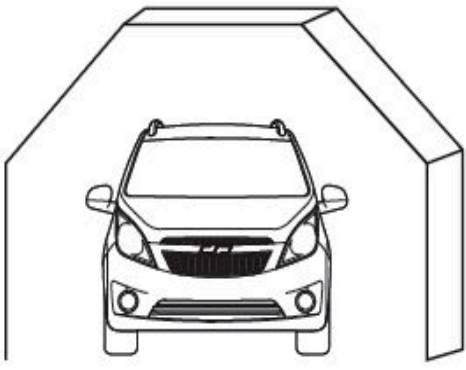
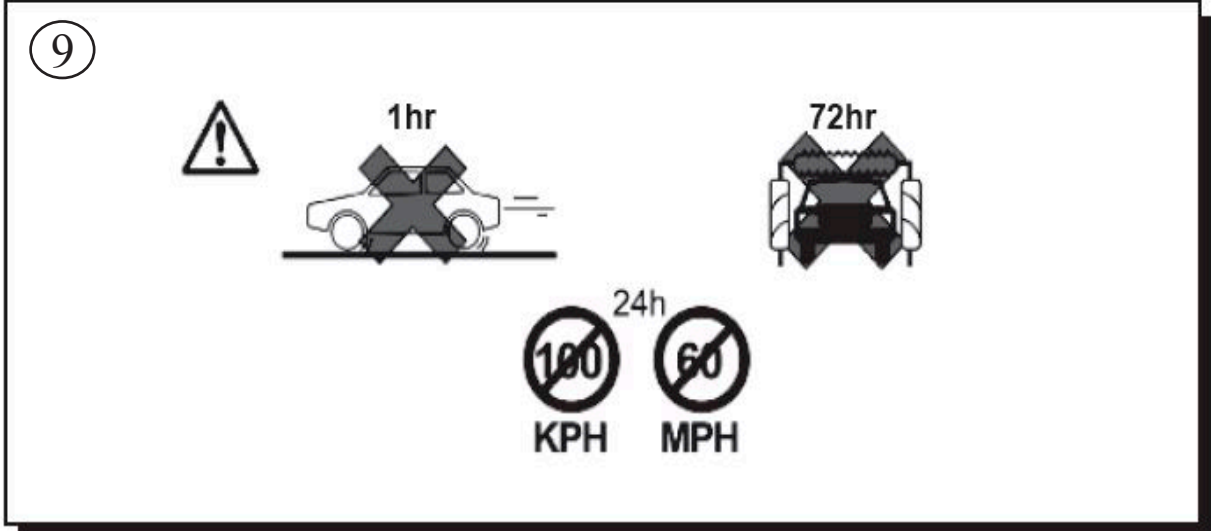

20 minutes à 21 °C (Minimum)

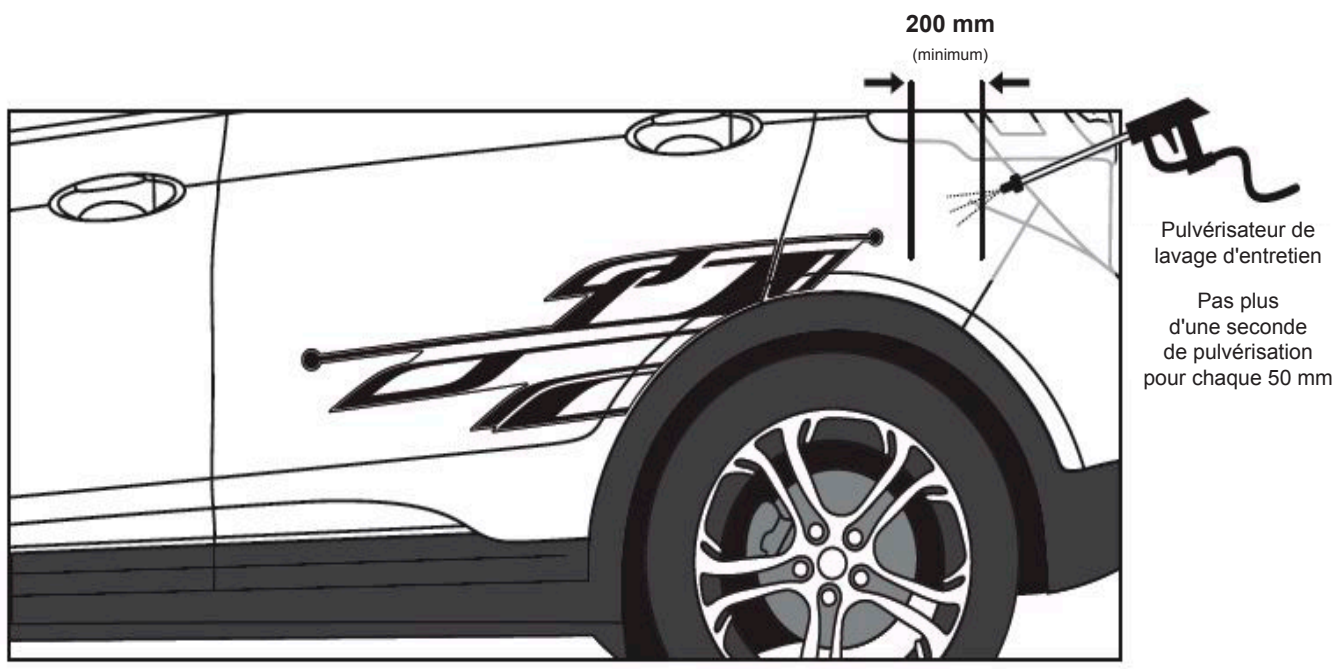

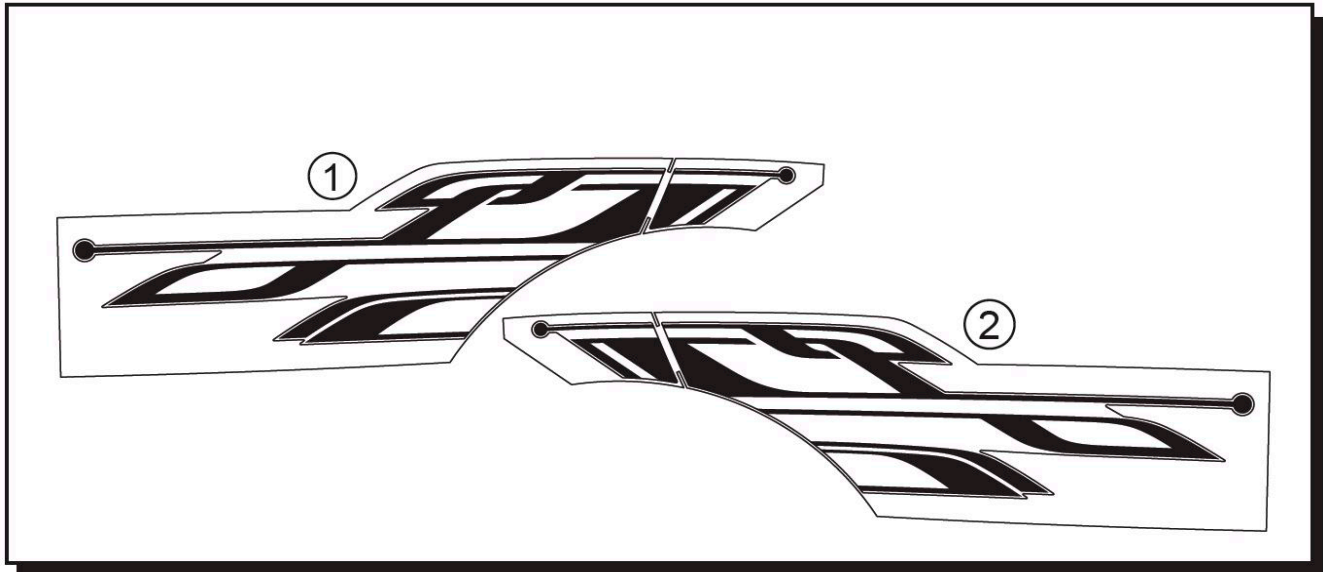

IPA (70%)
Agua (30%)

Líquido lavavajillas sin aroma

X 3
Agua
(750 ml)

Secador

SERVICIO

21°C-32°C
70°F-90°F

Lavar / Limpiar

② Aplicar mezcla de jabón / agua

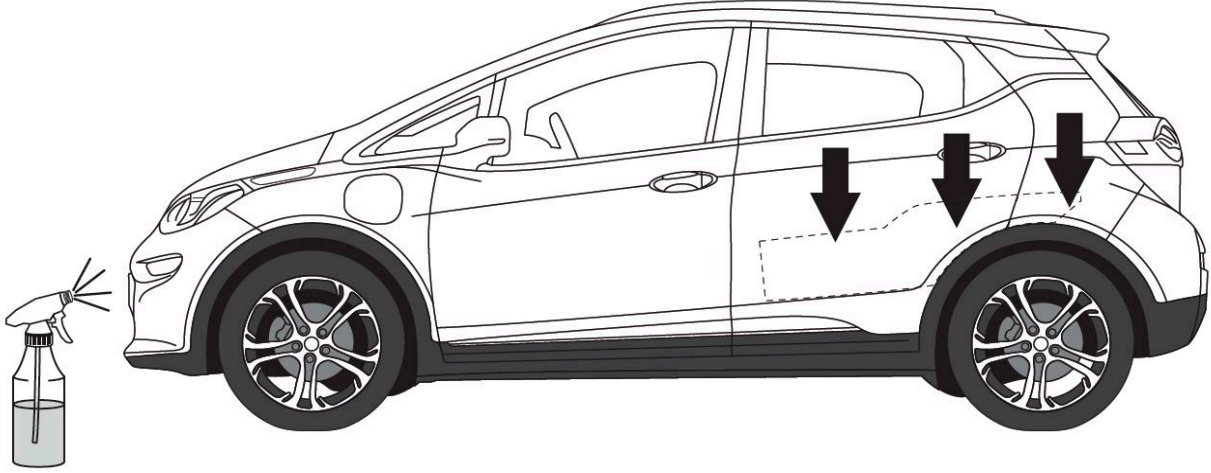

③ Aplicación

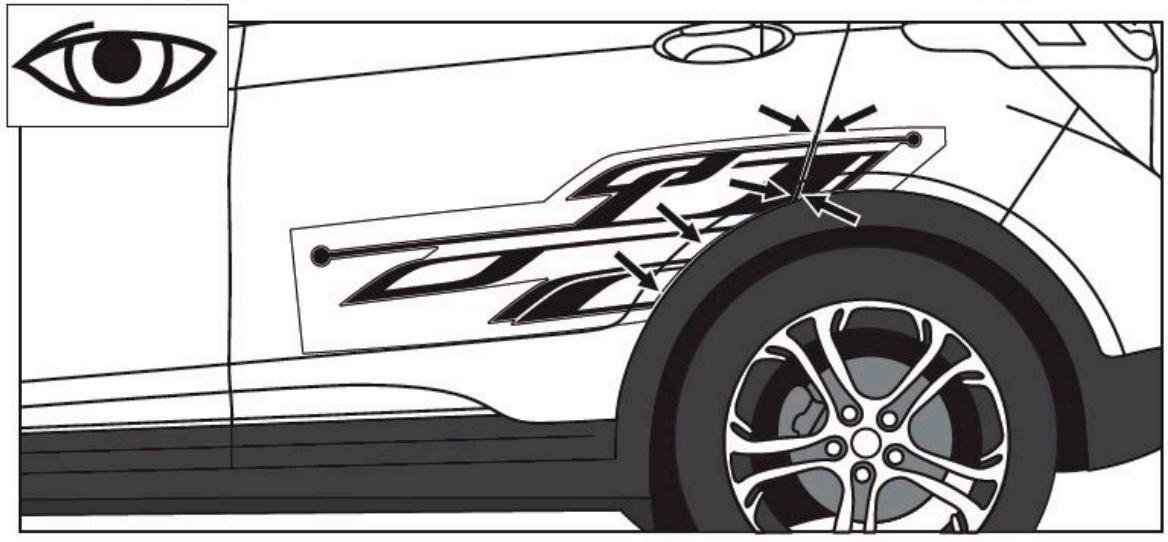
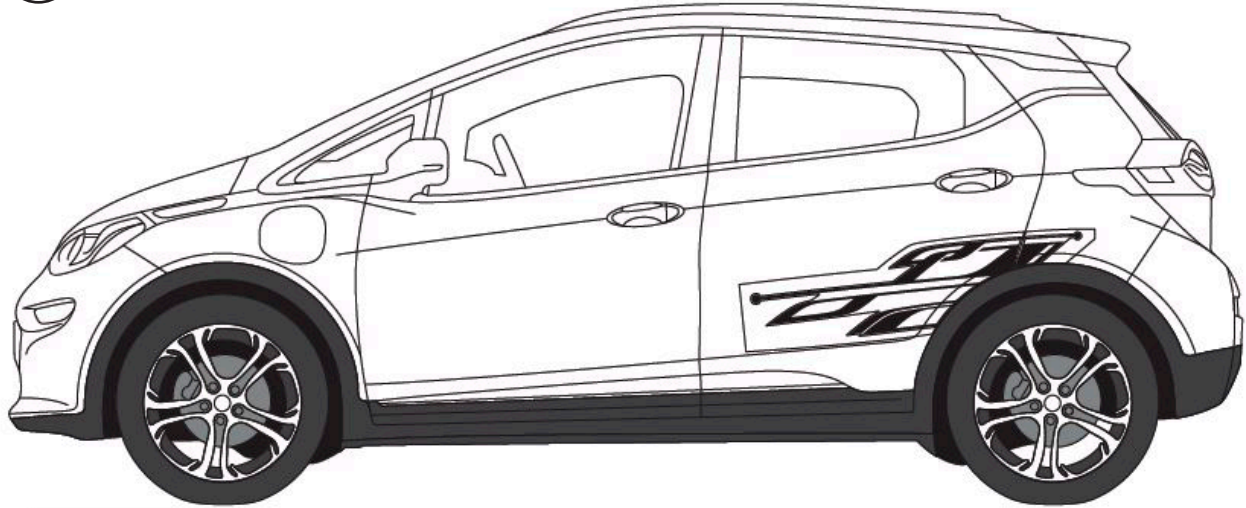

4 Aplicar mezcla de agua (Típico)

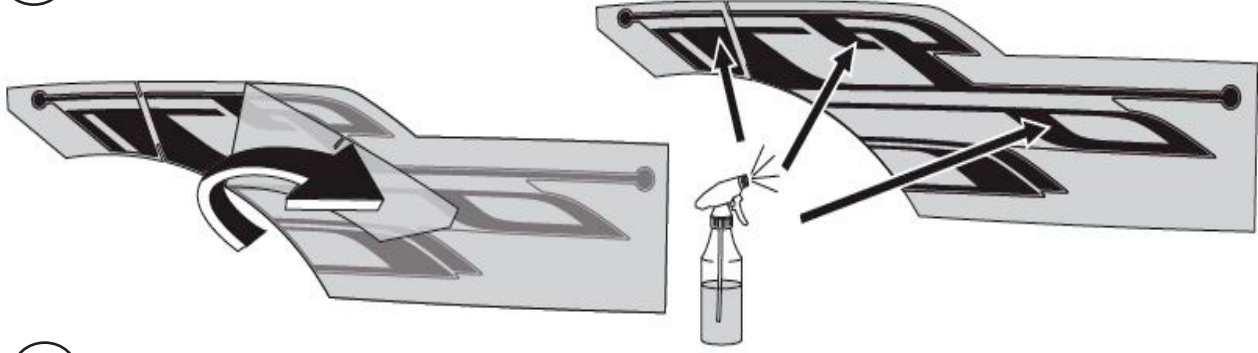

5 Aplicación (Típica)

