



DECKLID LIP SPOILER

P/N: 92278254

CONTENT

Description	Qty
Spoiler ASM (Seals & caps attached)	1
Nut	3
Instructions	1

Tools Required: Knife, Pliers, 2mm, 6mm, 7mm Drill bits, Power drill, small file, Centre punch, masking tape, Tape measure, De-Burring tool and anti-corrosion primer suitable for Aluminium.

IMPORTANT:

If the spoiler is being fitted to a decklid with pre-existing holes (ie. 7 slots in the top surface of the decklid), the spoiler must be fitted in accordance with the installation instruction for OE equipment in the electronic Service Information.

Installation of the spoiler when fitted as an accessory:-

IMPORTANT:

- Observe all warnings and precautions stated in this instruction booklet:
- Thoroughly wash and dry the vehicle before starting the installation.
- Clean vehicle surface where the lip spoiler will be applied with 70% isopropyl alcohol or Prepsol or equivalent and wipe with a dry lint free cloth.
- Remove any wax, grease or tar, which might be present.
- Dry off any surface film with a clean, lint-free cloth before the cleaning solvent evaporates.
- On repainted vehicles, paint must be thoroughly dry and cured before applying the spoiler to the vehicle. Check paint manufacturer's instructions for recommended cure time and method.
- Ambient temperature of the lip spoiler and vehicle must be between 16°C to 32°C at the time of installation and for two hours after.
- The vehicle must be out of direct sunlight to ensure even vehicle body temperature.

Painting Instructions (If Unpainted) -

- Sand the decklid spoiler prior to painting. Recommend 400 - 600 grit sanding paper to activate the adhesive properties of the primer and clean off any contaminants.
- Prior to painting, clean all surfaces to be painted using clean water and a mild detergent, do not use lacquer, thinner or any solvent based products. Wipe completely dry.
- Best results will be achieved by wiping the areas to be painted with a tack rag just prior to painting.

- Ensure the retaining clips are protected by the rubber marker caps to prevent over spray contacting the retaining clips. Refer to figure 1.
- Ensure the areas of the under side of the spoiler where the adhesive tape will be applied are completely covered with paint top coat to ensure maximum adhesion of the adhesive tape.
- Select a top coat and clear paint that is suitable for ABS (Acrylonitrile-Butadiene-Styrene).
- Automotive paint systems, such as acrylics or two packs, can be applied directly to the components. However, some paints may require a primer. If recommendations on paint specification are not followed, cracking of the part or degradation to the material may result. In all paint systems, aromatic hydrocarbons and alkalies are best avoided to reduce damage to the material properties.
- If using a paint system which requires baking, do not expose the product to temperatures above 70°C/155°F.
- Allow a minimum of 8 hours after baking before installation on the vehicle.

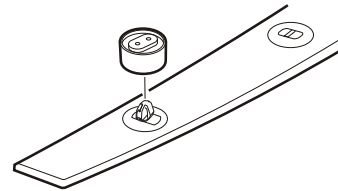

FIGURE 1

Spoiler installation

1. Apply masking tape (1) down the centre of the decklid.
2. Use a tape measure to find and mark the centre of the decklid. Draw a line (1) down the centre of the decklid. Refer to figure 2.

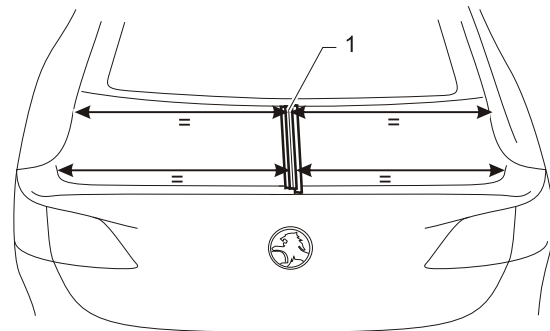

FIGURE 2

3. From the leading edge of the decklid measure 428.4 mm along the centre line drawn on the tape on the decklid and mark the position on the centre line.
4. Use an automatic centre punch to mark the centre fixing hole on the decklid. Once the hole centre is marked remove the masking tape.
5. Use a 2mm pilot drill to drill a pilot hole.
6. Drill out the hole to 6.5mm. Refer to figure 3.

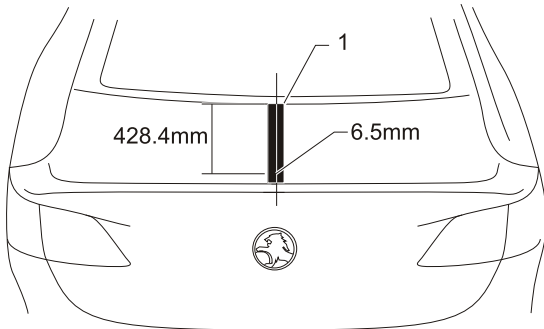

FIGURE 3

7. Retain the two outer clips and all the threaded studs on the underside of the lip spoiler.
8. Remove the two clip heads that are closest to the centre of the lip spoiler by scoring the stem of the clip at the base on both sides and use pliers to break the clip head off. Ensure that the remaining surface is flat or concaved once the top section is removed. Refer to figure 4.

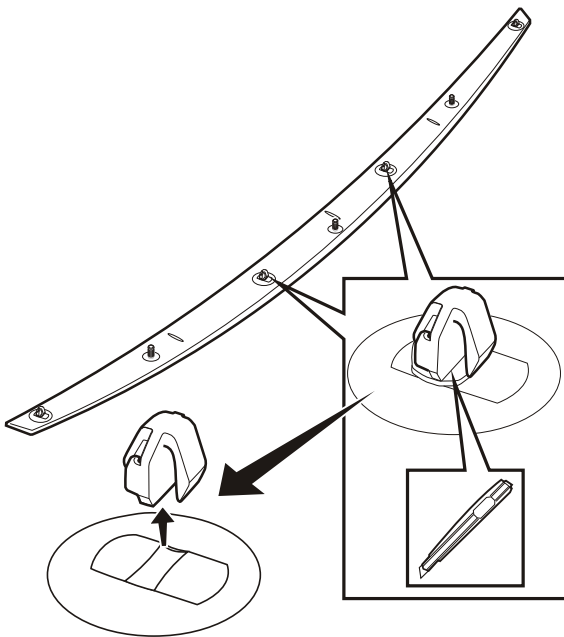

FIGURE 4

9. Apply masking tape on the decklid in the 4 places where the holes for the remaining 4 fasteners will be drilled. Refer to figure 5.

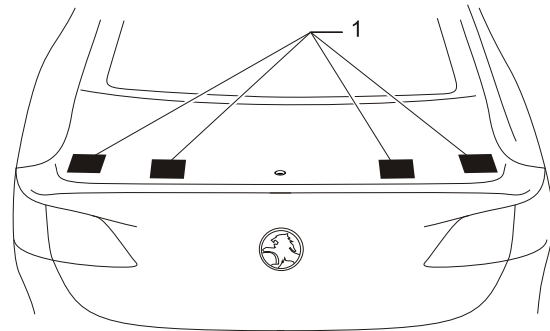

FIGURE 5

10. Use a paint pen (or similar) to apply a thin smear of paint on the tips of the threaded studs either side of the centre stud.
11. Pass the lip spoiler centre stud into the centre hole in the decklid ensuring the ends of the lip spoiler do not contact the decklid.
12. Align the spoiler to the decklid by ensuring both ends of the spoiler are spaced equally from the edges of the decklid.
13. When the spoiler is aligned push the lip spoiler (1) down onto the tape on the decklid at that position. Lift the lip spoiler off the decklid cleanly to prevent the paint marks (2) smudging. refer to figure 6.

NOTE: If the paint marked dots are not clear or the holes are not spaced equally from the edges of the decklid, replace the tape and repeat the process.

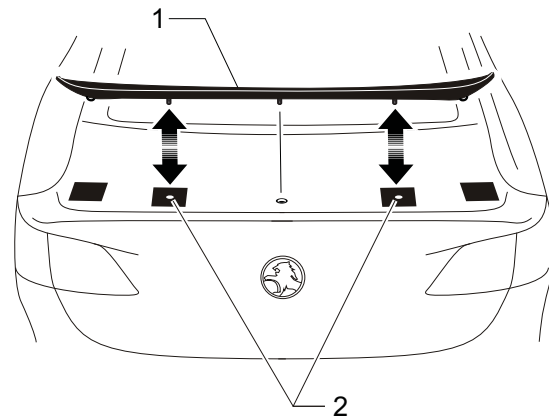

FIGURE 6

14. Use an automatic centre punch to mark the centre of the dots marked in step 13. Once the hole centres are marked remove the masking tape at those locations. Retain the masking tape at the outer locations for use in steps 17 through to 22.
15. Use a 2mm pilot drill to drill a pilot hole at the two centre punched locations.
16. Drill out the two holes to 7mm.

Refer to figure 7 for the following;

17. Fit the rubber marker caps (2) to the two end clips (5) on the lip spoiler (1).
18. Use a paint pen (or similar) to apply a thin smear of paint over the edge (4) and the two dots (3) of the rubber marker caps.
19. Pass the lip spoiler studs through the holes in the decklid ensuring the ends of the lip spoiler do not contact the decklid.
20. Align the spoiler to the decklid by ensuring both ends of the spoiler are spaced equally from the edges of the decklid.
21. When the spoiler is aligned push the ends of the lip spoiler down onto the tape on the decklid at that position. Lift the lip spoiler off the decklid cleanly to prevent the paint marks smudging.

NOTE: If the dots in the centre of the rubber cap is not clear or the outside shape of the rubber cap is not clear or the holes are not spaced equally from the edges of the decklid, replace the tape and repeat the process.

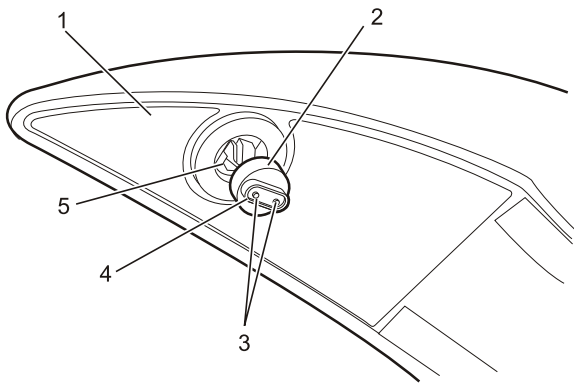

FIGURE 7

22. Use an automatic centre punch to mark the centre of the dots made by the rubber caps on the decklid. Once the hole centres are marked remove the masking tape.
 23. Use a 2mm pilot drill to drill a pilot hole.
 24. Drill out the holes to 6mm.
 25. Use a suitable tool to remove the material (1) between the two holes to make one elongated hole 13x6.5 mm.
- IMPORTANT:** *Ensure the decklid surface remains flat when making the holes in the decklid. If the decklid surface is deformed the retention clips will not engage.*
26. De-burr all holes and use an anti-corrosion stand-alone primer (no topcoat required) suitable for Aluminium substrates, for e.g. primer Galmet Keytite Alum Primer or equivalent. Refer to figure 8.

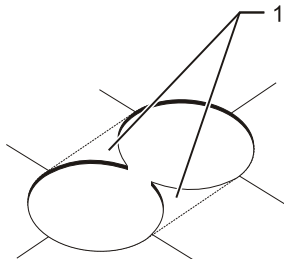

FIGURE 8

27. Once the spoiler has been painted the appropriate colour and allowed to dry and harden, clean the bottom surface of the spoiler before applying the adhesive tape /foam seals following the cleaning instructions at the beginning of these instructions.
28. Apply the correct circular adhesive foam seals around the different fasteners. Refer Figure 9.

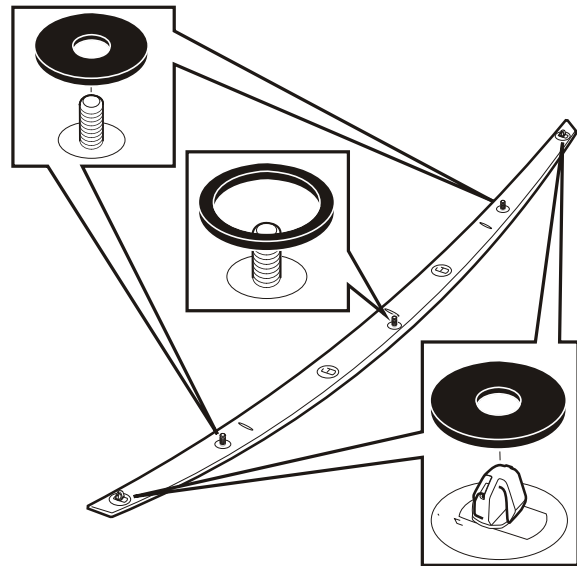

FIGURE 9

29. Apply the 2 adhesive tape strips (1) along the front and rear edge of the spoiler. Apply the tape patches (2) to ends of the spoiler. Apply pressure on all tape strips/patches to ensure permanent adhesion to spoiler. Avoid obstructing spoiler vent holes (3). Refer to figure 10.

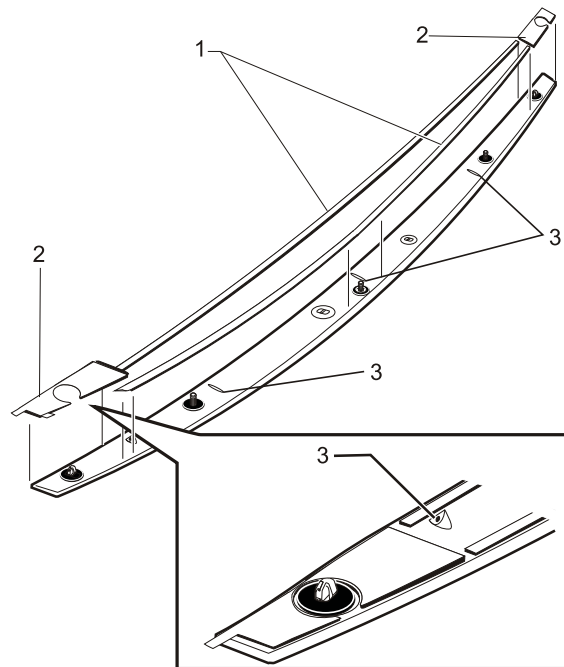

FIGURE 10

30. Trial fit the lip spoiler to the decklid and confirm that the lip spoiler fixings align with the holes correctly.
31. Pull the tabs (1) on the adhesive backing tape across to the rear edge of the spoiler. Refer to figure 11.

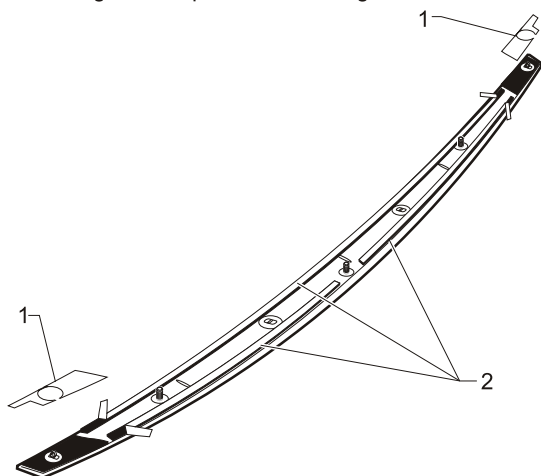

FIGURE 11

32. Once pull tabs have been started position the spoiler on the decklid, ensure there is an equal distance from each side of the decklid.
33. Clip the spoiler into the elongated holes and carefully pull on the tabs of the backing tape at 45° to remove.
34. Once all the backing tape has been removed, apply firm pressure along the length of the spoiler for several seconds to ensure permanent adhesion. Refer to figure 12.

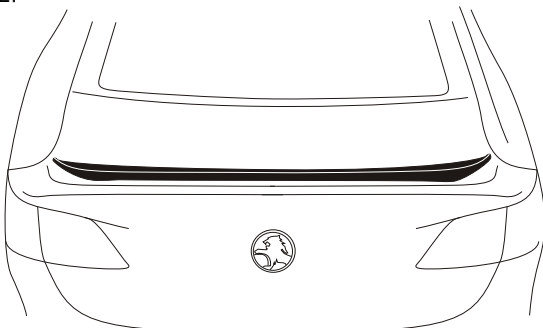

FIGURE 12

35. Remove the decklid carpet trim (1) by removing the 10 fir tree clips (2), removing the assist handle (3) and the spare wheel cover hook (4). Refer to figure 13.

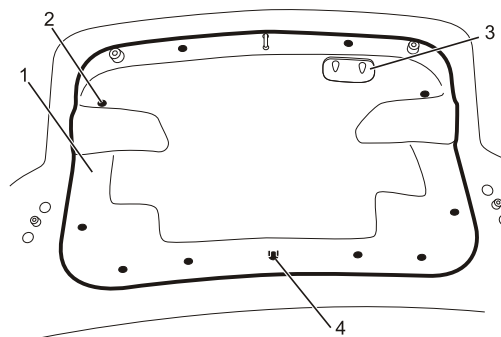

FIGURE 13

36. From inside the decklid fit the nuts (1) supplied to the decklid lip spoiler studs (2). Tighten to 6Nm of torque. Refer to figure 14.

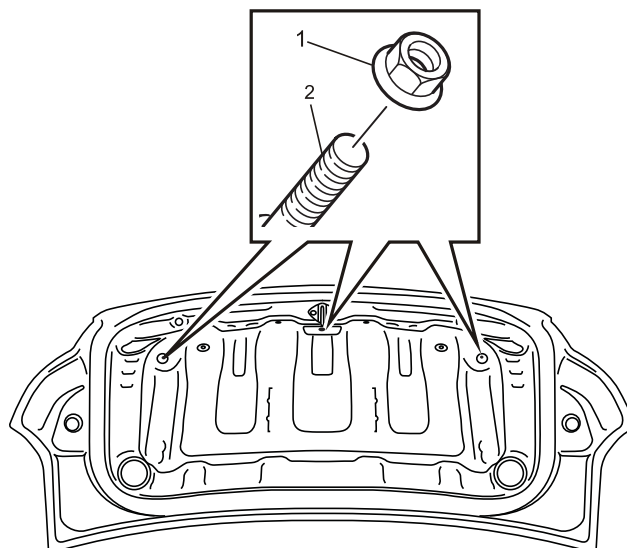

FIGURE 14

37. Remove the gas struts on the car one side at a time. Use a small screwdriver to release the gas strut retaining springs (1) and remove the gas strut (2). Fit the appropriate rated gas strut for the spoiler. Clip the replacement gas strut to the decklid hinge, ensure the gas strut has the telescopic end facing down.
38. Remove and replace the decklid hinge springs (3) with the appropriate rated springs. Refer to figure 15.

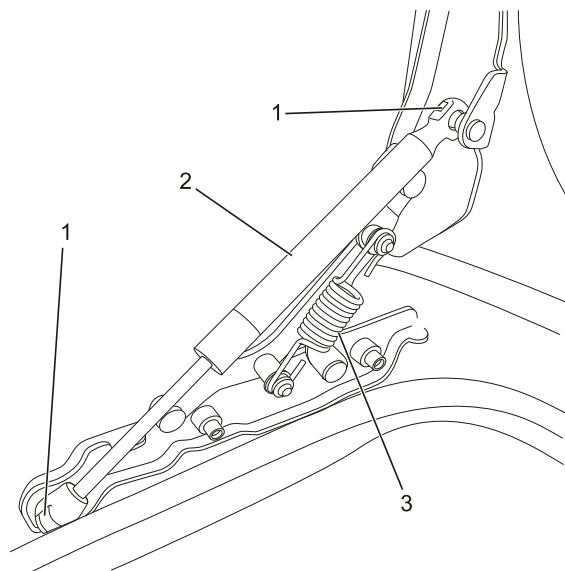

FIGURE 15

39. Ensure any swarf is removed from the vehicle.
40. Refit all parts removed.