

Luggage Carrier Attachment Package Installation

Luggage Carrier Attachment Package Installation

PARTS LIST		
PART NUMBER	DESCRIPTION	QUANTITY
92174445	ROOF BAR KIT (SEDAN)	1
	ROOF BAR – FRONT	1
	ROOF BAR – REAR	1
	KEYS	2
92225255	FITTING INSTRUCTIONS	1
PART NUMBER	DESCRIPTION	QUANTITY
92235722	ROOF RACK & DITCH MOULDING KIT (UTILITY)	1
	ROOF BAR	1
	DITCH MOULDING	2
92225255	FITTING INSTRUCTION	1
MANDATORY FIT FOR LWB, AVAILABLE SEPARATELY:		
92196502	LWB DITCH MOULDING KIT	
PART NUMBER	DESCRIPTION	QUANTITY
92207466	ROOF BAR KIT (WAGON)	1
	ROOF BAR – FRONT	1
	ROOF BAR – REAR	1
	KEYS	2
92225255	FITTING INSTRUCTIONS	1
RELATED ACCESSORIES AVAILABLE SEPARATELY:		
BIKE CARRIER		

PARTS LIST
SKI CARRIER (SCISSOR TYPE)
SKI CARRIER (UNIVERSAL TYPE)
ROOF TRAY

TOOLS REQUIRED:

- Small Flat Bladed Screwdriver
- Caulking Gun and Sealant

Important:

- The roof bars must not be fitted to a vehicle when the ditch moulding has been removed.
- If you experience difficulty when installations of the roof bars, consult your GM Holden Dealer.
 - It is important to correctly follow the instructions for fitting and use.
 - Periodically check that the roof bars are securely attached to the vehicle.
 - Do not exceed the maximum permitted roof load and the maximum load of the roof bars (75 kg INCLUDING ROOF BARS).
 - Evenly distribute the load on the roof bars.
 - Keep the load and its center of gravity as low as practicable.
 - Heavy loads should be carried near the feet of the roof bars.
 - Be aware of the statutory requirements regarding maximum permissible projections from the vehicle.
 - Loads must be secured correctly and safely.
 - Equipment must be maintained in good working order.
 - Use straps or ropes to secure the load. Do not use elastic cords. Periodically check the tension of the bindings.
 - Stack wide items to minimize the lifting effect.
 - Secure long loads at the front and rear of the vehicle.
 - Where specialized carrying accessories are available it is recommended they be used.
 - The behavior and response of the vehicle will be influenced when roof bars are fitted and a load is being carried. Adjust driving to suit the load carried and the current driving conditions.
 - Remove the roof bars when putting vehicle through automatic car wash.
 - To reduce fuel consumption, it is recommended that the roof bars be removed after use.

[FITTING INSTRUCTIONS:](#)

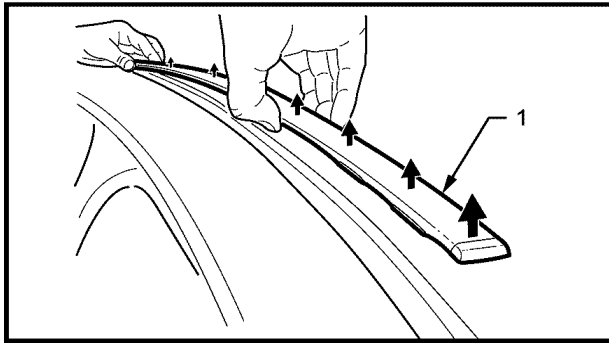

FIGURE 1



1. Remove the ditch mould (1) from the vehicle by lifting from the front of the vehicle and working back releasing the ditch moulding clips as you go. When all clips are released, remove the ditch moulding.

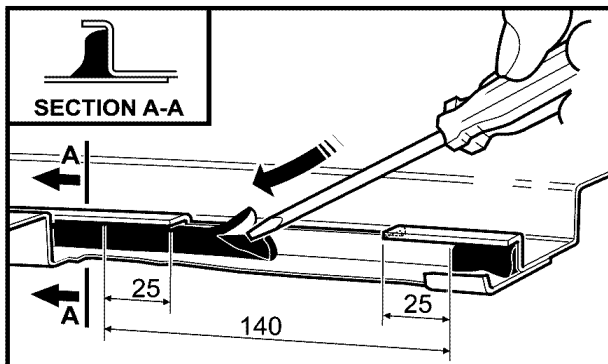

FIGURE 2



2. Inspect the area where the roof bars are fitted. If there is excessive body sealant (refer to section AA of figure 2), remove the ditch mouldings and use a screw driver to remove the sealant from the area as shown. Repeat for all four roof bar mounting points.

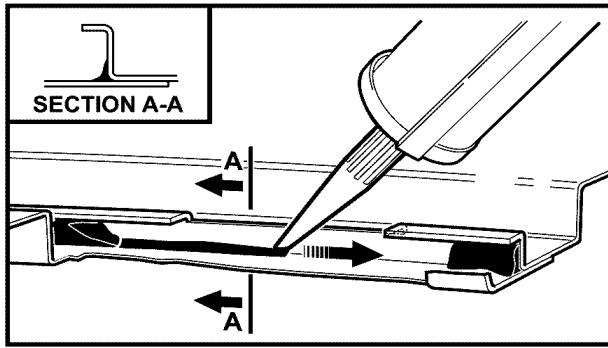

FIGURE 3



3. When the excess sealant has been removed apply Terolan-light (Henkel Product) or Polyurethane Beta Seal (Dow Chemical Product) to exposed joint as indicated. Allow the sealant.

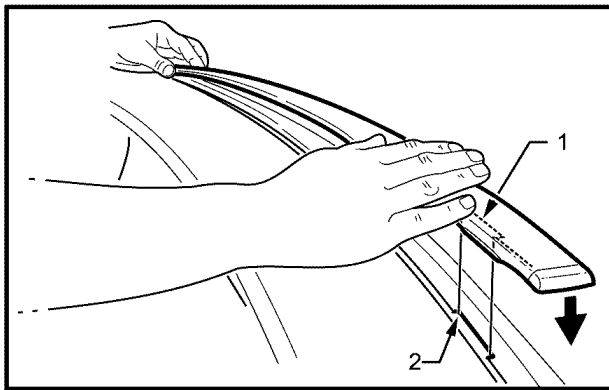

FIGURE 4



4. Refer to Figure 4 for the following:
 - 4.1. Once the rework is complete refit the ditch moulding.
 - 4.2. Position the notch (1) on the front end of the ditch moulding with the gap (2) in the seam of the roof joint. Push down on the front of the ditch moulding and along the length of the ditch moulding.

Note: (LWB Vehicles only:) fit the replacement ditch moulding to the vehicle.

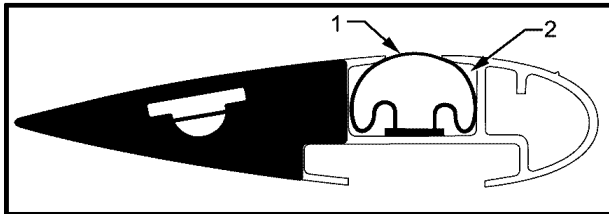

FIGURE 1



IMPORTANT: To prevent wind noise, ensure the wind sealing strip (1) is installed. When installing accessories press the wind sealing strip down and slide the fixing into the channel (2) over the top of the wind seal strip.

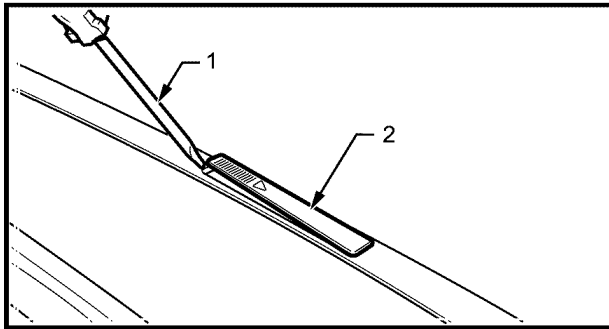

FIGURE 2



5. Use a small flat bladed screwdriver (1) to lever up the roof bar mounting point covers (2), remove all four covers.

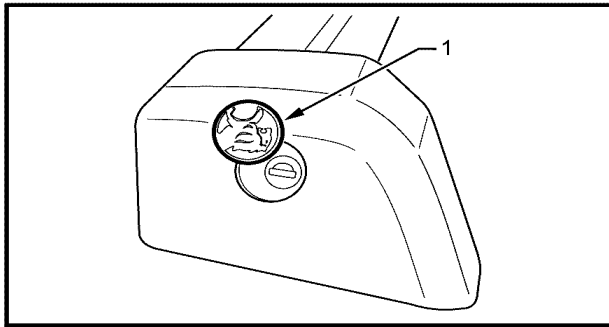
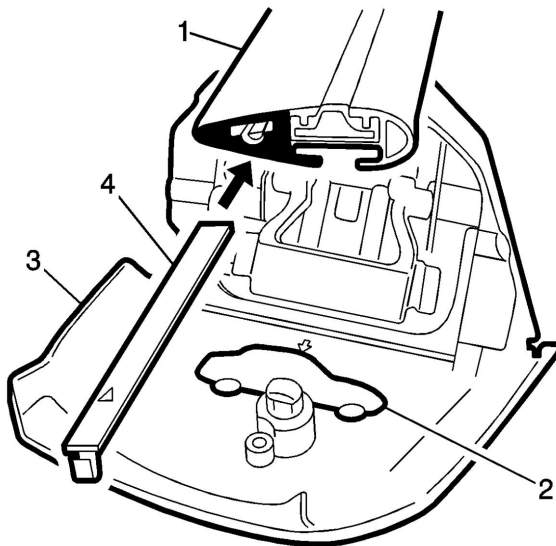

FIGURE 3



6. Rotate the Holden logo key cover (1) to expose the key barrel.



7. Setting up the roof bars for fitting to the vehicle:
- 7.1. Use the roof bar key to unlock the end cover (3). Open the cover, return the key to the locked position so that the key can be removed and lower the cover down flat.
 - 7.2. Slide the roof mount cover (4) into the end of the roof bar (1).
8. Refer to the diagram (2) on the inside face of the roof bar cover, fit the roof bar at the location indicated by the diagram, ensure the front of the vehicle in the diagram is facing the front of your vehicle when the roof bar is installed.

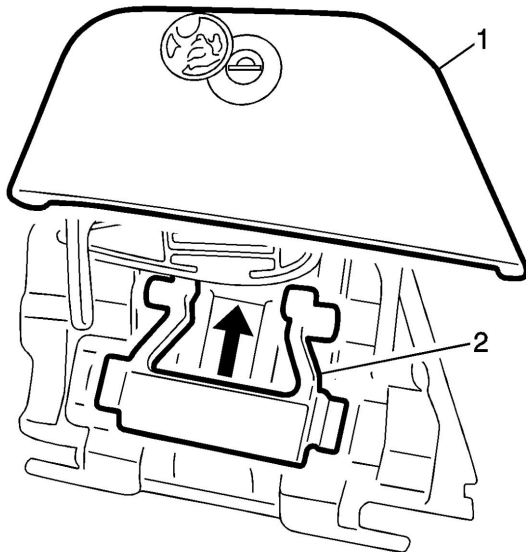

9. Raise the end cover (1) up over the top of the roof bar.
10. Fully raise the RED lockout lever (2).

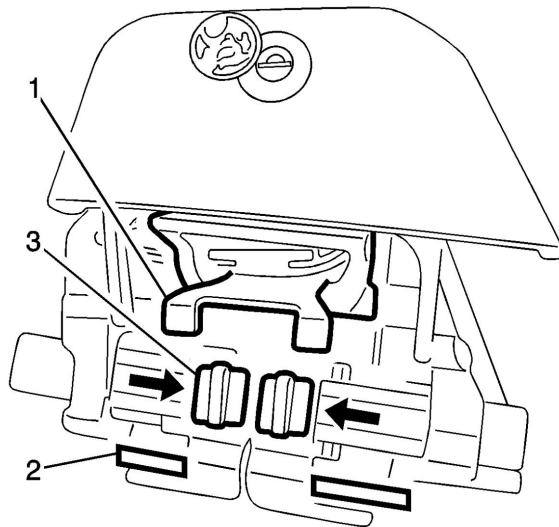

Important: For short wheel base (SWB) vehicles with a factory fitted sunroof, the rubber pad (2) on the foot of the REAR roof bar only must be removed to allow the locking mechanism to operate.

11. Raise the metal lockout lever (1).
12. Sliding the thumb grips (3) together will put the roof bar locking pins in the unlocked position ready for fitting to the vehicle.
13. Repeat on all roof bar ends fixings.
14. Insert one end of each of the bars into the mounting point, apply sufficient pressure to the other end of the bar to seat the bar.

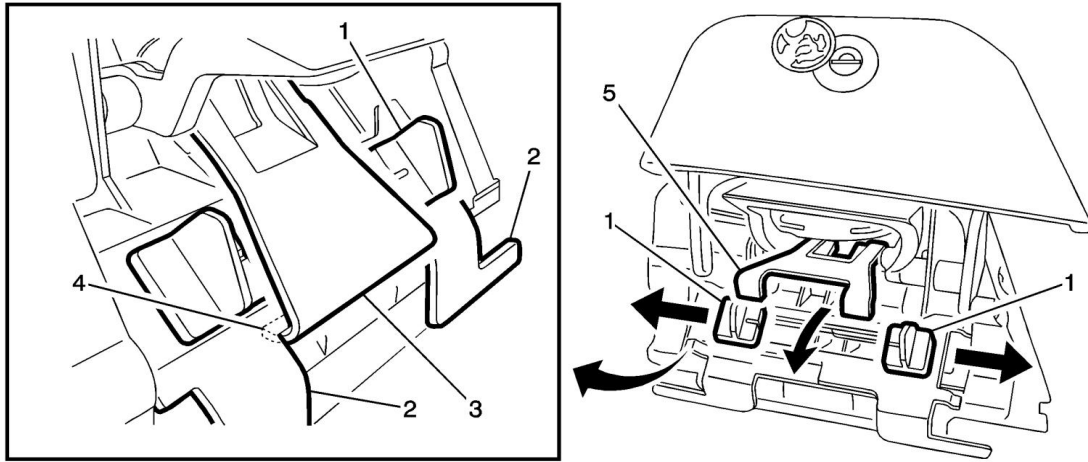

Note: If difficulties are encountered during this step, see your GM Holden Dealer.

15. To lock the roof bars onto the vehicle, slide both the locking pin plate thumb grips (1) out to their full extension. Lower the lockout plate (5) down and under the locking pin plates (2). The claw (4) of the lockout plate must be tucked under both locking pin plates (2)

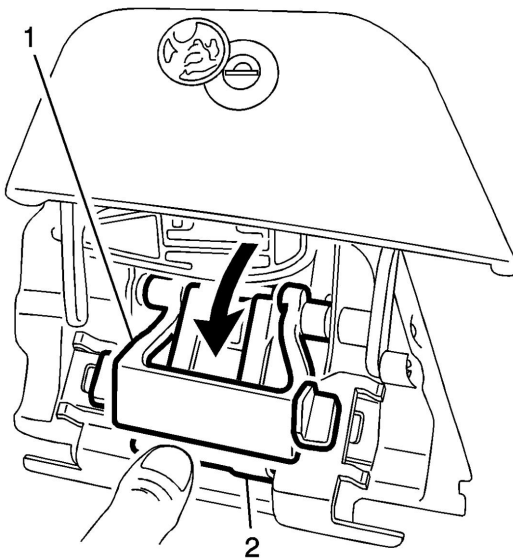

16. Hold the claw of the locking plate (2) in position under the locking pin plates and rotate the lockout lever (1) down to lock the roof bar to the vehicle.

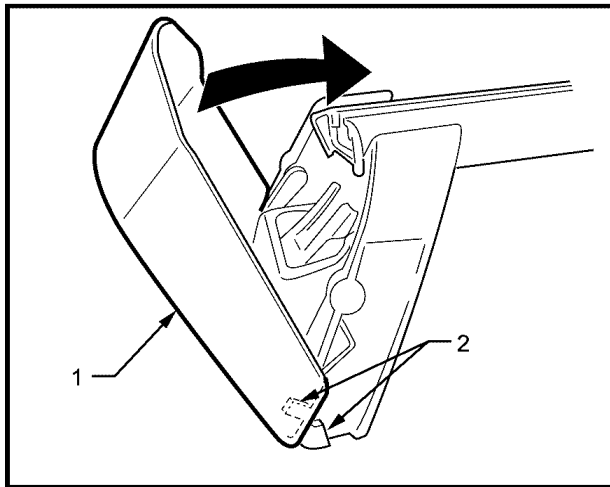

FIGURE 6



17. To close the end covers:

17.1. Insert the key and turn the lock to the open position.

17.2. Place the bottom of the end cover (1) against the roof bar mount to engage the lower locating pins (2), rotate the top of the cover to the closed position.

17.3. Rotate the key to the locked position and remove the key. Rotate the Holden logo to cover the key barrel.

NOTE: If difficulties are experienced in locking the cover into position return to step 11 to ensure the bar is secured to the vehicle properly.

17.4. Repeat on all roof bar ends fixings.

17.5. To check final installation, hold the roof bar near each leg then apply pressure in fore and aft directions to ensure no movement is present in the roof bar. If movement is present contact your dealer.

18. To remove the roof bar repeat the instructions in reverse order.

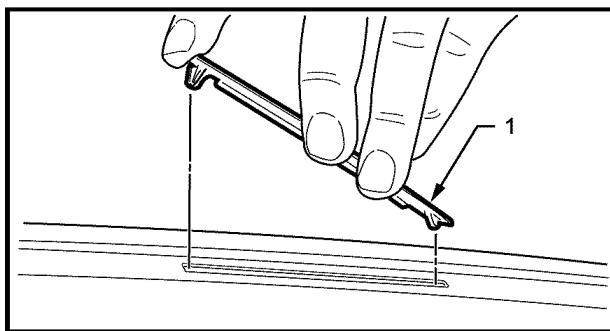

FIGURE 7



19. Fit the roof mount covers (1) with the arrow on the top face pointing forward.

20. Make a note of the key number on these instructions to refer to should the keys be mislaid.

Key Number:

21. Place the keys and the fitting instructions in the glove box of the vehicle.