

Front Fender Mud and Rear Mud Flap Package Installation

Installation Instructions Part Number

95929544

[Front Mud Flap Procedure](#)

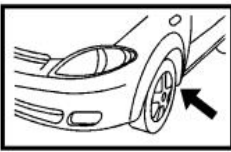

Accessory Part No.
96888776
96888785

17.8mm
2X

36mm
4X

2X

Ø8.5 (8.5mm)

SERVICE

1

2



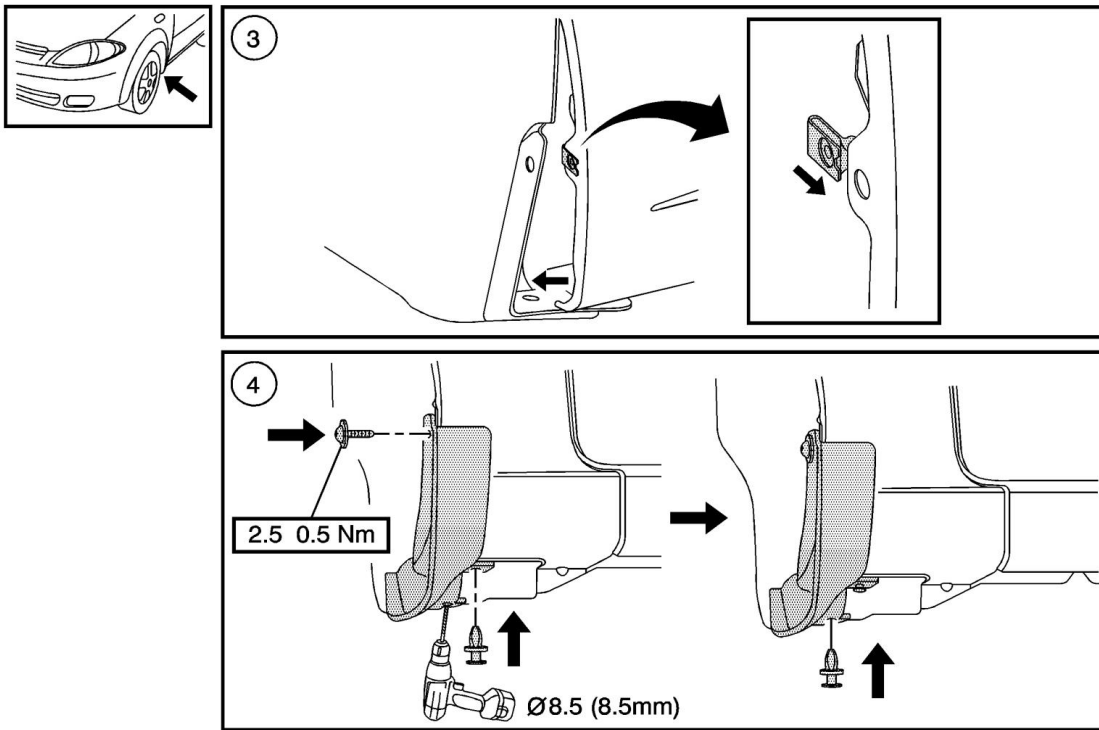

[Rear Mud Flap Procedure](#)

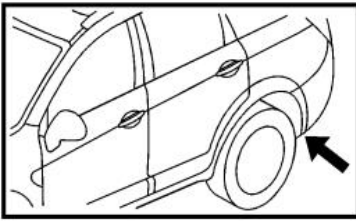

Accessory Part No
96888779
96888785

2X
22.5mm
2X
41mm
2X
2X

Ø 7.6 & 8.5
(7.6 & 8.5mm)

SERVICE

1

2



